



King County
Department of Permitting
and Environmental Review

Residential Site Plan Template

Ref: KCC 21a.12.030

Max Impervious Surface Allowed 151045 SF

Max. Bldg. Height Allowed 40'

Ref: KCC 21a.12.170

Min. Bldg. setback from Street 30'

Min. Garage setback from Street 30'

Min. Bldg. setback from Interior 5'

Permit Center Validations:

- Zoning
- Site Review Not Applicable

Validated Signature [Signature]

Login Initials [Initials] Date 8/6/19

Engineering / Drainage Approval

Signature _____

Date _____

Critical Areas Approval

Signature _____

Date _____

Clearing / Grading Approval

Signature _____

Date _____

Fire Approval

Signature _____

Date _____

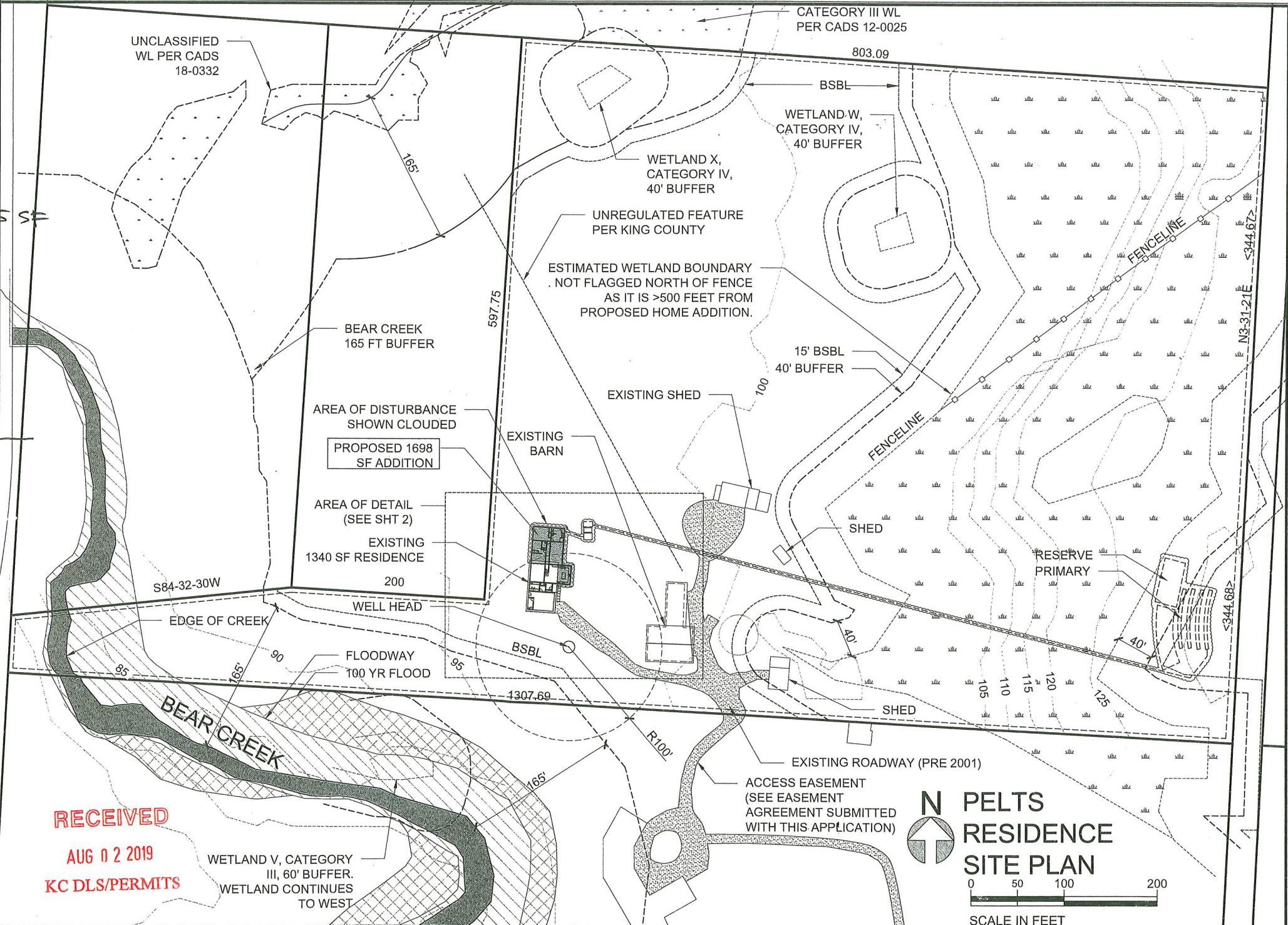

RECEIVED
AUG 02 2019
KC DLS/PERMITS

N PELTS RESIDENCE SITE PLAN

0 50 100 200
SCALE IN FEET

Permit Number: ADDU-0716

Parcel Number: 7273100227

Applicant Name: GAYLEN PELTS

Site Address: 19126 NE 116TH ST

Engineering Scale: 1" = 100'

Sheet 1 of 3