

**PLAN LEGEND**

- PROPERTY LINE
- ..... OHWL OF STREAM
- [---] WETLAND
- STEEP SLOPES

ALL REMAINING SITE IS LANDSLIDE HAZARD AREA, THEREFORE THE ENTIRE PARCEL IS ENCUMBERED BY CRITICAL AREA BUFFER PER PREA22-0029 CRITICAL AREA COMMENTS.

**GRAPHIC SCALE**  
(IN FEET)

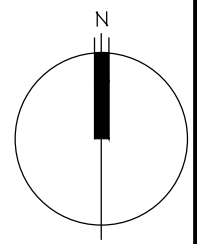
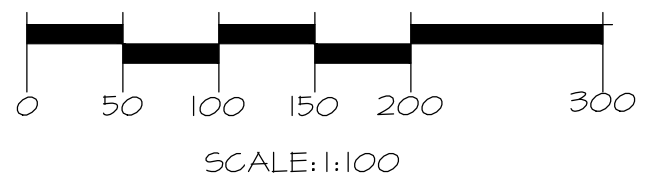

**NOTES**

1. BASE INFORMATION PROVIDED BY REGENERATION DESIGN, LLC, (206) 390-0287.
2. WETLAND AND STREAM WERE DELINEATED BY THE WATERSHED COMPANY.

PROJECT	6806
DRAWN	SO
SCALE	AS NOTED
DATE	12-9-22
REVISION	1/10

FIGURE 1: EXISTING CONDITIONS OVERVIEW  
WEGNER PROPERTY  
KING COUNTY, WASHINGTON  
PARCEL 2524069066 - PREA22-0029

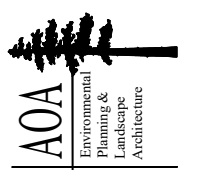

**Almann Oliver Associates, LLC**  
Environmental Planning & Landscape Architecture  
PO Box 578 Corvallis, WA 97331  
Office (425) 333-4338 Fax (425) 333-4399

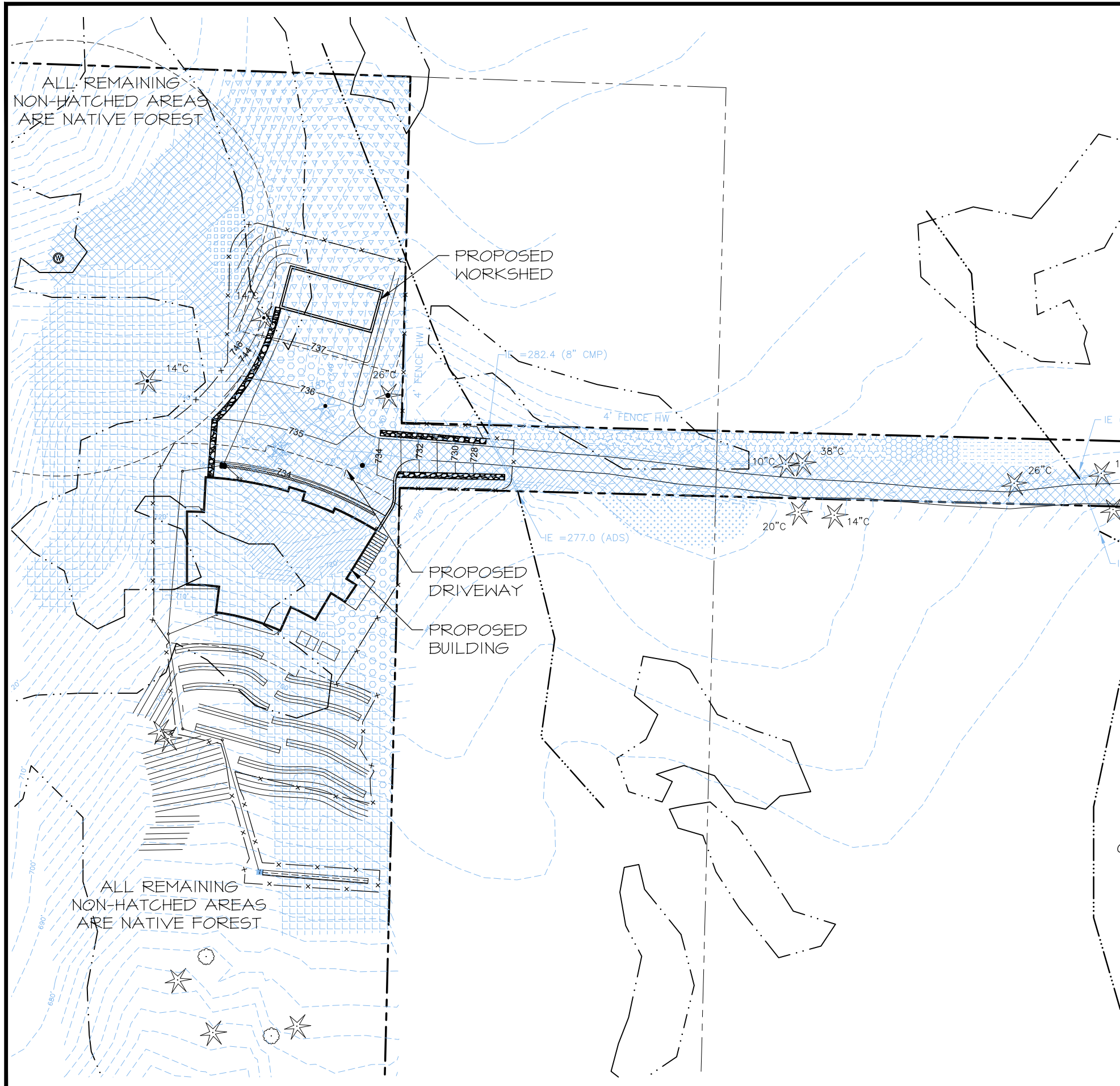

**PLAN LEGEND**

- — — — — PROPERTY LINE
- - - - - OHWL OF STREAM
- ▭ WETLAND
- - - - - STEEP SLOPES
- x x x x x CLEARING LIMITS

ALL REMAINING SITE IS LANDSLIDE HAZARD AREA, THEREFORE THE ENTIRE PARCEL IS ENCUMBERED BY CRITICAL AREA BUFFER PER PREA22-0029 CRITICAL AREA COMMENTS.

**EXISTING VEGETATION LEGEND**

	25% SWORD FERN / SALMONBERRY, ~25% RED ALDER	9,015 SF
	100% NATIVE	4,104 SF
	~10% NATIVE SHRUBS / TREES, THE REST IS INVASIVES / HERBACEOUS	21,863 SF
	100% HIMALAYAN BLACKBERRY	1,882 SF
	STUMP PILE	621 SF
	GRAVEL WITH HERB ROBERT IN DRIVEWAY	14,742 SF
	100% BIG LEAF MAPLE / SALMONBERRY	1,978 SF
	OPEN / GRAVEL	395 SF
	100% DOUGLAS FIR / WESTERN RED CEDAR / SWORD FERN	543 SF
	PULLOUT / COMPACTED DIRT / SOFT RUSH	1,307 SF

**GRAPHIC SCALE**  
(IN FEET)

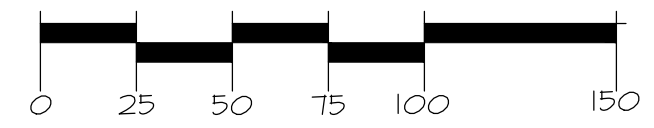

SCALE: 1:50

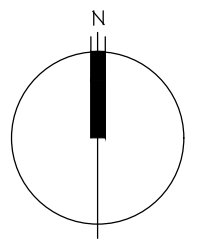

**NOTES**

1. BASE INFORMATION PROVIDED BY REGENERATION DESIGN, LLC, (206) 390-0287.
2. WETLAND AND STREAM WERE DELINEATED BY THE WATERSHED COMPANY.

PROJECT	6806
DRAWN	SO
SCALE	AS NOTED
DATE	12-9-22
REVISION	2/10

FIGURE 2: EXISTING VEGETATION MAP  
WEGNER PROPERTY  
KING COUNTY, WASHINGTON  
PARCEL 2524069066 - PREA22-0029

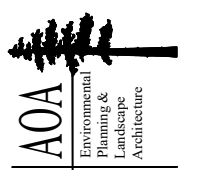

Altmann Oliver Associates, LLC  
Environmental Planning & Landscape Architecture  
PO Box 578 Carleton, WA 98014  
Office (425) 333-4338 Fax (425) 333-4399



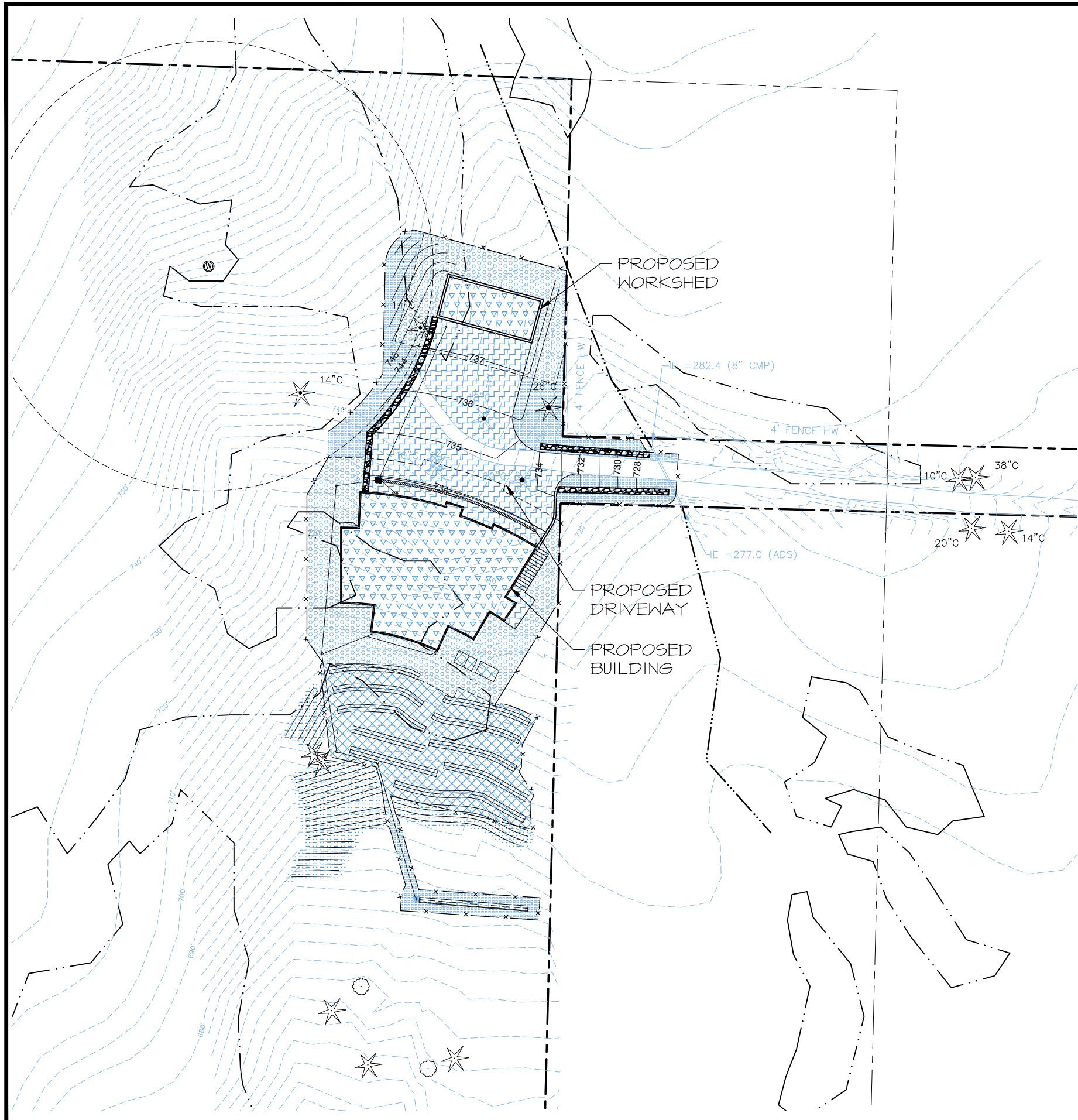

### PLAN LEGEND

- PROPERTY LINE
- OHWL OF STREAM
- WETLAND
- STEEP SLOPES
- CLEARING LIMITS

ALL REMAINING SITE IS LANDSLIDE HAZARD AREA, THEREFORE THE ENTIRE PARCEL IS ENCUMBERED BY CRITICAL AREA BUFFER PER PREA22-0029 CRITICAL AREA COMMENTS.

### BUFFER IMPACT LEGEND

	NEW STRUCTURE	5,053 SF
	NEW IMPERVIOUS IMPACT	5,491 SF
	IMPACT FOR SEPTIC AND PRIMARY DRAINFIELD	4,675 SF
	IMPACT FOR RESERVE DRAINFIELD	2,633 SF
	BSBL TO BE LANDSCAPED	5,819 SF
<b>TOTAL NEW BUFFER IMPACT</b>		<b>23,671 SF</b>
	TEMPORARY IMPACT TO BE RESTORED WITH NATIVE TREES AND SHRUBS	3,327 SF

### GRAPHIC SCALE (IN FEET)

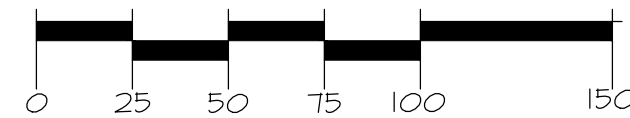

SCALE: 1:50

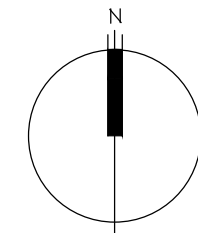

### NOTES

1. BASE INFORMATION PROVIDED BY REGENERATION DESIGN, LLC, (206) 390-0287.
2. WETLAND AND STREAM WERE DELINEATED BY THE WATERSHED COMPANY.

PROJECT	6806
DRAWN	SO
SCALE	AS NOTED
DATE	12-9-22
REVISIONS	3/10

FIGURE 3: SITE PLAN IMPACTS  
WEGNER PROPERTY  
KING COUNTY, WASHINGTON  
PARCEL 2524069066 - PREA22-0029

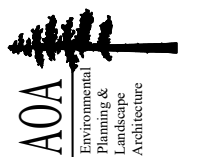

**Almann Oliver Associates, LLC**  
Environmental  
Planning &  
Landscape  
Architecture  
PO Box 578 - Camanion, WA 98014  
Office (425) 333-4338 Fax (425) 333-4399

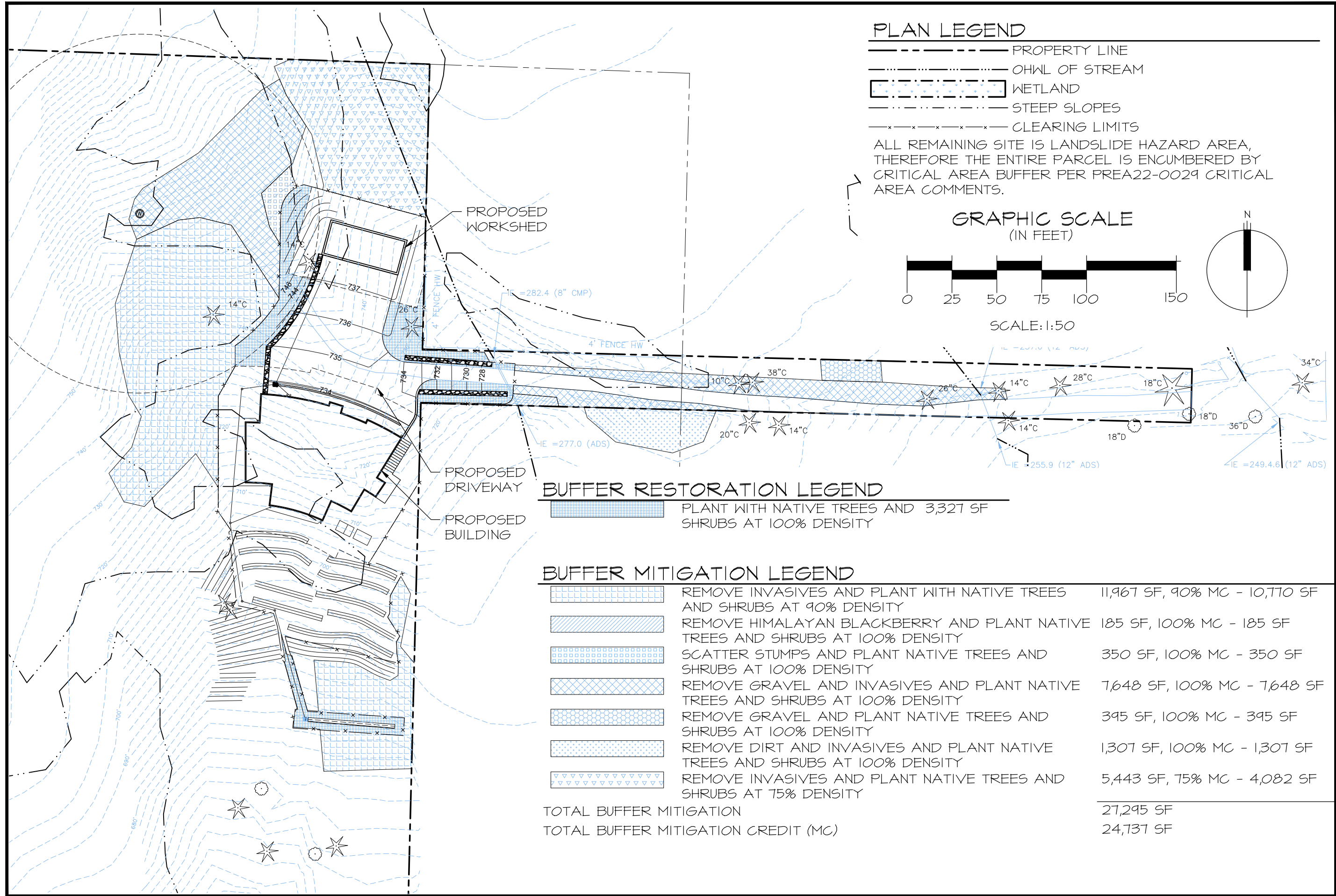

PROJECT 6806  
 DRAWN SO  
 SCALE AS NOTED  
 DATE 12-9-22  
 REVISED 4/10

FIGURE 4: MITIGATION PLAN  
 WEGNER PROPERTY  
 KING COUNTY, WASHINGTON  
 PARCEL 2524069066 - PREA22-0029

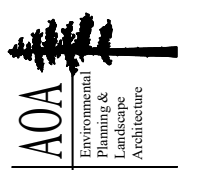

Altmann Oliver Associates, LLC  
 Environmental Planning & Landscape Architecture  
 PO Box 578 Corvallis, WA 97331  
 Office (425) 333-4338 Fax (425) 333-4399



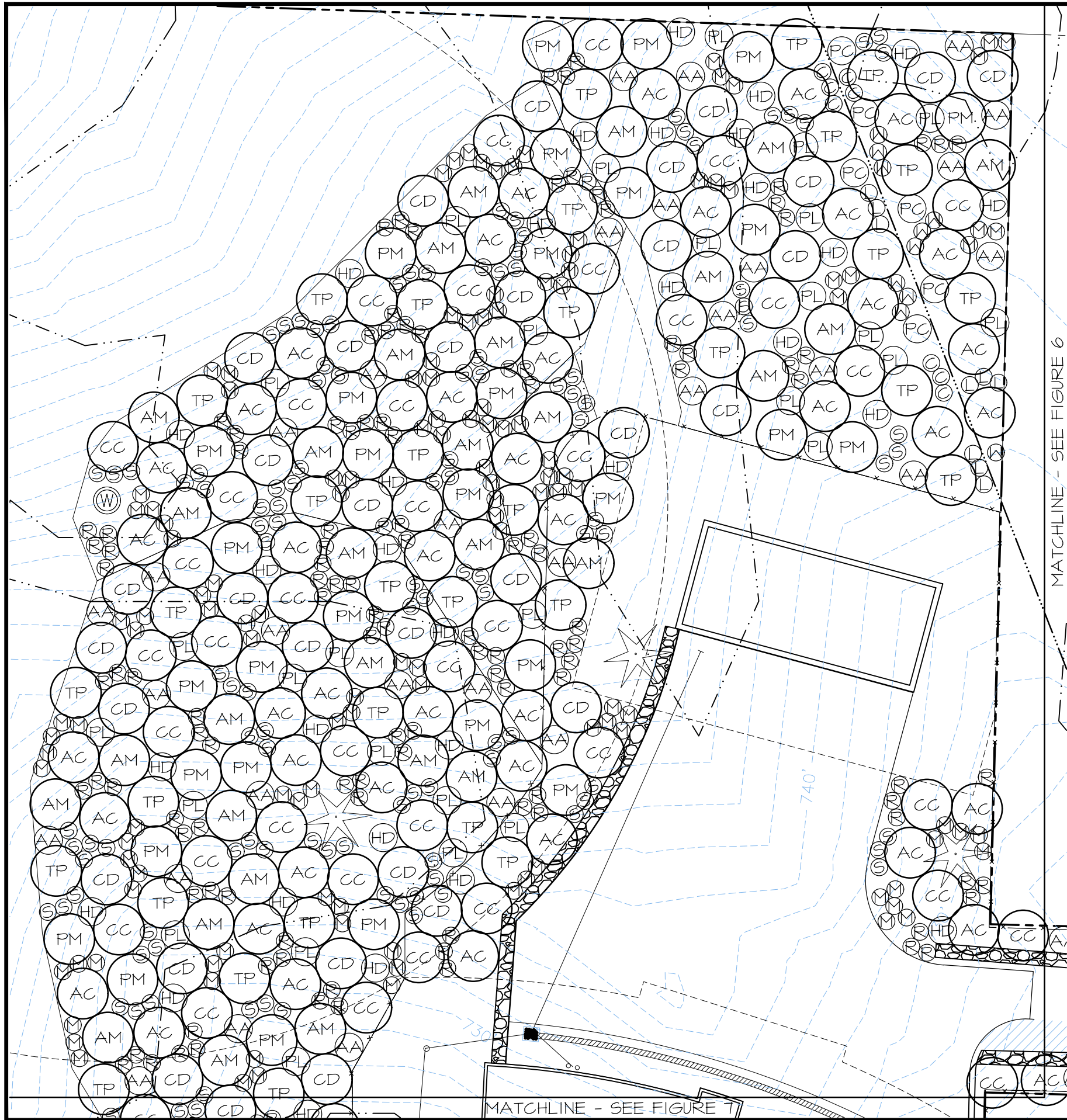

**PLANT LIST (SEE FIGURE 8 FOR SCHEDULE)**

**TREES**

KEY	SCIENTIFIC NAME	COMMON NAME
AC	ACER CIRCINATUM	VINE MAPLE
AM	ACER MACROPHYLLUM	BIG LEAF MAPLE
CD	CALOCEDRUS DECURRENS	INCENSE CEDAR
CC	CORYLUS CORNUTA	WESTERN HAZELNUT
PM	PSEUDOTSUGA MENZIESII	DOUGLAS FIR
TP	THUJA PLICATA	WESTERN RED CEDAR

**SHRUBS**

KEY	SCIENTIFIC NAME	COMMON NAME
AA	AMELANCHIER ALNIFOLIA	SERVICEBERRY
C	CORNUS SERICEA	RED-OSIER DOGWOOD
HD	HOLODISCUS DISCOLOR	OCEAN SPRAY
L	LONICERA INVOLUCRATA	BLACK TWIN-BERRY
M	MAHONIA AQUIFOLIUM	TALL OREGON GRAPE
PL	PHILADELPHUS LEWISII	MOCK ORANGE
PC	PHYSOCARPUS CAPITATUS	PACIFIC NINEBARK
R	ROSA NUTKANA	NOOTKA ROSE
N	SALIX SCOULERIANA	SCOULER WILLOW
S	SYMPHORICARPOS ALBUS	SNOWBERRY

**GROUNDCOVER**

KEY	SCIENTIFIC NAME	COMMON NAME
	GAULTHERIA SHALLON	SALAL

**GRAPHIC SCALE (IN FEET)**

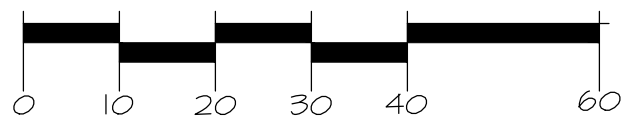

SCALE: 1:20

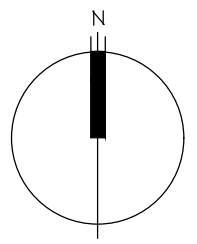

**NOTES**

1. BASE INFORMATION PROVIDED BY REGENERATION DESIGN, LLC, (206) 390-0287.
2. WETLAND AND STREAM WERE DELINEATED BY THE WATERSHED COMPANY.

MATCHLINE - SEE FIGURE 6

MATCHLINE - SEE FIGURE 7

PROJECT 6806  
 DRAWN SO  
 SCALE AS NOTED  
 DATE 12-9-22  
 REVISED 5/10

FIGURE 5: PLANTING PLAN  
 WEGNER PROPERTY  
 KING COUNTY, WASHINGTON  
 PARCEL 2524069066 - PREA22-0029

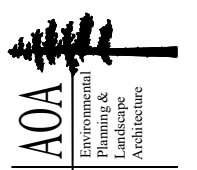

Almann Oliver Associates, LLC  
 Environmental Planning & Landscape Architecture  
 PO Box 578 Carleton, WA 98014  
 Office (425) 333-4338 Fax (425) 333-4399

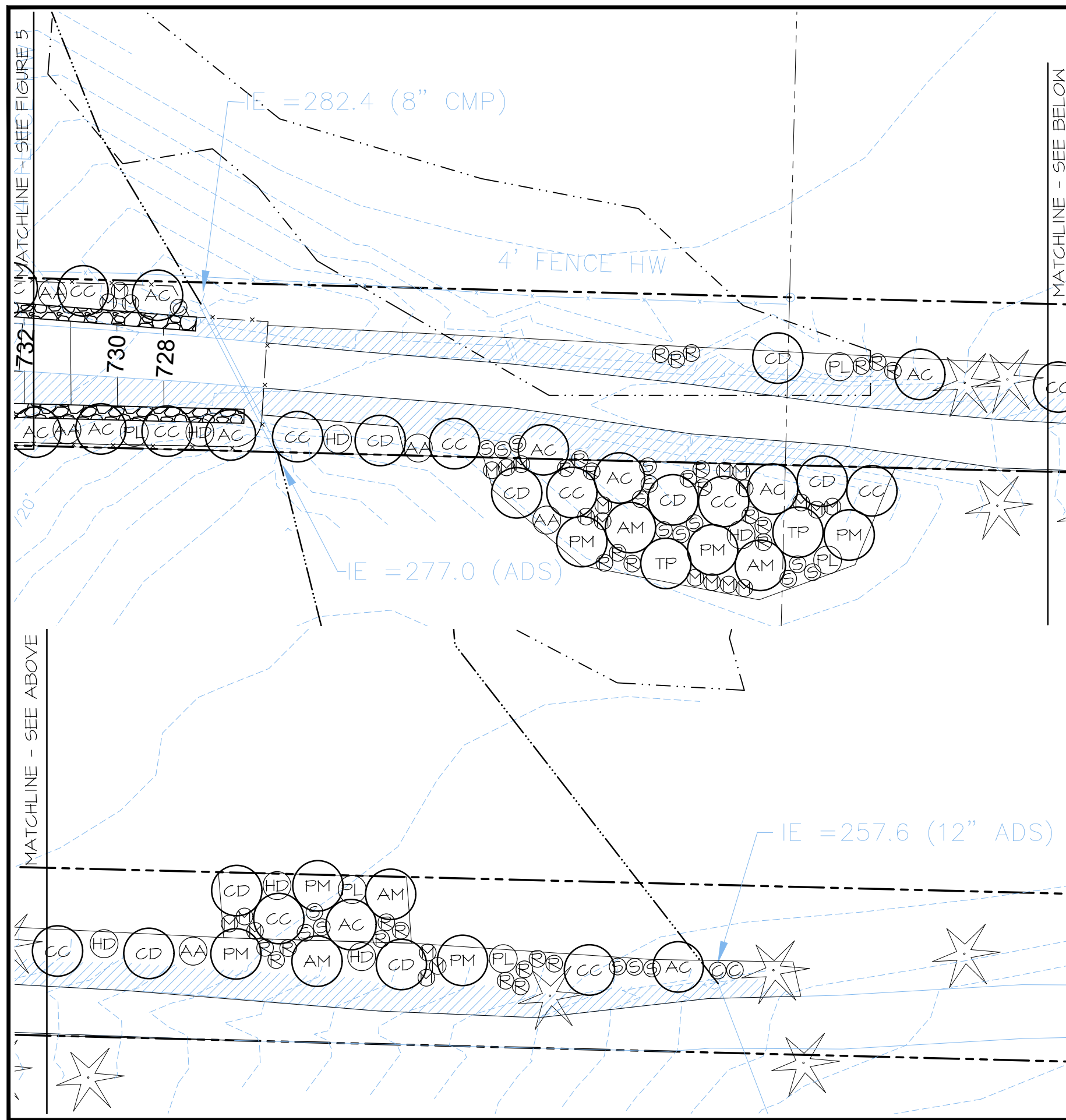

**PLANT LIST** (SEE FIGURE 8 FOR SCHEDULE)

**TREES**

KEY	SCIENTIFIC NAME	COMMON NAME
AC	ACER CIRCINATUM	VINE MAPLE
AM	ACER MACROPHYLLUM	BIG LEAF MAPLE
CD	CALOCEDRUS DECURRENS	INCENSE CEDAR
CC	CORYLUS CORNUTA	WESTERN HAZELNUT
PM	PSEUDOTSUGA MENZIESII	DOUGLAS FIR
TP	THUJA PLICATA	WESTERN RED CEDAR

**SHRUBS**

KEY	SCIENTIFIC NAME	COMMON NAME
AA	AMELANCHIER ALNIFOLIA	SERVICEBERRY
C	CORNUS SERICEA	RED-OSIER DOGWOOD
HD	HOLODISCUS DISCOLOR	OCEAN SPRAY
L	LONICERA INVOLUCRATA	BLACK TWIN-BERRY
M	MAHONIA AQUIFOLIUM	TALL OREGON GRAPE
PL	PHILADELPHUS LEWISII	MOCK ORANGE
PC	PHYSOCARPUS CAPITATUS	PACIFIC NINEBARK
R	ROSA NUTKANA	NOOTKA ROSE
W	SALIX SCOULERIANA	SCOULER WILLOW
S	SYMPHORICARPOS ALBUS	SNOWBERRY

**GROUND COVER**

KEY	SCIENTIFIC NAME	COMMON NAME
	GAULTHERIA SHALLON	SALAL

**GRAPHIC SCALE**  
(IN FEET)

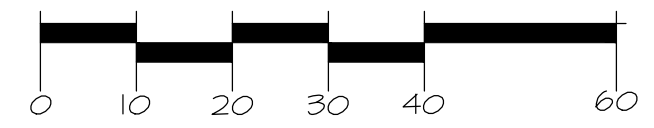

SCALE: 1:20

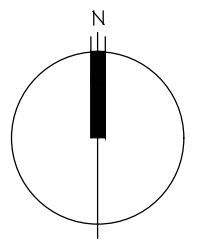

**NOTES**

1. BASE INFORMATION PROVIDED BY REGENERATION DESIGN, LLC, (206) 390-0287.
2. WETLAND AND STREAM WERE DELINEATED BY THE WATERSHED COMPANY.

PROJECT	6806
DRAWN	SO
SCALE	AS NOTED
DATE	12-9-22
REVISION	6/10

FIGURE 6: PLANTING PLAN  
WEGNER PROPERTY  
KING COUNTY, WASHINGTON  
PARCEL 2524069066 - PREA22-0029

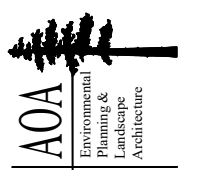

**Almann Oliver Associates, LLC**  
Environmental Planning & Landscape Architecture  
PO Box 578 - Camanion, WA 98014  
Office (425) 333-4338 Fax (425) 333-4399



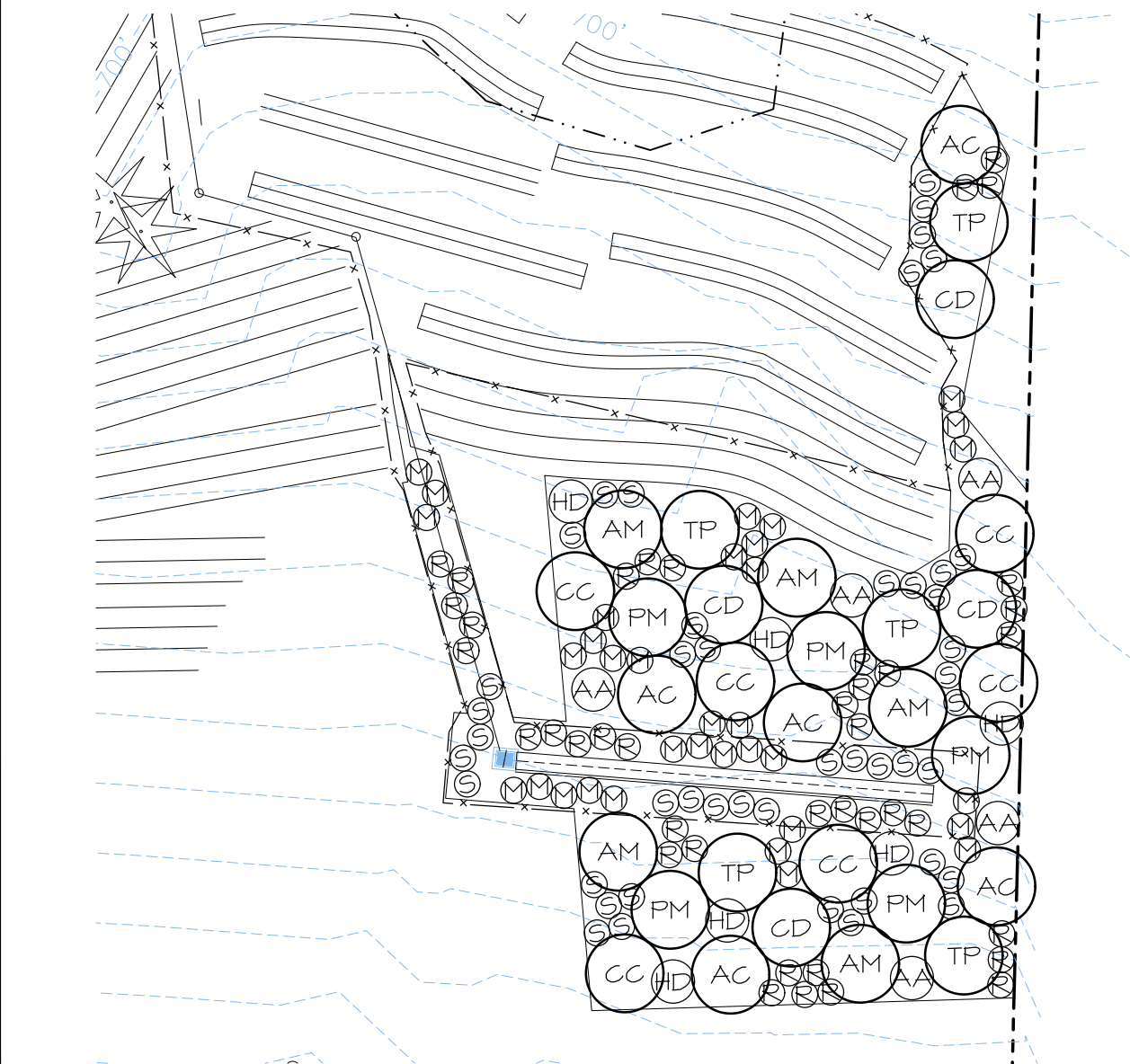

**PLANT LIST (SEE FIGURE 8 FOR SCHEDULE)**

**TREES**

KEY	SCIENTIFIC NAME	COMMON NAME
AC	ACER CIRCINATUM	VINE MAPLE
AM	ACER MACROPHYLLUM	BIG LEAF MAPLE
CD	CALOCEDRUS DECURRENS	INCENSE CEDAR
CC	CORYLUS CORNUTA	WESTERN HAZELNUT
PM	PSEUDOTSUGA MENZIESII	DOUGLAS FIR
TP	THUJA PLICATA	WESTERN RED CEDAR

**SHRUBS**

KEY	SCIENTIFIC NAME	COMMON NAME
AA	AMELANCHIER ALNIFOLIA	SERVICEBERRY
C	CORNUS SERICEA	RED-OSIER DOGWOOD
HD	HOLODISCUS DISCOLOR	OCEAN SPRAY
L	LONICERA INVOLUCRATA	BLACK TWIN-BERRY
M	MAHONIA AQUIFOLIUM	TALL OREGON GRAPE
PL	PHILADELPHUS LEWISII	MOCK ORANGE
PC	PHYSOCARPUS CAPITATUS	PACIFIC NINEBARK
R	ROSA NUTKANA	NOOTKA ROSE
W	SALIX SCOULERIANA	SCOULER WILLOW
S	SYMPHORICARPOS ALBUS	SNOWBERRY

**GROUND COVER**

KEY	SCIENTIFIC NAME	COMMON NAME
	GAULTHERIA SHALLON	SALAL

**GRAPHIC SCALE (IN FEET)**

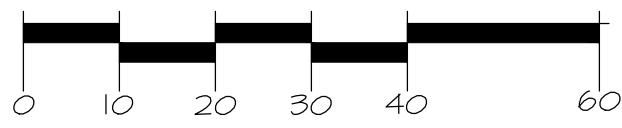

SCALE: 1:20

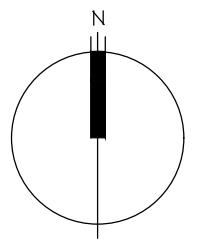

**NOTES**

1. BASE INFORMATION PROVIDED BY REGENERATION DESIGN, LLC, (206) 390-0287.
2. WETLAND AND STREAM WERE DELINEATED BY THE WATERSHED COMPANY.

PROJECT: 6806  
 DRAWN: SO  
 SCALE: AS NOTED  
 DATE: 12-9-22  
 REVISIONS: 7/10

FIGURE 7: PLANTING PLAN  
 WEGNER PROPERTY  
 KING COUNTY, WASHINGTON  
 PARCEL 2524069066 - PREA22-0029

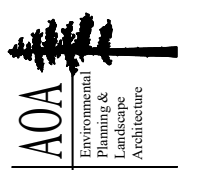

Altmann Oliver Associates, LLC  
 Environmental Planning & Landscape Architecture  
 PO Box 578 - Camanion, WA 98014  
 Office (425) 333-4338 Fax (425) 333-4399

# PLANT SCHEDULE

## TREES

KEY	SCIENTIFIC NAME	COMMON NAME	DENSITY	QTY.	SIZE (MIN.)	NOTES
AC	ACER CIRCINATUM	VINE MAPLE	9' O.C.	62	2 GAL.	MULTI-STEM (3 MIN.)
AM	ACER MACROPHYLLUM	BIG LEAF MAPLE	9' O.C.	41	2 GAL.	SINGLE TRUNK, WELL BRANCHED
CD	CALOCEDRUS DECURRENS	INCENSE CEDAR	9' O.C.	48	2 GAL.	FULL & BUSHY
CC	CORYLUS CORNUTA	WESTERN HAZELNUT	9' O.C.	58	2 GAL.	MULTI-STEM (3 MIN.)
PM	PSEUDOTSUGA MENZIESII	DOUGLAS FIR	9' O.C.	46	2 GAL.	FULL & BUSHY
TP	THUJA PLICATA	WESTERN RED CEDAR	9' O.C.	43	2 GAL.	FULL & BUSHY

## SHRUBS

KEY	SCIENTIFIC NAME	COMMON NAME	DENSITY	QTY.	SIZE (MIN.)	NOTES
AA	AMELANCHIER ALNIFOLIA	SERVICEBERRY	6' O.C.	43	1 GAL.	MULTI-STEM (3 MIN.)
C	CORNUS SERICEA	RED-OSIER DOGWOOD	6' O.C.	11	1 GAL.	MULTI-STEM (3 MIN.)
HD	HOLODISCUS DISCOLOR	OCEAN SPRAY	6' O.C.	46	1 GAL.	MULTI-STEM (3 MIN.)
L	LONICERA INVOLUCRATA	BLACK TWIN-BERRY	6' O.C.	9	1 GAL.	MULTI-STEM (3 MIN.)
M	MAHONIA AQUIFOLIUM	TALL OREGON GRAPE	6' O.C.	204	1 GAL.	FULL & BUSHY
PL	PHILADELPHUS LEWISII	MOCK ORANGE	6' O.C.	37	1 GAL.	MULTI-STEM (3 MIN.)
PC	PHYSOCARPUS CAPITATUS	PACIFIC NINEBARK	6' O.C.	6	1 GAL.	MULTI-STEM (3 MIN.)
R	ROSA NUTKANA	NOOTKA ROSE	6' O.C.	204	1 GAL.	MULTI-STEM (3 MIN.)
W	SALIX SCOULERIANA	SCOULER WILLOW	6' O.C.	*30	4' CUTTING	1/2" DIA. MIN., BARK INTACT
S	SYMPHORICARPOS ALBUS	SNOWBERRY	6' O.C.	196	1 GAL.	MULTI-STEM (3 MIN.)

\*3 CUTTINGS PER SYMBOL

## GROUND COVER

KEY	SCIENTIFIC NAME	COMMON NAME	SPACING	QTY.	SIZE (MIN.)	NOTES
	GAULTHERIA SHALLON	SALAL	2' O.C.	591	1 GAL.	FULL & BUSHY

PROJECT	6806
DRAWN	SO
SCALE	AS NOTED
DATE	12-9-22
REVISIONS	8/10

FIGURE 8: PLANT SCHEDULE  
 WEGNER PROPERTY  
 KING COUNTY, WASHINGTON  
 PARCEL 2524069066 - PREA22-0029



**Altmann Oliver Associates, LLC**  
 Environmental  
 Planning &  
 Landscape  
 Architecture  
 PO Box 578 Carleton, WA 98014  
 Office (425) 333-4338 Fax (425) 333-4399



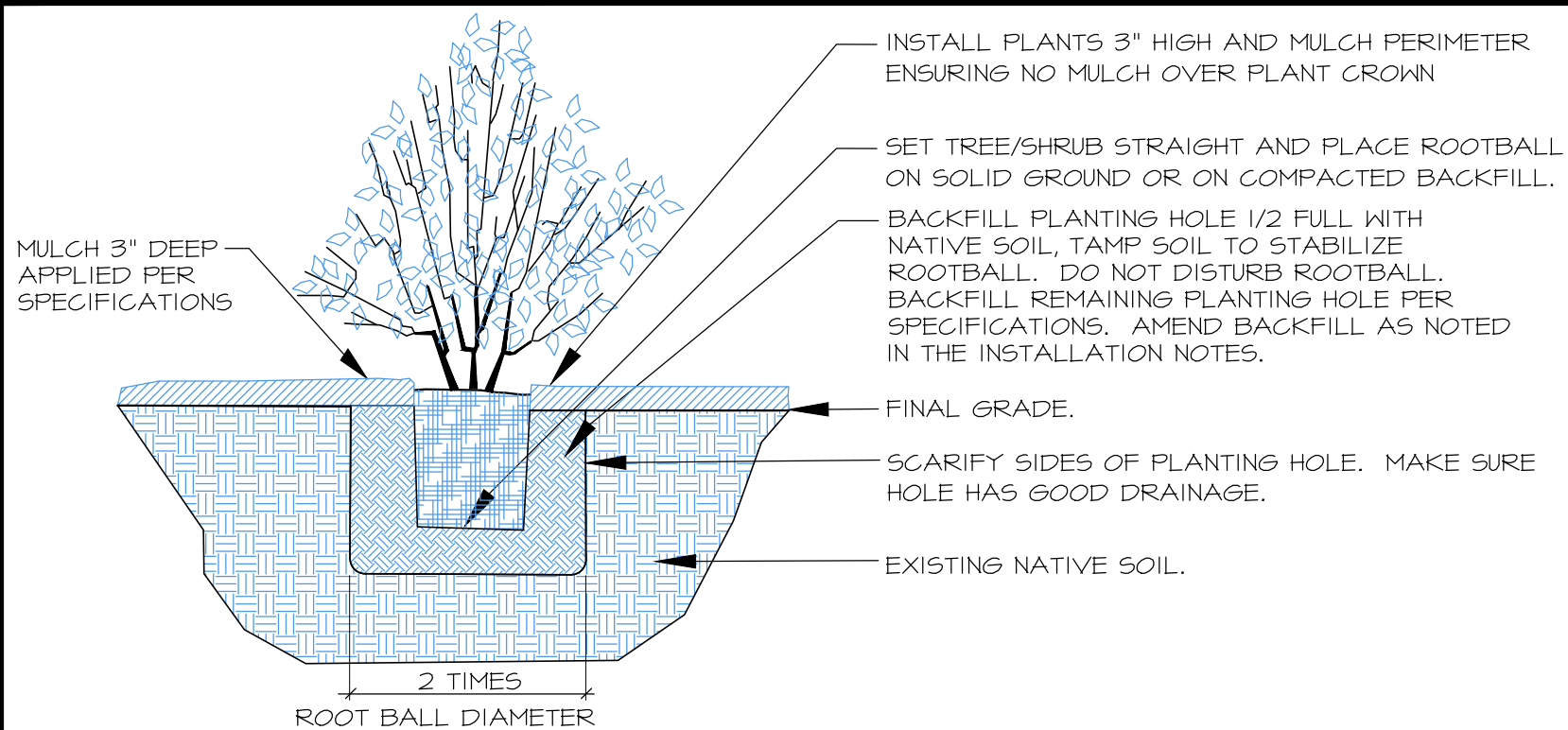

**1 CONTAINER PLANTING DETAIL (TYP.)**  
SCALE: NTS

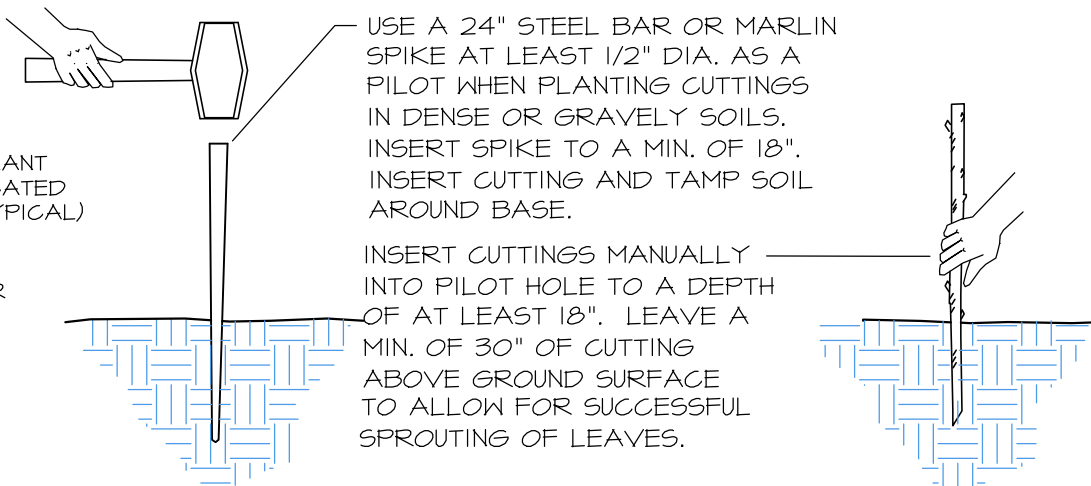
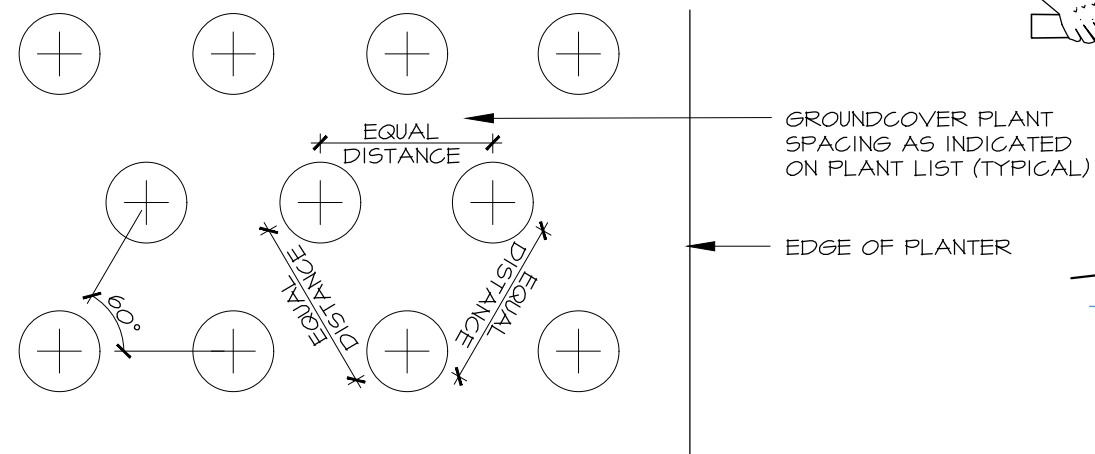
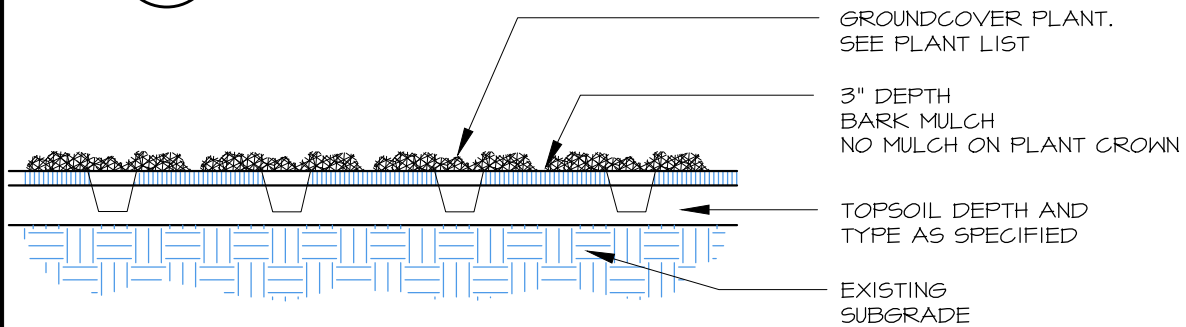

NOTES:

1. CUTTINGS SHALL BE SPECIES AS NOTED IN THE PLANT SCHEDULE.
2. CUTTINGS SHALL BE AT LEAST 1/2" DIA. AND 4' (min.) IN LENGTH.
3. CUTTINGS MUST BE ALIVE WITH SIDE BRANCHES CLEARLY REMOVED AND BARK INTACT. CUTTINGS SHALL BE PLANTED WITHIN 24 HOURS OF CUTTING.
4. THE BUTT ENDS SHOULD BE CLEANLY CUT AT AN ANGLE FOR EASY INSERTION INTO THE SOIL. THE TOP SHOULD BE CUT SQUARE OR BLUNT.
5. CUTTINGS MUST BE FRESH AND KEPT MOIST AFTER CUTTING. THEY SHOULD BE PRUNED AND INSTALLED THE SAME DAY.
6. DIP BOTTOM OF CUTTING IN A PLANT ROOTING HORMONE PRIOR TO INSERTION INTO THE SOIL.

**2 GROUNDCOVER PLANTING**  
SCALE: NTS

**3 CUTTING INSTALLATION**  
SCALE: NTS

**MONITORING & MAINTENANCE PLAN**

PERFORMANCE STANDARDS FOR MONITORING INCLUDE:

1) YEAR 1 - THERE WILL BE 100% SURVIVAL OF ALL PLANTED SPECIES. FOLLOWING YEARS 2-3 THERE WILL BE AN 80% SURVIVAL RATE OF ALL PLANTED SPECIES OR EQUIVALENT REPLACEMENT OF A COMBINATION OF PLANTED AND RE-COLONIZED NATIVE WOODY SPECIES.

2) FOLLOWING THE FIRST YEAR AFTER PLANTING, A COMBINATION OF NATIVE OR NATURALIZED WOODY VEGETATION WILL COVER AT LEAST 15% OF THE MITIGATION AREA. THE AREAL COVERAGE WILL INCREASE TO AT LEAST 20% FOLLOWING THE SECOND YEAR AND 30% FOLLOWING THE THIRD YEAR AFTER PLANTING.

3) AFTER CONSTRUCTION AND FOLLOWING EVERY MONITORING EVENT FOR A PERIOD OF AT LEAST THREE YEARS, EXOTIC AND INVASIVE PLANT SPECIES WILL BE MAINTAINED AT LEVELS BELOW 10% TOTAL COVERAGE IN ALL PLANTED AREAS. THESE SPECIES INCLUDE, BUT ARE NOT LIMITED TO: HIMALAYAN AND EVERGREEN BLACKBERRY, REED CANARYGRASS, MORNING GLORY, JAPANESE KNOTWEED, ENGLISH IVY, THISTLE, PERIWINKLE, CREEPING NIGHTSHADE, LAUREL, POISON HEMLOCK, TREFOIL, AND STINKY BOB.

ANNUAL MONITORING REPORTS WILL BE PREPARED AND SUBMITTED TO KING COUNTY EACH OF THE THREE YEARS OF THE 3-YEAR MONITORING PERIOD BY OCTOBER 31ST. THE REPORTS WILL DETAIL IF THE SITE IS MEETING THE PERFORMANCE STANDARDS AND PROVIDE PHOTOS FROM ESTABLISHED PHOTO POINTS.

PROJECT	6806
DRAWN	SO
SCALE	AS NOTED
DATE	12-9-22
REVISED	9/10

FIGURE 9: PLANTING DETAILS, MONITORING & MAINTENANCE  
WEGNER PROPERTY  
KING COUNTY, WASHINGTON  
PARCEL 2524069066 - PREA22-0029



Almann Oliver Associates, LLC  
Environmental Planning & Landscape Architecture  
PO Box 578  
Carnation, WA 98014  
Office (425) 333-4338 Fax (425) 333-4399

# SPECIFICATIONS

1. PRIOR TO PLANTING, ALL NON-ORGANIC DEBRIS AND INVASIVE PLANT SPECIES SHALL BE REMOVED FROM THE ENHANCEMENT AREAS. IMPORTED 3-WAY TOPSOIL SHALL BE PLACED TO PRE-CLEARING GRADES.
2. PRIOR TO THE INITIATION OF ANY SITE WORK, THE DISTURBED AREA LIMITS SHALL BE SURVEYED AND FLAGGED IN A HIGHLY VISIBLE MANNER. FLAGGING SHALL REMAIN IN PLACE UNTIL CONSTRUCTION IS COMPLETED. THESE FIELD MARKERS WILL BE INSPECTED AND FIELD VERIFIED BY A KC PERMITTING SITE INSPECTOR OR ENVIRONMENTAL SCIENTIST. A SILT FENCE SHALL ALSO BE INSTALLED ALONG THE EDGE OF THE SITE CLEARING WHERE IT IS WITHIN THE CRITICAL AREA TO ASSURE THAT NO SEDIMENT OR SEDIMENT-LADEN WATER ENTERS THE CRITICAL AREA.
3. ALL EXTERIOR LIGHTING SHALL BE DOWNCAST WITH METAL HOODS. EXTERIOR LIGHTING ON THE BACK OF THE HOME SHALL BE ON A 15-MINUTE TIMER. ONLY LOW-WATTAGE DIRECTIONAL LIGHTING WITH NARROW ANGLES OF ILLUMINATION SHALL BE USED. AOA TO REVIEW LIGHTING BEFORE AND AFTER PLACEMENT AND LIGHTS SHALL BE REFLECTED ON THE AS-BUILT PLAN.
4. PRIOR TO ANY SITE DISTURBANCE, TREES TO BE RETAINED ADJACENT TO THE CLEARING LIMITS SHALL BE CLEARLY MARKED WITH HIGHLY VISIBLE CONSTRUCTION FENCING THAT INCLUDES A TREE PROTECTION ZONE AROUND EACH RETAINED TREE. INSTALL ALL RECOMMENDED TREE PROTECTION MEASURES OUTLINED IN THE ARBORIST REPORT SUBMITTED WITH THE BUILDING PERMIT.
5. PRIOR TO SITE DISTURBANCE, AFTER CLEARING LIMITS AND TREE PROTECTION ZONES HAVE BEEN MARKED, A PRE-CONSTRUCTION CONFERENCE (INSPECTION) SHALL BE SCHEDULED WITH KING COUNTY, THE CONTRACTOR AND AOA.
6. TREES REMOVED FROM WITHIN THE CLEARING LIMITS SHALL BE STATICALLY PLACED AS LARGE WOODY DEBRIS WITHIN THE BUFFER IN AREAS DEVOID OF WOODY DEBRIS. AOA TO DESIGNATE FINAL LOCATIONS AND REFLECT THEM ON THE AS-BUILT PLAN.
7. IF ANY EMPLOYEE, CONTRACTOR, SUBCONTRACTOR, ETC. BELIEVES A CULTURAL RESOURCE AND/OR HUMAN REMAINS HAVE BEEN UNCOVERED AT ANY POINT IN THE PROJECT, ALL WORK IN THE AREA MUST STOP AND LOCATION SECURED (RCW 27.44). THE APPROPRIATE AGENCIES AND AUTHORITIES (I.E. ARCHAEOLOGICAL CONSULTANT, WA STATE DEPT. OF ARCHEOLOGY AND HISTORIC PRESERVATION, KC MEDICAL EXAMINER, KC SHERIFF) MUST BE CONSULTED. WORK MAY NOT RESUME UNTIL ALL AGENCIES INVOLVED HAVE REVIEWED, MADE FINAL DETERMINATIONS, DOCUMENTATION, ETC.
8. IT IS A CONDITION OF THE BUILDING PERMIT THAT NO HERBICIDES OR PESTICIDES BE USED ON THIS SITE IN PERPETUITY.
9. PRIOR TO PLANTING, ALL NON-ORGANIC DEBRIS AND INVASIVE PLANT SPECIES OUTSIDE THE SITE DISTURBANCE AREAS SHALL BE REMOVED FROM THE PLANTING AREAS. IMPORTED CEDAR GROVE COMPOST SHALL BE PLACED TO PRE-CLEARING GRADES (3" MIN.).
10. WITHIN THE CLEARING LIMITS AND WITHIN AREAS OF CLEARING OR IMPERVIOUS SURFACE, ALL IMPERVIOUS MATERIALS (GRAVEL, CONCRETE, ASPHALT, ETC.) SHALL BE REMOVED. THE AREAS SHALL BE OVER-EXCAVATED 12" AND DECONSOLIDATED TO A DEPTH OF 12 INCHES. ONE 6" LIFT OF CEDAR GROVE 3-WAY TOPSOIL SHALL BE PLACED OVER SUBGRADE AND TILLED TO A DEPTH OF 12" PRIOR TO A SECOND LIFT.
11. ALL PLANTS SHOULD BE INSTALLED BETWEEN DECEMBER 1ST AND MARCH 15TH.
12. ALL PLANTS SHALL BE PIT-PLANTED IN PLANTING PITS EXCAVATED 2X THE DIAMETER OF THE PLANT. PLANTS SHALL BE INSTALLED 3" HIGH AND SURFACED MULCHED TO A DEPTH OF 3" WITH MEDIUM-COURSE BARK MULCH OR WOOD CHIPS PLACED CONTINUOUSLY THROUGHOUT PLANTING BEDS.
13. ALL PLANTS SHALL BE NURSERY GROWN (IN W. WA OR OR.) FOR AT LEAST 1 YEAR FROM PURCHASE DATE, FREE FROM DISEASE OR PESTS, WELL-ROOTED, BUT NOT ROOT-BOUND AND TRUE TO SPECIES.
14. PLANT LAYOUT SHALL BE APPROVED BY AOA PRIOR TO INSTALLATION AND APPROVED UPON COMPLETION OF PLANTING.
15. UPON COMPLETION OF PLANTING, BARE AREAS WITHIN THE SITE DISTURBANCE AREA AND ROW SHALL BE TOPSOILED PER SPEC 10 THEN MULCHED WITH 3" MEDIUM-COURSE BARK MULCH OR WOOD CHIIPS OR SEEDED WITH NATIVE RED FESCUE. ALL PLANTS AND SEEDED GROUND SHALL BE THOROUGHLY WATERED.
16. UPON APPROVAL OF PLANTING INSTALLATION BY AOA, KING COUNTY WILL BE NOTIFIED TO CONDUCT A SITE REVIEW FOR FINAL APPROVAL OF CONSTRUCTION.
17. ALL PLANTS SHALL BE WATERED VIA A TEMPORARY IRRIGATION SYSTEM. WATERING SHOULD OCCUR TWICE-WEEKLY JUNE 15-OCTOBER 31 THE FIRST YEAR AFTER PLANTING AND ONCE WEEKLY JULY 1-OCTOBER 1 THE SECOND YEAR AFTER PLANTING. FLOW SHOULD OCCUR AT A RATE OF 1/2" OF WATER DURING EACH WATERING EVENT, ENSURING COMPLETE SATURATION OF THE ROOT ZONE.
18. AN AS-BUILT DRAWING OF THE CRITICAL AREAS MITIGATION SHALL BE PROVIDED TO KC PERMITTING FOLLOWING COMPLETION OF THE ENTIRE PROJECT AND IMPLEMENTATION OF THE MITIGATION PLAN.

### ANNUAL MAINTENANCE SCHEDULE

MAINTENANCE ITEM	J	F	M	A	M	J	J	A	S	O	N	D
WEED CONTROL			I		I		I			I		
GENERAL MAINT.			I		I		I			I		
WATERING - YEAR 1						4	8	8	8	4		
WATERING - YEAR 2							4	4	4			

1-8 = NUMBER OF TIMES TASK SHALL BE PERFORMED PER MONTH.

PROJECT	6806
DRAWN	SO
SCALE	AS NOTED
DATE	12-9-22
REVISED	0/10

FIGURE 10: SPECIFICATIONS  
WEGNER PROPERTY  
KING COUNTY, WASHINGTON  
PARCEL 2524069066 - PREA22-0029

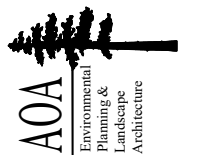

**Altmann Oliver Associates, LLC**  
Environmental  
Planning &  
Landscape  
Architecture  
PO Box 578 Carleton, WA 98014  
Office (425) 333-4338 Fax (425) 333-4399