

KING COUNTY INTERNATIONAL AIRPORT (KCIA)  
BOEING FIELD INTERNATIONAL (BFI)

**KPG**  
Interdisciplinary Design  
SEATTLE Tacoma  
3131 Elliott Ave Wenatchee  
Suite 400 WA 98121 Bellevue  
(206) 286 1640 www.kpg.com

K:\PROJECTS\UPS\18072-UPS BFI Gateway Expansion\Drawings\Architectural-Current\18072\_G006-SITE.dwg 10/31/2019 5:53 PM

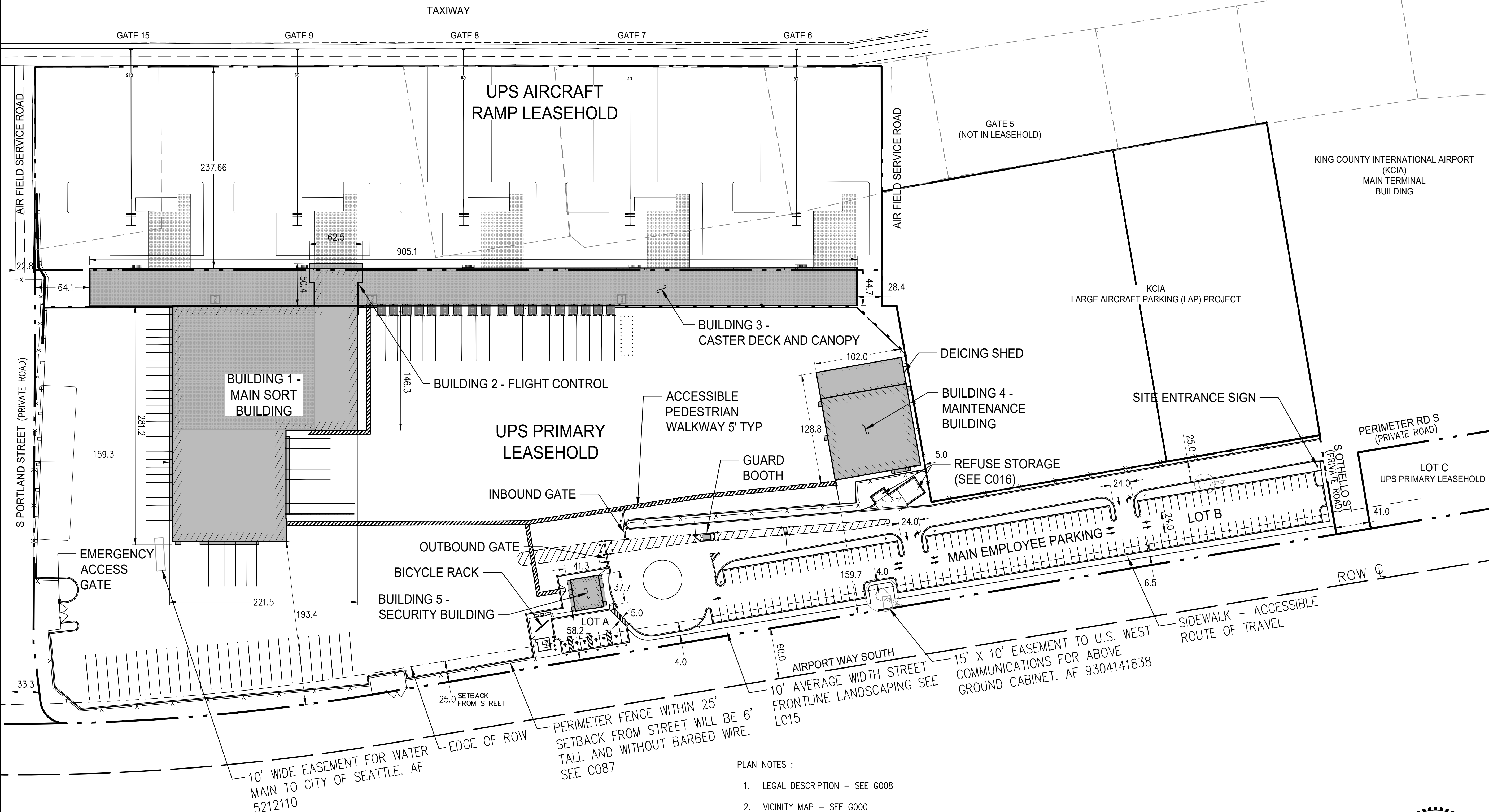

UPS BFI  
GATEWAY PROJECT  
GENERAL  
ARCHITECTURAL SITE PLAN

REVISIONS

NO.	DATE	BY	APPR.

SCALE: ONE INCH AS DRAWN

**Approved By**

DJ DEAN	OCT 2019
QA/QC MANAGER	DATE
CHARLIE CONWAY	AUG 2019
PROJECT MANAGER	DATE
DJ DEAN	MAY 2019
PROJECT ARCHITECT	DATE

18072\_G006-SITE.dwg  
FILENAME  
C CONWAY JULY 2019  
DESIGNED BY  
J PALMER JULY 2019  
DRAWN BY  
DJ DEAN AUG 2019  
CHECKED BY

**PARKING COUNT**

LOT A	7 <sup>1</sup>
LOT B	146
LOT C (EXISTING)	43
TOTAL	196

- PARKING NOTES:**
- 6 ACCESSIBLE STALLS, INCLUDING ONE VAN
  - SEE SHEET G004 FOR PARKING CALCULATIONS
  - ALL STANDARD STALLS 9'X18' (NO COMPACT STALLS)
  - ADA STALL DETAILS - SEE C048

- PLAN NOTES :**
- LEGAL DESCRIPTION - SEE G008
  - VICINITY MAP - SEE G000
  - ZONING ON ALL ABUTTING PROPERTIES - 1/"INDUSTRIAL ZONE"
  - LIGHTING PLAN - SEE E011 & E012
  - BUILDINGS SCHEDULED FOR DEMOLITION - SEE D010
  - NEW AND EXISTING WATER MAINS, VALVES, AND FIRE HYDRANTS - SEE C030
  - BICYCLE PARKING AND RECYCLABLE STORAGE - SEE G007
  - PROPOSED SIGNS - SEE C041-C50

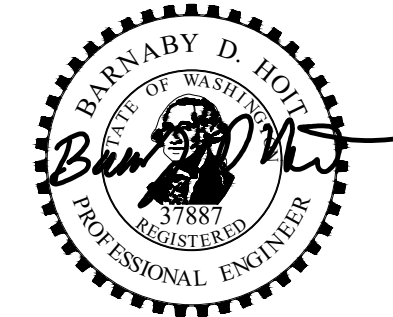
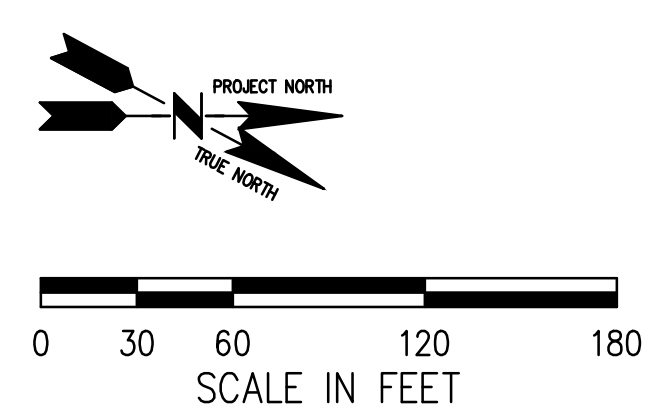

**PERMIT SUBMITTAL**  
11/01/2019

**G006**  
SHT 7 OF 344