

**GENERAL NOTES:**

1. ABBREVIATIONS, NOTES, AND LEGEND ARE SPECIFIC TO THE LWM DRAWINGS. FOR SITEWIDE ABBREVIATIONS, NOTES, AND LEGENDS, SEE DRAWING GN002.
2. BASEMAPMING BASED ON 03/16/22 SURVEY COLLECTED BY THE CITY OF AUBURN AND SUPPLEMENTED BY 2020 LIDAR COLLECTED BY KING COUNTY.
3. ALL WOOD USED IN THE LWM STRUCTURE ARE TREES REMOVED AS PART OF THE COAL CREEK SPRINGS TRANSMISSION MAIN REPLACEMENT PROJECT. REFER TO SHEET CT101 FOR TREE REMOVAL.

**ABBREVIATIONS:**

- APPROX. APPROXIMATELY  
 HVF HIGH VISIBILITY FENCE  
 LWM LARGE WOODY MATERIAL  
 OHWM ORDINARY HIGH WATER MARK  
 SFHA SPECIAL FLOOD HAZARD AREA

**LEGEND:**

- XX — EXISTING MAJOR (5') CONTOUR
- — — EXISTING MINOR (1') CONTOUR
- OHWM — ORDINARY HIGH WATER MARK
- EDW — EDGE OF WATER (SURVEYED)
- [Hatched Box] STRAW WATTLE
- HVF — HIGH VISIBILITY FENCE
- — — SILT FENCE
- SFHA — SPECIAL FLOOD HAZARD AREA
- [Thick Line] PROPOSED LWM WITH ROOTWAD
- [Thin Line] PROPOSED LWM NO ROOTWAD
- - - TOE OF LEVEE (APPROX.)
- [Box with X] TREE NUMBER
- [Triangle with V] WATER SURFACE ELEVATION

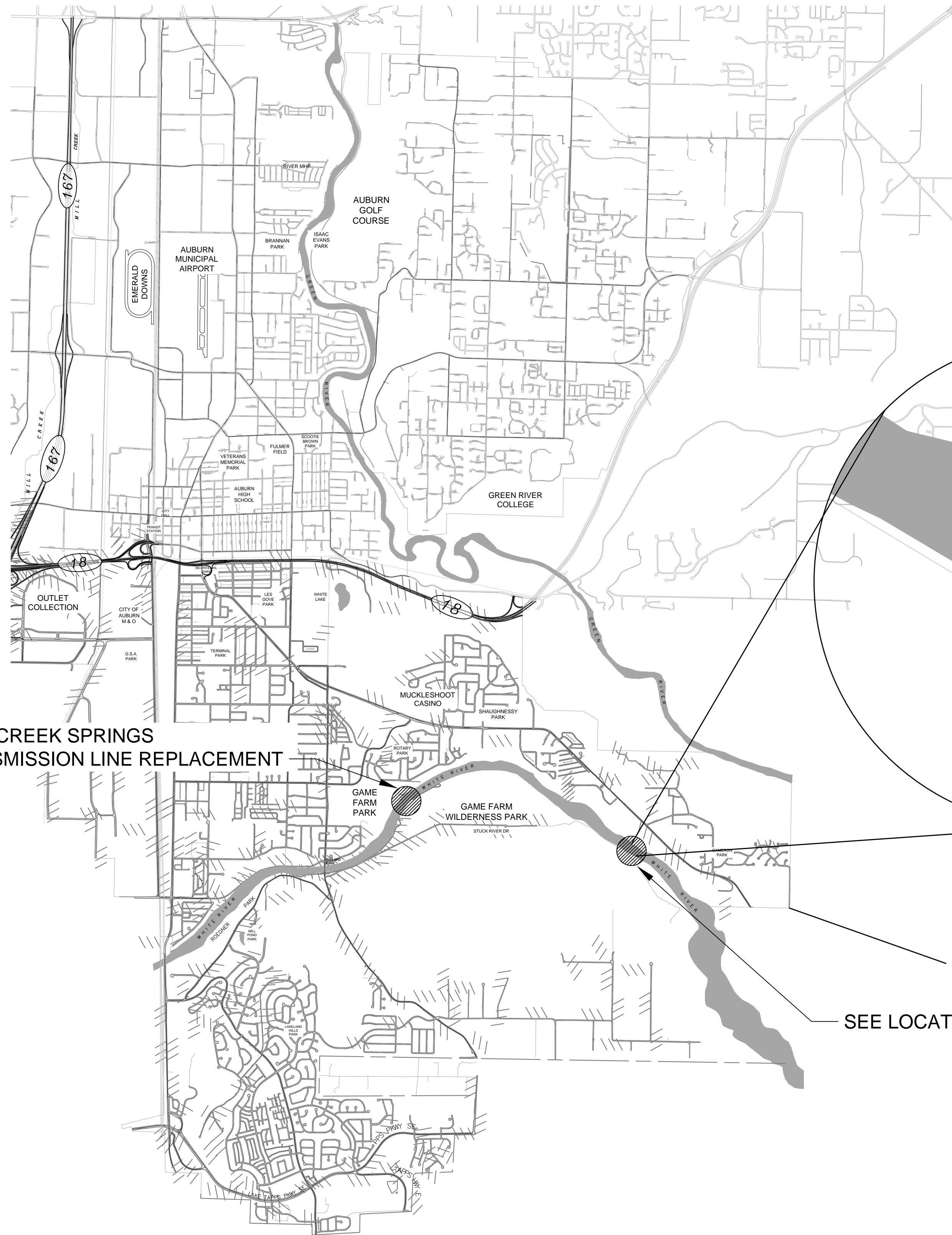

**COAL CREEK SPRINGS TRANSMISSION LINE REPLACEMENT**

**VICINITY MAP**

SCALE: 1" = 2500'



SEE LOCATION MAP

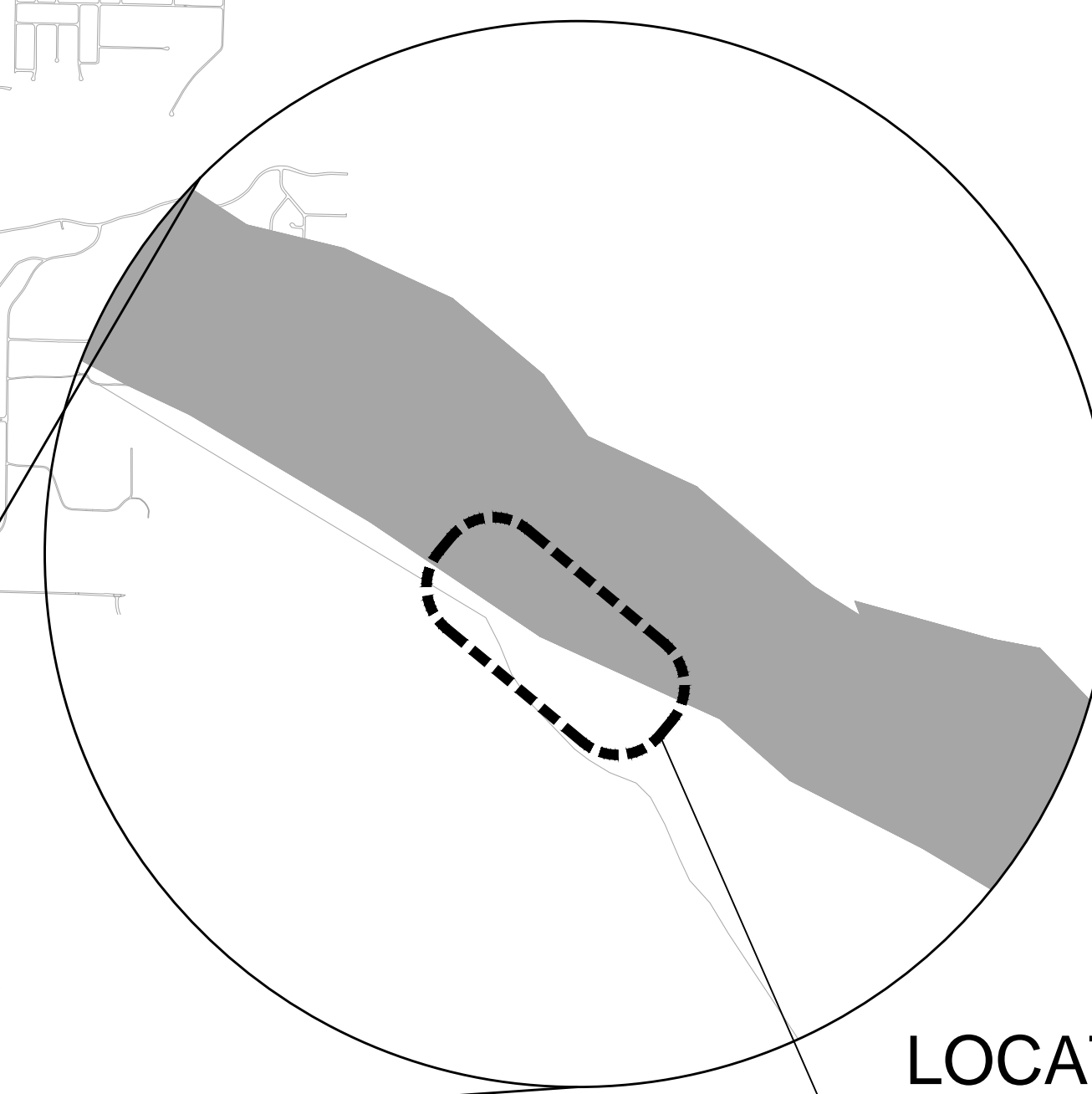

**LOCATION MAP**

SCALE: 1" = 250'



PROJECT SITE

**BID SET**

PROJECT REF: GRA22-0034

THESE PLANS ARE APPROVED FOR CONFORMANCE WITH THE CITY OF AUBURN ENGINEERING REQUIREMENTS.

APPROVED BY: [Signature]  
 DATE APPROVED: 6.21.2023

No.	Date:	Revision:	Completed By:

BY:	DATE:
Designed BSW	05/13/2022
Reviewed KW	05/16/2022
Approved KW	01/23/2023

SCALE: AS NOTED  
 ONE INCH AT FULL SCALE  
 (IF NOT, SCALE ACCORDINGLY)  
 File: CP1603-CS100.DWG

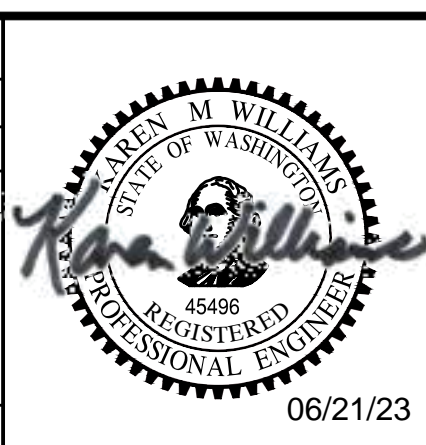

REVIEWED BY PROJECT MANAGER:  
 [Signature]  
 Signature Date  
 Seth Wickstrom, Project Manager 6/21/2023

**COAL CREEK SPRINGS TRANSMISSION MAIN REPLACEMENT PROJECT**  
 LARGE WOODY MATERIAL  
 GENERAL NOTES & LEGEND

PROJECT NO. CP1603
CONTRACT NO. 21-03
DRAWING NO. CS100
SHEET 35 OF 41

01/26/23 11:56:00 PM I:\WORKSPACES\CP1603\DRAWINGS\CP1603-CS100.DWG



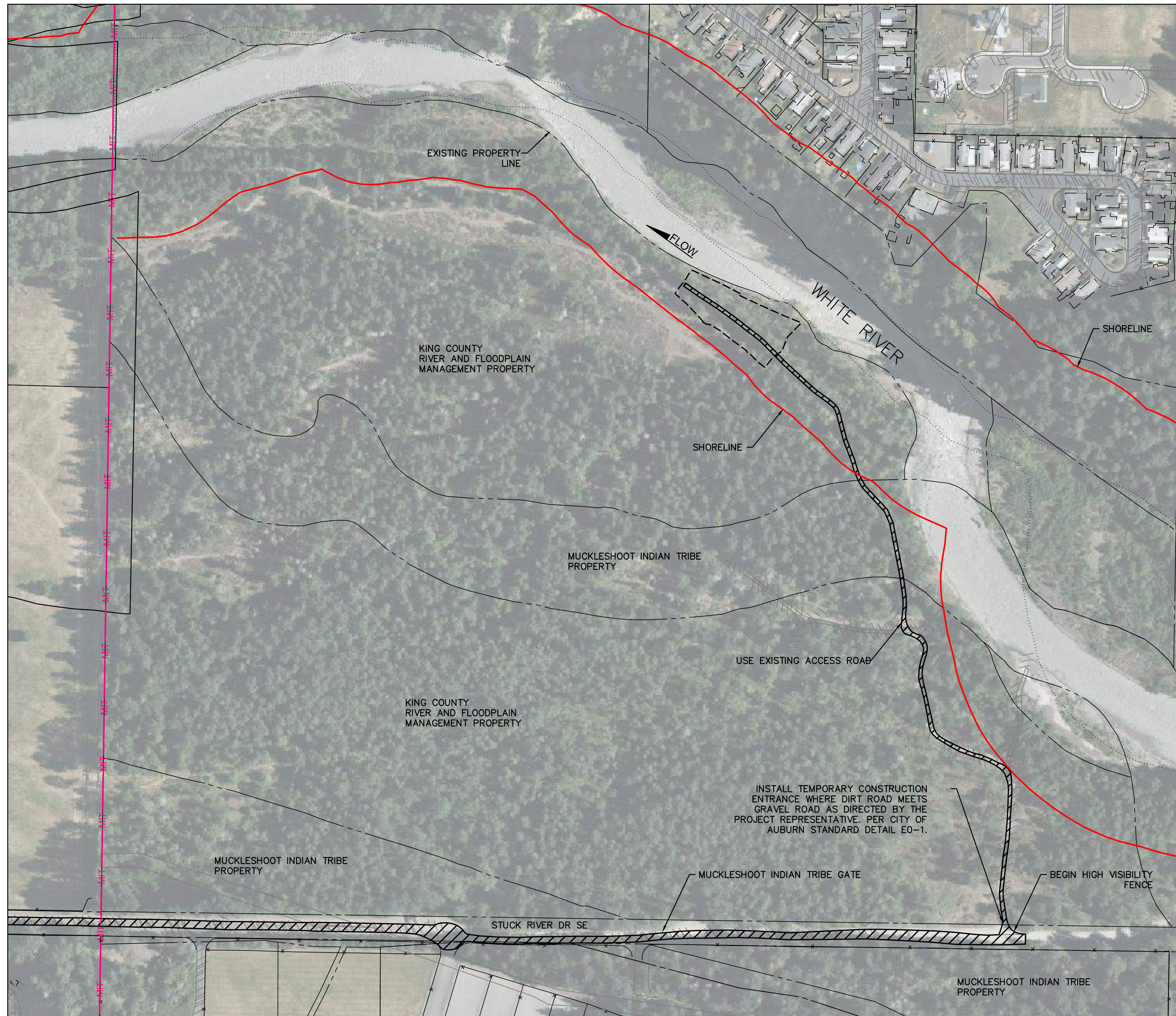

**NOTE:**  
PROPERTY LINES AND RIGHT-OF-WAY SHOWN ARE SOURCED FROM CITY OF AUBURN GIS DATABASE, AND ARE NOT INTENDED TO IMPLY A BOUNDARY SURVEY.

**ACCESS AND TRAFFIC CONTROL NOTES:**

1. HEAVY TRUCK AND EQUIPMENT ACCESS AND EGRESS TO SITE IS ONLY VIA STUCK RIVER DR SE.
2. CONTRACTOR ACCESS THRU GATE SHALL BE COORDINATED IN ADVANCE WITH CITY'S ENGINEER.
3. CLOSE AND SECURE EXISTING MIT GATE AFTER EACH WORKDAY.
4. TRAFFIC CONTROL SIGNAGE SHALL BE INSTALLED IN COMPLIANCE WITH MUTCD SECTION 2A. 16.
5. INSTALL HIGH VISIBILITY FENCE ALONG ACCESS ROUTE AFTER LEAVING STUCK RIVER DR SE.
6. EXISTING ACCESS ROAD MAINTENANCE MAY BE REQUIRED DURING CONSTRUCTION. AFTER CONSTRUCTION, CONTRACTOR SHALL REMOVE TEMPORARY CONSTRUCTION ENTRANCE AND RESTORE ACCESS ROAD TO PRE-PROJECT CONDITIONS.
7. EXISTING CONDITIONS ALONG THE ROADWAY ARE REQUIRED TO BE DOCUMENTED PRIOR TO THE USE OF THE ROADWAY FOR THE PROJECT. FOLLOWING THE COMPLETION OF THE PROJECT THE CONDITION OF THE ROADWAY SHALL BE RE-EVALUATED BY THE ENGINEER. ANY IMPACTED AREAS OF PAVEMENT SHALL BE IDENTIFIED THROUGH A COMPARISON OF BEFORE AND AFTER CONDITIONS, AND APPROPRIATE REPAIRS BE MADE BY THE CONTRACTOR.

**LEGEND:**

- — — — — PROPERTY LINES
- - - - - PROJECT LIMITS
- MIT — MUCKLESHOOT INDIAN TRIBAL LANDS BOUNDARY
- ..... RIVER DESIGNATION
- — — — — SHORELINE DESIGNATION
- ▨ ACCESS

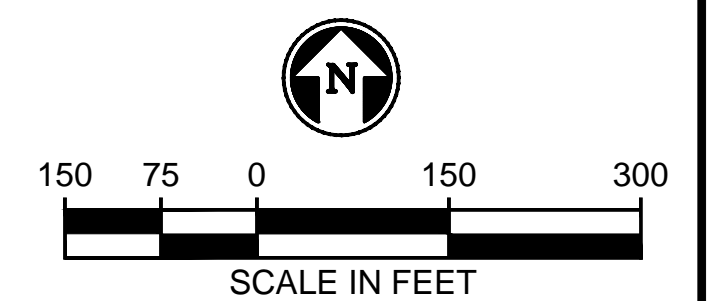

**PLAN**  
SCALE: 1" = 150'

PROJECT REF: GRA22-0034  
THESE PLANS ARE APPROVED FOR CONFORMANCE WITH THE CITY OF AUBURN ENGINEERING REQUIREMENTS.  
APPROVED BY: *[Signature]*  
DATE APPROVED: 6.21.2023

**BID SET**

No.	Date:	Revision:	Completed By:

BY:	DATE:
Designed BSW	05/13/2022
Reviewed KW	05/16/2022
Approved KW	01/23/2023

SCALE: AS NOTED  
ONE INCH  
AT FULL SCALE  
(IF NOT, SCALE ACCORDINGLY)  
File: CP1603-CS101.DWG

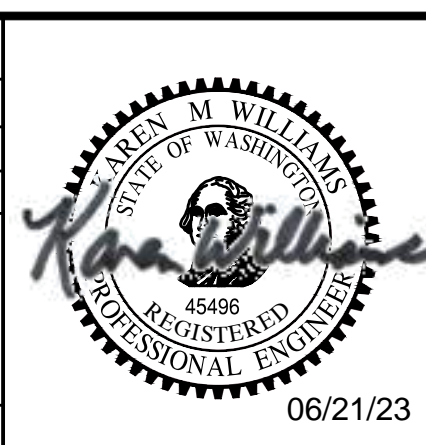

REVIEWED BY PROJECT MANAGER:  
*[Signature]*  
Signature Date  
Seth Wickstrom, Project Manager 6/21/2023

COAL CREEK SPRINGS TRANSMISSION  
MAIN REPLACEMENT PROJECT  
LARGE WOODY MATERIAL  
SITE ACCESS PLAN

PROJECT NO. CP1603
CONTRACT NO. 21-03
DRAWING NO. CS101
SHEET 36 OF 41

01/18/23 11:55 AM I:\WORKERS\SEAN.FELDMAN\24772601700 CAD\DD170\_PSELL\WCP1603-CS101.DWG



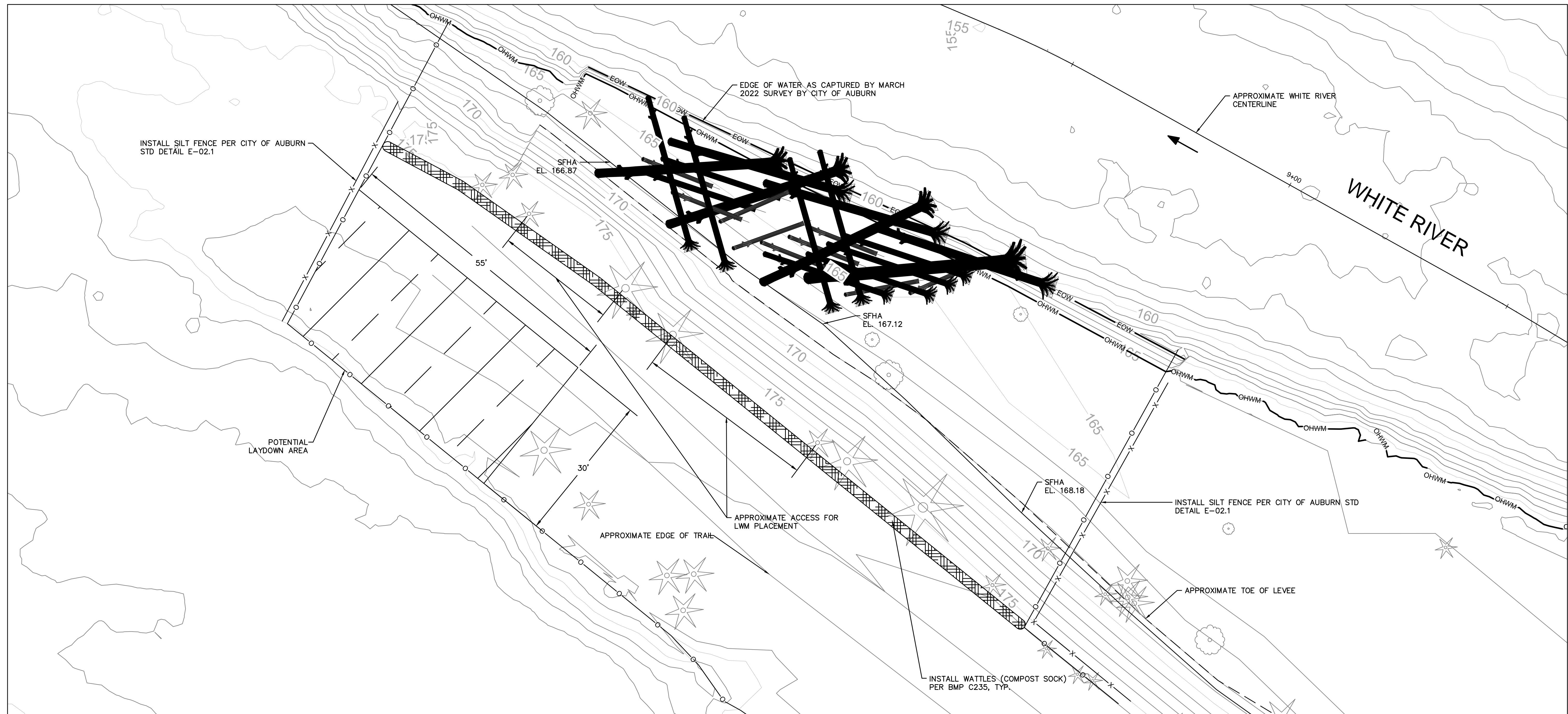

**PLAN**

SCALE: 1" = 10'

**SITE PREPARATION AND TESC NOTES:**

1. PLACE HIGH VISIBILITY FENCING AROUND PROJECT AND LAYDOWN AREAS. FENCE IS SHOWN GRAPHICALLY ONLY. IT IS THE CONTRACTORS RESPONSIBILITY TO ISOLATE THE WORK AREA.
2. THE IMPLEMENTATION OF THE TESC PLAN IS THE RESPONSIBILITY OF THE CONTRACTOR UNTIL ALL CONSTRUCTION IS APPROVED.
3. REMOVE ALL TEMPORARY EROSION AND SEDIMENT CONTROL MEASURES UPON COMPLETION OF THE PROJECT.
4. TREES ON SITE ARE NOT TO BE REMOVED. ANY TRIMMING TO BE DONE AT THE DIRECTION OF A CERTIFIED ARBORIST.
5. TOE OF LEVEE IS APPROXIMATE, BASED ON TOPOGRAPHY.

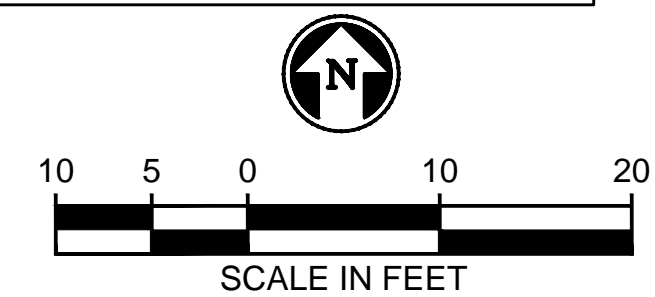

**BID SET**

PROJECT REF: GRA22-0034

THESE PLANS ARE APPROVED FOR CONFORMANCE WITH THE CITY OF AUBURN ENGINEERING REQUIREMENTS.

APPROVED BY: *[Signature]*  
DATE APPROVED: 6.21.2023

No.	Date:	Revision:	Completed By:

BY:	DATE:
Designed BSW	05/13/2022
Reviewed KW	05/16/2022
Approved KW	01/23/2023

SCALE: AS NOTED  
ONE INCH AT FULL SCALE  
(IF NOT, SCALE ACCORDINGLY)  
File: CP1603-CS102.DWG

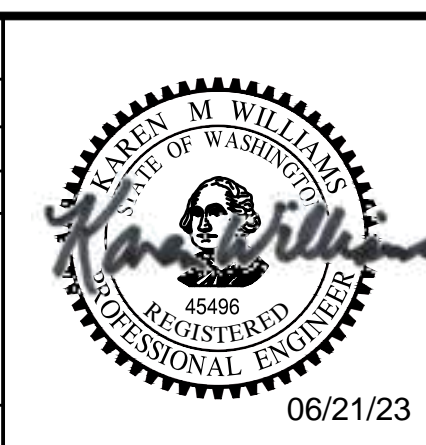

**Jacobs**

REVIEWED BY PROJECT MANAGER:  
*[Signature]*  
Signature Date  
Seth Wickstrom, Project Manager 6/21/2023

COAL CREEK SPRINGS TRANSMISSION  
MAIN REPLACEMENT PROJECT  
LARGE WOODY MATERIAL  
SITE PREPARATION AND TESC PLAN

PROJECT NO. CP1603
CONTRACT NO. 21-03
DRAWING NO. CS102
SHEET 37 OF 41

01/25/23 1:54:48 PM I:\WORKERS\SEALED\PROJECTS\2022\CP1603\CP1603-CS102.DWG



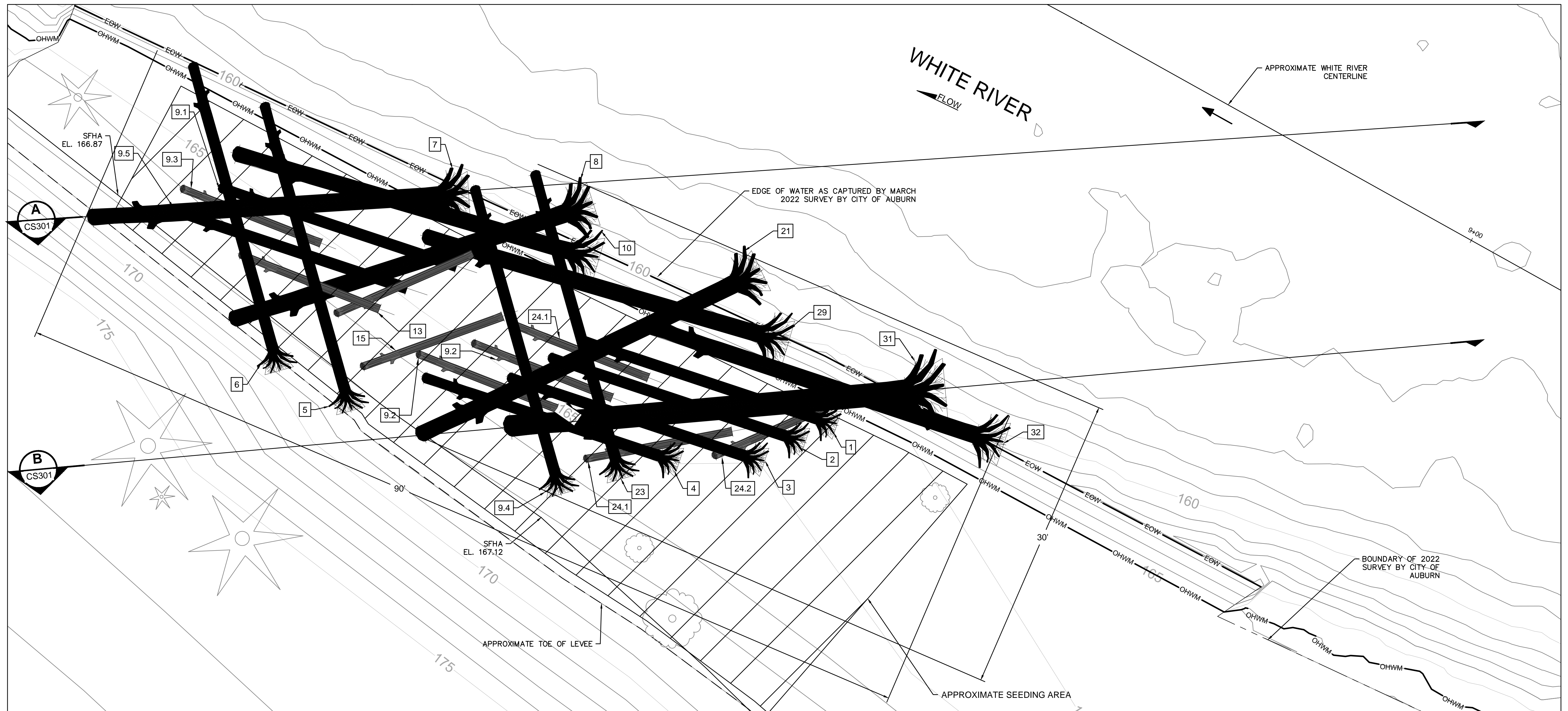

**PLAN**

SCALE: 1" = 5'

**LARGE WOODY MATERIAL NOTES:**

1. LWM STRUCTURE TO BE BUILT IN LIFTS. SEE DRAWING CS501 FOR ADDITIONAL INFORMATION.
2. NON-STRUCTURAL WOOD (COTTONWOOD AND ALDER) AND SLASH TO BE INCORPORATED INTO STRUCTURE VOIDS BETWEEN LAYERS. NOT SHOWN IN PLAN VIEW FOR CLARITY.
3. LARGE WOODY MATERIAL STRUCTURE TO BE SURFACE-PLACED, SELF-BALLASTED, AND FIELD FIT. FINAL LOG ORIENTATION TO BE DETERMINED BY THE ENGINEER.
4. NO EXCAVATION OR FILL TO OCCUR BELOW OHWM.
5. LARGE WOODY MATERIAL TO BE PLACED OUTSIDE OF LEVEE PRISM.
6.  DESIGNATES TREE NUMBER. SEE LARGE WOODY MATERIAL TABLE ON DRAWING CS501 FOR TREE SPECIES AND SIZING.
7. LWM WITH ROOTWADS WILL GENERALLY BE PLACED WITH ROOTWADS FACING UPSTREAM.
8. AREAS DISTURBED BEYOND TOE OF LEVEE TO BE RESTORED AS SHOWN ON SHEET CS104.

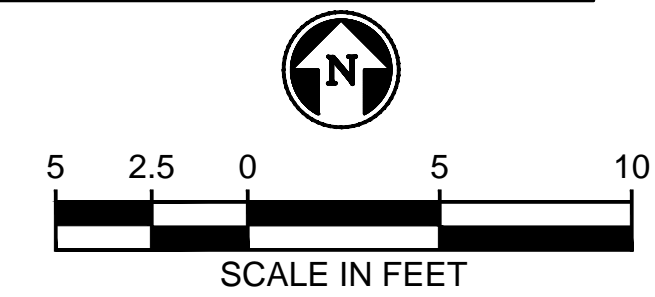

PROJECT REF: GRA22-0034  
 THESE PLANS ARE APPROVED FOR CONFORMANCE WITH THE CITY OF AUBURN ENGINEERING REQUIREMENTS.  
 APPROVED BY: *[Signature]*  
 DATE APPROVED: 6.21.2023

**BID SET**

No.	Date:	Revision:	Completed By:

BY:	DATE:
Designed BSW	05/13/2022
Reviewed KW	05/16/2022
Approved KW	01/23/2023

SCALE: AS NOTED  
 ONE INCH AT FULL SCALE  
 (IF NOT, SCALE ACCORDINGLY)  
 File: CP1603-CS103.DWG

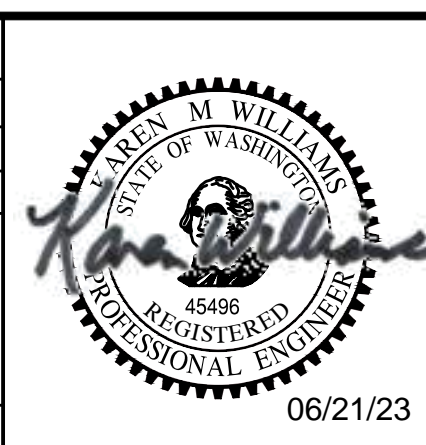

**Jacobs**

REVIEWED BY PROJECT MANAGER:  
*[Signature]* 6/21/2023  
 Signature Date  
 Seth Wickstrom, Project Manager

COAL CREEK SPRINGS TRANSMISSION  
 MAIN REPLACEMENT PROJECT  
 LARGE WOODY MATERIAL  
 PLAN VIEW

PROJECT NO. CP1603
CONTRACT NO. 21-03
DRAWING NO. CS103
SHEET 38 OF 41

01/25/23, 1:54:00 PM, I:\WORKERS\BSEBEL\WMP\1603-CS103.DWG



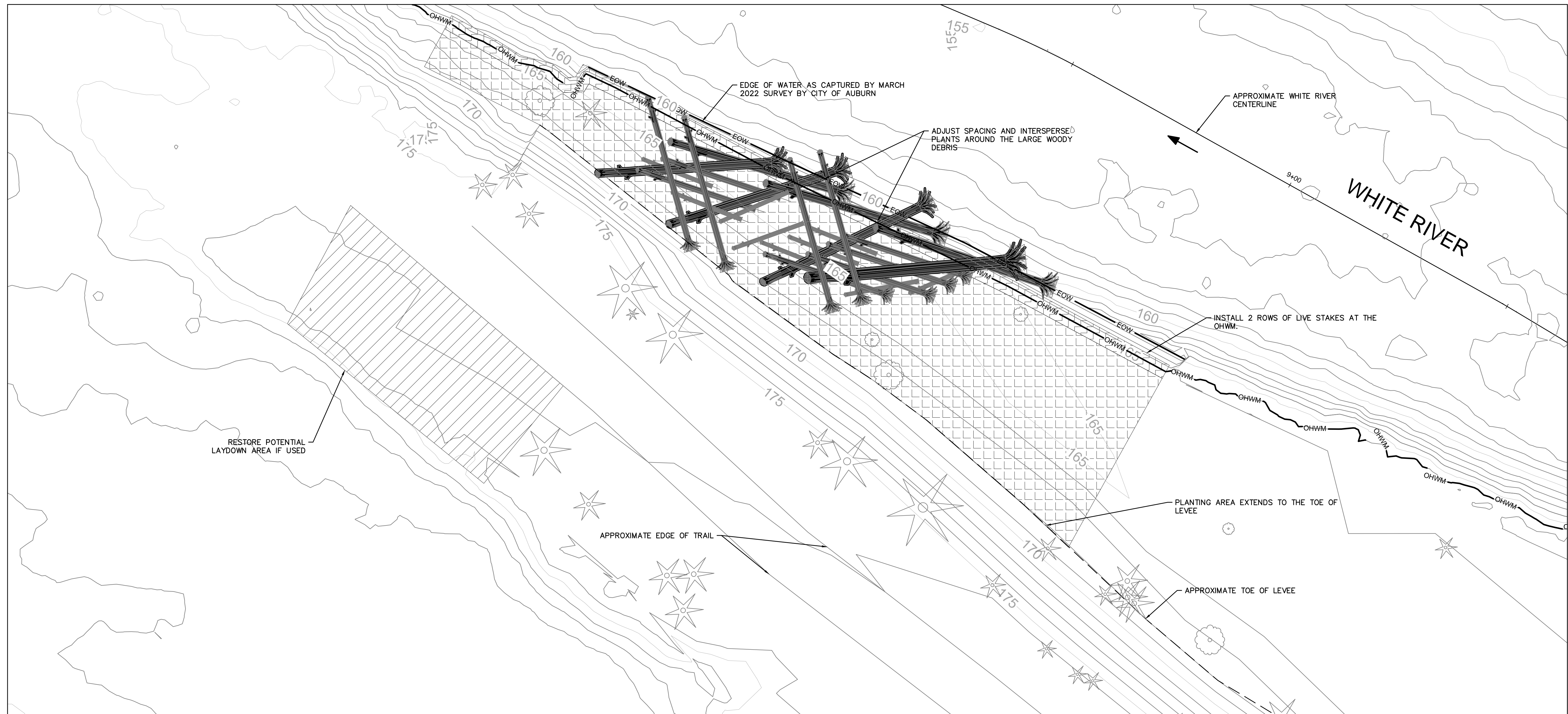

**PLAN**

SCALE: 1" = 10'

**GENERAL NOTES:**

1. SEE SHEET LD503-LD504 FOR PLANT SCHEDULE AND LANDSCAPE DETAILS.
2. SOIL PREPARATION WITHIN THE TREE PROTECTION ZONE (TPZ) OF RETAINED TREES OR WITHIN MIX C SHALL CONSIST OF THE FOLLOWING:
  - 2.1. PLACE COMPOST TO A 3-INCH DEPTH. NO INCORPORATION INTO THE SOIL.
  - 2.2. PLACE WOOD CHIP MULCH TO A 4-INCH DEPTH IN PLANTING AREAS OR SEED WITHIN LAWN AREAS.
3. SOIL PREPARATION OUTSIDE OF THE TPZ OF RETAINED TREES AND LIMITS OF TOPSOIL TYPE A SHALL CONSIST OF THE FOLLOWING:
  - 3.1. DECOMPACT TO AN 18-INCH DEPTH.
  - 3.2. PLACE SOIL AMENDMENT TO A 4-INCH DEPTH AND INCORPORATE TO A 12-INCH DEPTH.
  - 3.3. PLACE WOOD CHIP MULCH TO A 4-INCH DEPTH IN PLANTING AREAS OR SEED WITHIN LAWN AREAS.
4. GROUP SHRUBS IN SAME SPECIES CLUSTERS OF 7-12 PLANTS.
5. THE CONTRACTOR SHALL ERADICATE KING COUNTY NOXIOUS WEEDS LIST A, B, AND C WEEDS AND OTHER PLANTS AS DIRECTED BY THE ENGINEER WITHIN THE LIMITS OF THE PLANTING AREAS.

**LEGEND:**

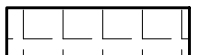
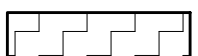
-  MIX A- RIPARIAN RESTORATION
-  MIX D- FLOODPLAIN RESTORATION
-  MIX E- LIVE STAKES

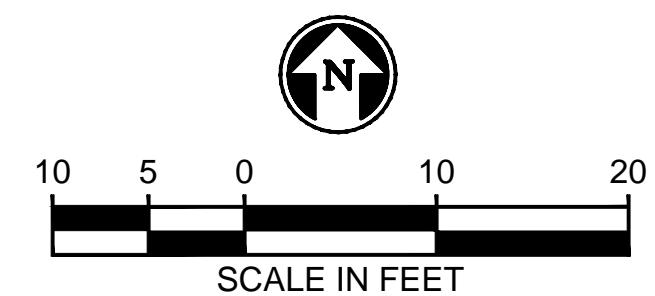

PROJECT REF: GRA22-0034

THESE PLANS ARE APPROVED FOR CONFORMANCE WITH THE CITY OF AUBURN ENGINEERING REQUIREMENTS.

APPROVED BY:   
DATE APPROVED: 6.21.2023

**BID SET**

No.	Date:	Revision:	Completed By:

BY:	DATE:
Designed LF	10/31/2022
Reviewed CF	10/31/2022
Approved LF	10/31/2022

SCALE: AS NOTED  
ONE INCH  
AT FULL SCALE  
(IF NOT, SCALE ACCORDINGLY)  
File: CP1603-CS104.DWG



REVIEWED BY PROJECT MANAGER:



Signature Date 6/21/2023

Seth Wickstrom, Project Manager

COAL CREEK SPRINGS TRANSMISSION  
MAIN REPLACEMENT PROJECT  
LARGE WOODY MATERIAL  
PLANTING PLAN

PROJECT NO.  
CP1603  
CONTRACT NO.  
21-03  
DRAWING NO.  
CS104  
SHEET 39  
OF 41



**LARGE WOODY MATERIAL NOTES:**

1. LWM STRUCTURE TO BE BUILT IN LAYERS. SEE DRAWING CS501 FOR ADDITIONAL INFORMATION.
2. NON-STRUCTURAL WOOD (COTTON WOOD AND ALDER) AND SLASH TO BE INCORPORATED INTO STRUCTURE VOIDS BETWEEN LAYERS. NOT SHOWN IN PLAN VIEW FOR CLARITY.
3. LARGE WOODY MATERIAL STRUCTURE TO BE SURFACE-PLACED, SELF-BALLASTED, AND FIELD FIT. FINAL LOG ORIENTATION TO BE DETERMINED BY THE ENGINEER. ALL LOGS ARE TO BE PLACED WITHOUT CHAINS OR ANCHORS.
4. NO EXCAVATION OR FILL TO OCCUR BELOW OHWM.
5. LARGE WOODY MATERIAL TO BE PLACED BEYOND THE APPROXIMATE TOE OF THE LEVEE.
6. [X] DESIGNATES TREE NUMBER. SEE LARGE WOODY MATERIAL TABLE ON DRAWING CS501 FOR TREE SPECIES AND SIZING.
7. STATIONING OF CROSS SECTIONS IS BASED ON APPROXIMATE WHITE RIVER CENTERLINE. LOCATION OF CROSS SECTIONS IS SHOWN ON CS103.

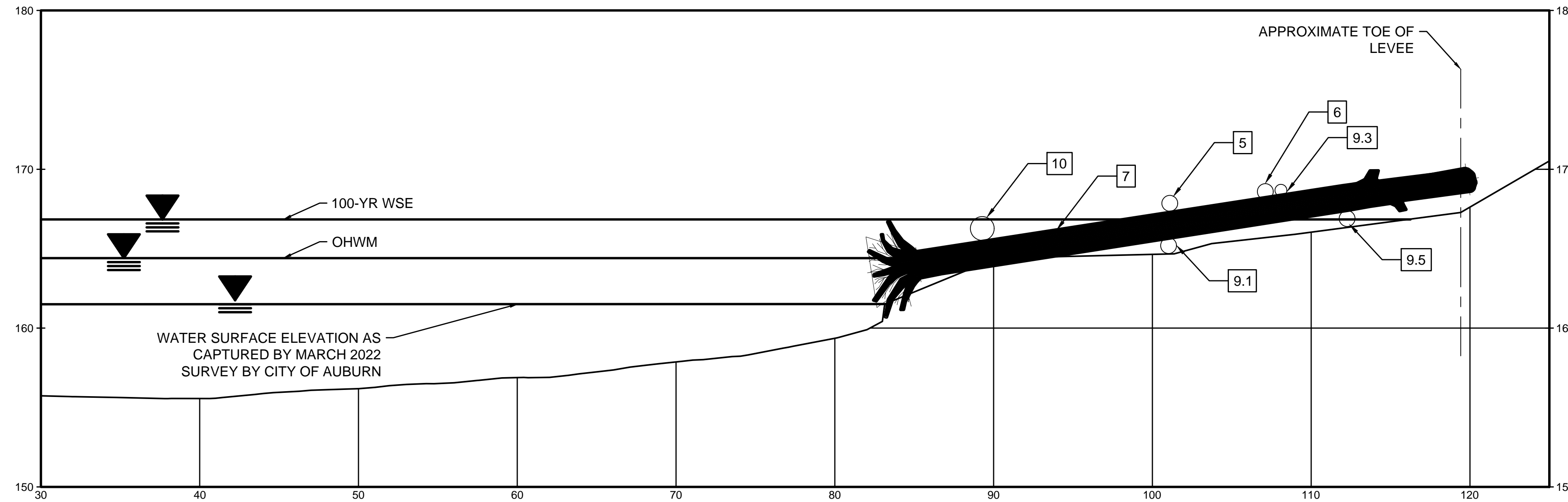

**SECTION A**  
SCALE: 1" = 5'

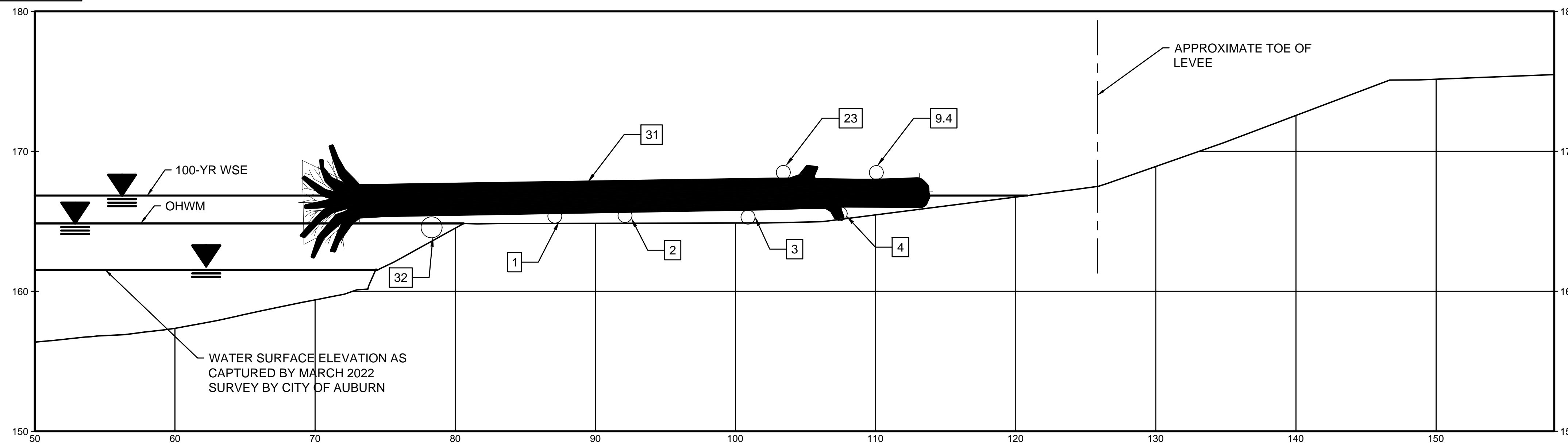

**SECTION B**  
SCALE: 1" = 5'

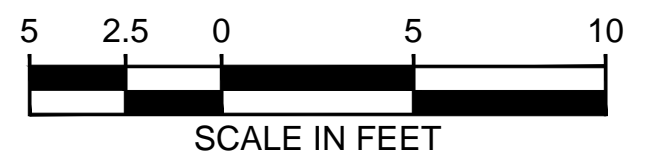

PROJECT REF: GRA22-0034  
 THESE PLANS ARE APPROVED FOR CONFORMANCE WITH THE CITY OF AUBURN ENGINEERING REQUIREMENTS.  
 APPROVED BY: *[Signature]*  
 DATE APPROVED: 6.21.2023

**BID SET**

01/18/23 11:55 AM I:\ENGINEERS\SEAN\PROJECTS\2022\72601700\CADD\72601700-CP1603-CS301.DWG

No.	Date:	Revision:	Completed By:

BY:	DATE:
Designed BSW	05/13/2022
Reviewed KW	05/16/2022
Approved KW	01/23/2023

SCALE: AS NOTED  
 ONE INCH AT FULL SCALE  
 (IF NOT, SCALE ACCORDINGLY)  
 File: CP1603-CS301.DWG

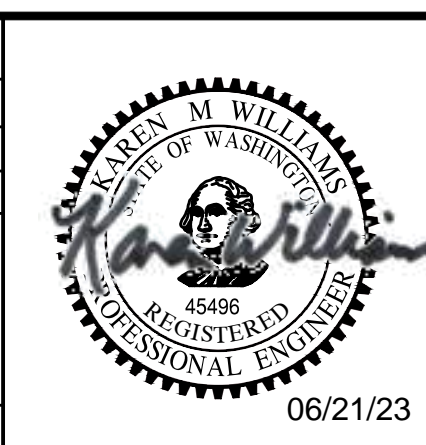

REVIEWED BY PROJECT MANAGER:  
*[Signature]*  
 Signature Date  
 Seth Wickstrom, Project Manager 6/21/2023

COAL CREEK SPRINGS TRANSMISSION  
 MAIN REPLACEMENT PROJECT  
 LARGE WOODY MATERIAL  
 SECTIONS

PROJECT NO. CP1603
CONTRACT NO. 21-03
DRAWING NO. CS301
SHEET 40 OF 41



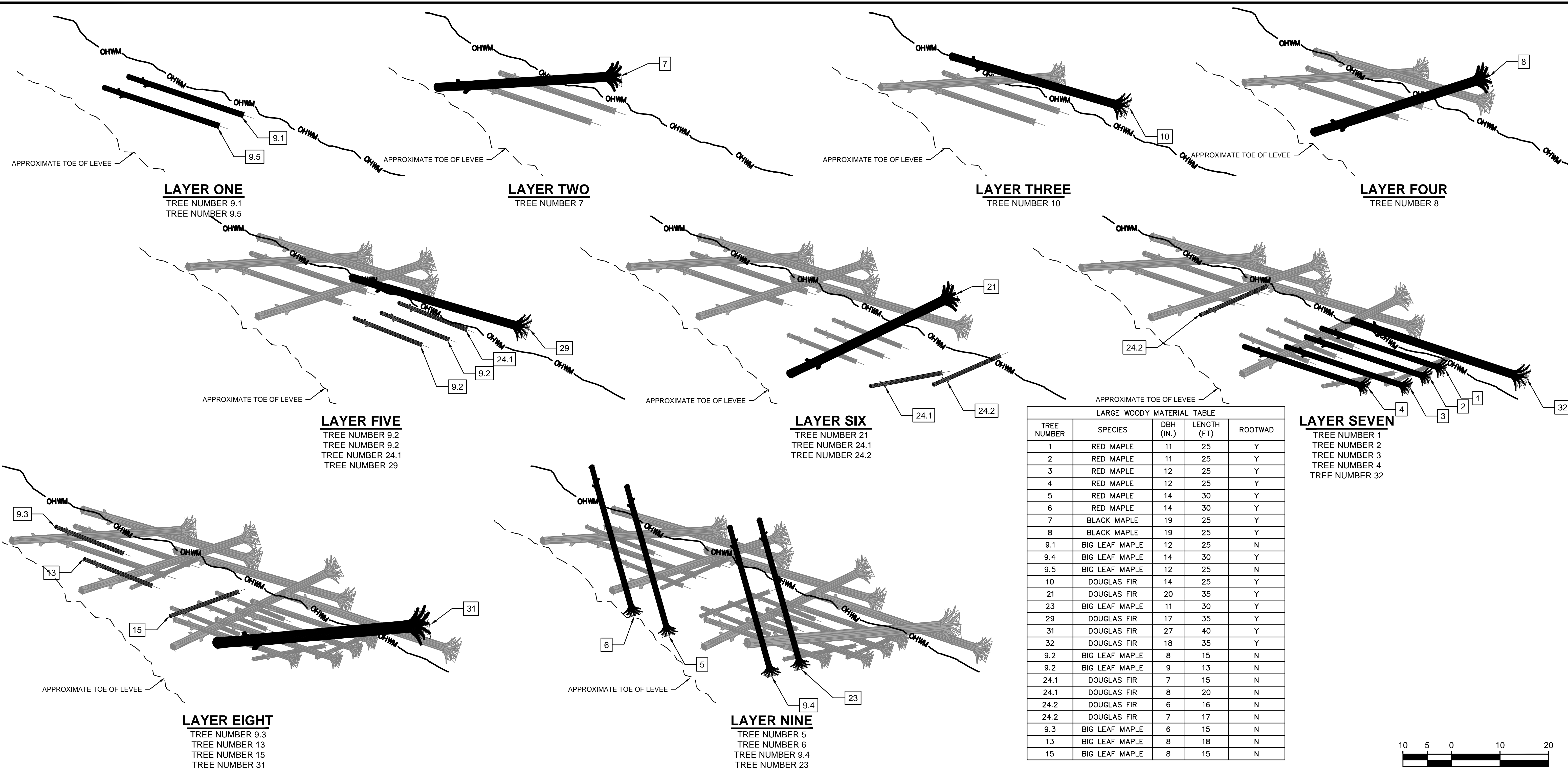

LARGE WOODY MATERIAL TABLE				
TREE NUMBER	SPECIES	DBH (IN.)	LENGTH (FT)	ROOTWAD
1	RED MAPLE	11	25	Y
2	RED MAPLE	11	25	Y
3	RED MAPLE	12	25	Y
4	RED MAPLE	12	25	Y
5	RED MAPLE	14	30	Y
6	RED MAPLE	14	30	Y
7	BLACK MAPLE	19	25	Y
8	BLACK MAPLE	19	25	Y
9.1	BIG LEAF MAPLE	12	25	N
9.4	BIG LEAF MAPLE	14	30	Y
9.5	BIG LEAF MAPLE	12	25	N
10	DOUGLAS FIR	14	25	Y
21	DOUGLAS FIR	20	35	Y
23	BIG LEAF MAPLE	11	30	Y
29	DOUGLAS FIR	17	35	Y
31	DOUGLAS FIR	27	40	Y
32	DOUGLAS FIR	18	35	Y
9.2	BIG LEAF MAPLE	8	15	N
9.2	BIG LEAF MAPLE	9	13	N
24.1	DOUGLAS FIR	7	15	N
24.1	DOUGLAS FIR	8	20	N
24.2	DOUGLAS FIR	6	16	N
24.2	DOUGLAS FIR	7	17	N
9.3	BIG LEAF MAPLE	6	15	N
13	BIG LEAF MAPLE	8	18	N
15	BIG LEAF MAPLE	8	15	N

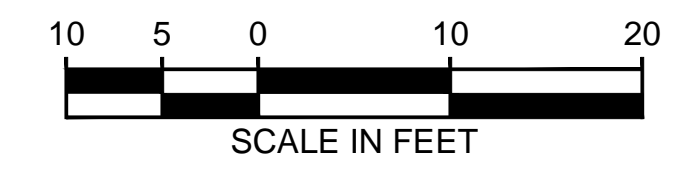

**LARGE WOODY MATERIAL NOTES:**

- IF LOGS ARE TO BE BROKEN TO MEET A REQUIRED LENGTH, THEY WILL BE CAREFULLY BROKEN (CUT) WITH EQUIPMENT TO CREATE A NATURAL LOOK, NOT CUT WITH A CHAINSAW WHICH FORMS STRAIGHT EDGES.
- LWM STRUCTURE TO BE BUILT IN LAYERS. SEE DRAWING CS501 FOR ADDITIONAL INFORMATION.
- NON-STRUCTURAL WOOD (COTTON WOOD AND ALDER) AND SLASH TO BE INCORPORATED INTO STRUCTURE VOIDS BETWEEN LAYERS. NOT SHOWN IN PLAN VIEW FOR CLARITY.
- LARGE WOODY MATERIAL STRUCTURE TO BE SURFACE-PLACED, SELF-BALLASTED, AND FIELD FIT. FINAL LOG ORIENTATION TO BE DETERMINED BY THE ENGINEER.
- NO EXCAVATION OR FILL TO OCCUR BELOW OHWM.
- LARGE WOODY MATERIAL TO BE PLACED BEYOND THE APPROXIMATE TOE OF LEVEE.
- LWM WITH ROOTWADS WILL GENERALLY BE PLACED WITH ROOTWADS FACING UPSTREAM.

PROJECT REF: GRA22-0034  
 THESE PLANS ARE APPROVED FOR CONFORMANCE WITH THE CITY OF AUBURN ENGINEERING REQUIREMENTS.  
 APPROVED BY: *[Signature]*  
 DATE APPROVED: 6.21.2023

**BID SET**

COAL CREEK SPRINGS TRANSMISSION  
 MAIN REPLACEMENT PROJECT  
 LARGE WOODY MATERIAL  
 DETAILS

PROJECT NO.  
 CP1603  
 CONTRACT NO.  
 21-03  
 DRAWING NO.  
 CS501  
 SHEET 41  
 OF 41

01/18/23 11:55 AM I:\WORKERS\... FILE: CP1603-CS501.DWG

No.	Date:	Revision:	Completed By:

BY:	DATE:
Designed BSW	05/13/2022
Reviewed KW	05/16/2022
Approved KW	01/23/2023

SCALE: AS NOTED  
 ONE INCH  
 AT FULL SCALE  
 (IF NOT, SCALE ACCORDINGLY)  
 File: CP1603-CS501.DWG

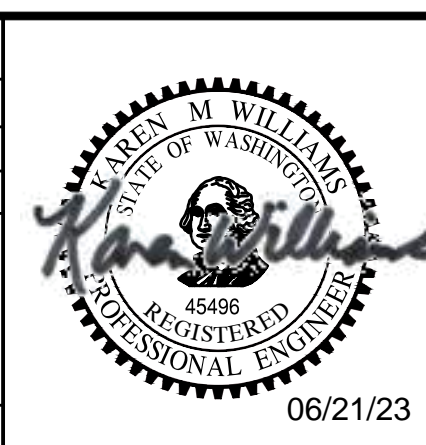

REVIEWED BY  
 PROJECT MANAGER:  
*[Signature]*  
 Signature Date  
 6/21/2023  
 Seth Wickstrom, Project Manager