



King County

Department of Natural Resources and Parks
Parks and Recreation Division
King Street Center
201 South Jackson Street, Suite 700
Seattle, WA 98104
<http://www.kingcounty.gov/parks>

SEPA Determination of Non-Significance

Date of Issue: May 31, 2017

Name of Proposal: Lake to Sound Trail – Segment C

Location of Proposal:

Segment C would connect the southern terminus of the Lake to Sound Trail—Segment B (near the southwest corner of Seattle-Tacoma International Airport) with the Des Moines Creek Trail, located at S 200th Street in the cities of Burien and SeaTac, Washington. The Segment C project area is a linear corridor that occurs mostly within the existing road rights-of-way for State Route (SR) 509 and Des Moines Memorial Drive (Figure 1). The project is located in Sections 4 and 5, Township 22 North, Range 4 East & Section 32, Township 23 North, Range 4 East.

Description of Proposal:

The Lake to Sound Trail—Segment C project is an approximately 2.2-mile (11,420 linear feet) component of what will ultimately be the 16-mile Lake to Sound Trail. Segment C would provide non-motorized access to recreation and employment centers and complete a link in the Regional Trail System network. The trail is intended to safely accommodate a variety of groups such as bicyclists, pedestrians, runners, wheelchair users, and skaters. Trail design standards will safely accommodate different ages and skill levels within those groups.

The trail design for Segment C is in accordance with American Association of State Highway and Transportation Officials' (AASHTO) guidelines. Features typically include:

- A 12-foot-wide paved trail with soft-surface (gravel) shoulders
- Separation of the trail from the adjacent road with a 3-foot planter strip
- Relocation of above-ground utilities
- Drainage improvements related to the trail as well as conveyance of stormwater from the adjacent road across the trail
- Retaining walls in some places to reduce the cut-and-fill areas needed for the trail
- Three 16-18 foot-wide boardwalk sections through wetlands
- Vacation of two sections of roadway

- Signal modifications at major intersections
- Wetland mitigation (4.22 acres) and stream/wetland buffer mitigation (1.51 acres)

Proponent/Lead Agency: King County Department of Natural Resources and Parks
Parks and Recreation Division

Responsible Official: Kevin Brown
Division Director, Parks and Recreation Division

Address: 201 South Jackson Street, Suite 700
Seattle, WA 98104-3855

DATE: 5/23/17

SIGNATURE: 

The lead agency for this proposal has determined that it does not have a probable significant adverse impact on the environment. An Environmental Impact Statement (EIS) is not required under Revised Code of Washington 43.21C.030(2)(c). This decision was made after review of a completed environmental checklist and other information on file with the lead agency. This information is available to the public on request (for a nominal photocopying fee). It is also available on the King County website at:

<http://www.kingcounty.gov/parks/publicnotices>

This Determination of Non-Significance is issued under Washington Administrative Code 197-11-340(2). The lead agency will not act on this proposal until after **June 14, 2017**. Comments must be submitted or postmarked by **4:30 PM on June 14, 2017**.

Important Note: To provide comments or request additional information please contact:

Jason Rich, Capital Project Manager
King County Parks and Recreation Division
201 South Jackson Street, Room 700
Seattle, WA 98104
206-477-7372 (SEPA)
KCParks.SEPA@kingcounty.gov

For email comments, please use the email address noted above and put **“Lake to Sound Trail”** in the Subject line.

Figure 1

Lake to Sound Trail – Segment C

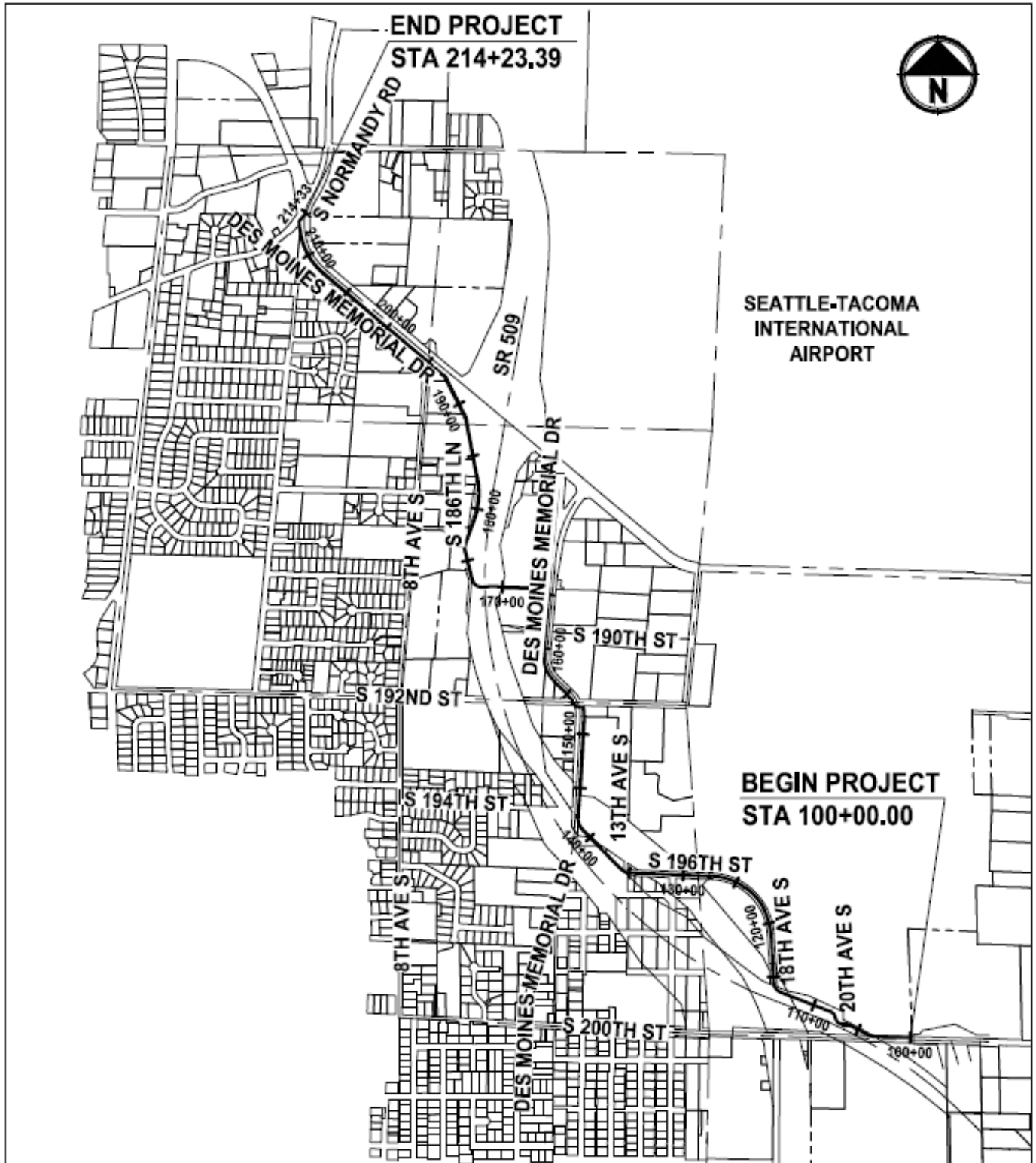

VICINITY MAP

NOT TO SCALE