



**King County**

Department of  
Natural Resources and Parks  
**Solid Waste Division**

Waste  
Prevention

Resource  
Recovery

Waste  
Disposal

# South County Recycling and Transfer Station

Virtual Community Event, August 25, 2021, 5 – 7 p.m.

# How to Participate

- Share your questions and comments using the Q&A box
- Let us know if you have any access needs
- If any technical issues arise...

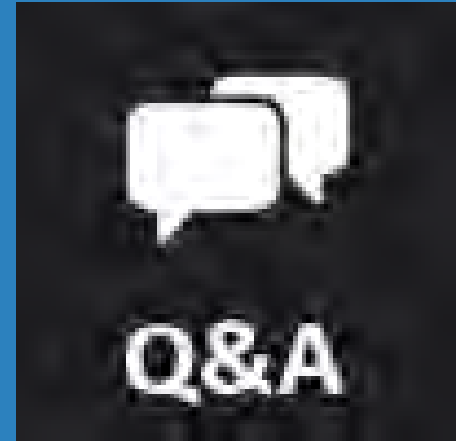

# Event Overview

- Welcome
- Mission, vision, values
- Project overview & 60% design
- Public art
- Equity and social justice actions
- Stay involved!
- Next steps
- Q&A



# Welcome!

## PROJECT TEAM

### King County Solid Waste Division

- Karen Herndon
- Nori Catabay

### 4Culture

- Laura Becker

### HDR team

- Clark Davis
- Ryan Asman
- Nigel Baummer
- Dennis Sandstrom
- Harrison Price
- Nicole Phaysith

# Share Your Thoughts



Scan QR code, follow link, or  
go to [menti.com](https://www.menti.com) and enter the  
code 4869 5512



**King County**

Department of  
Natural Resources and Parks  
**Solid Waste Division**

# About Solid Waste Division

## Vision

We achieve zero waste of resources and enhance the environment through collaboration and innovation.

## Mission

We bring the best people together to deliver value to our customers and stakeholders and continuously improve waste prevention, resource recovery, and waste disposal.





# Our Vision for Our Culture

Employees are valued, engaged, and working together for a common purpose.

*(Collaborative, Fair & Just)*

Everyone leads by example, always.

*(Accountable)*

Leadership empowers their teams to succeed and holds them accountable for their results.

*(Results-focused)*

We constantly seek to eliminate waste and variability from our processes.

*(Innovative)*

We love our customers and respect our stakeholders.

*(Service oriented)*

We are forward thinking and conscientious about risk management.

*(Professional)*



**King County**

Department of  
Natural Resources and Parks  
Solid Waste Division

Waste  
Prevention

Resource  
Recovery

Waste  
Disposal

# Project Location

- New station will be located at 35101 W. Valley Hwy S., just north of the existing station in Algona
- Will replace the existing Algona Transfer Station
- Will serve Algona, Auburn, Federal Way, Pacific, and surrounding communities

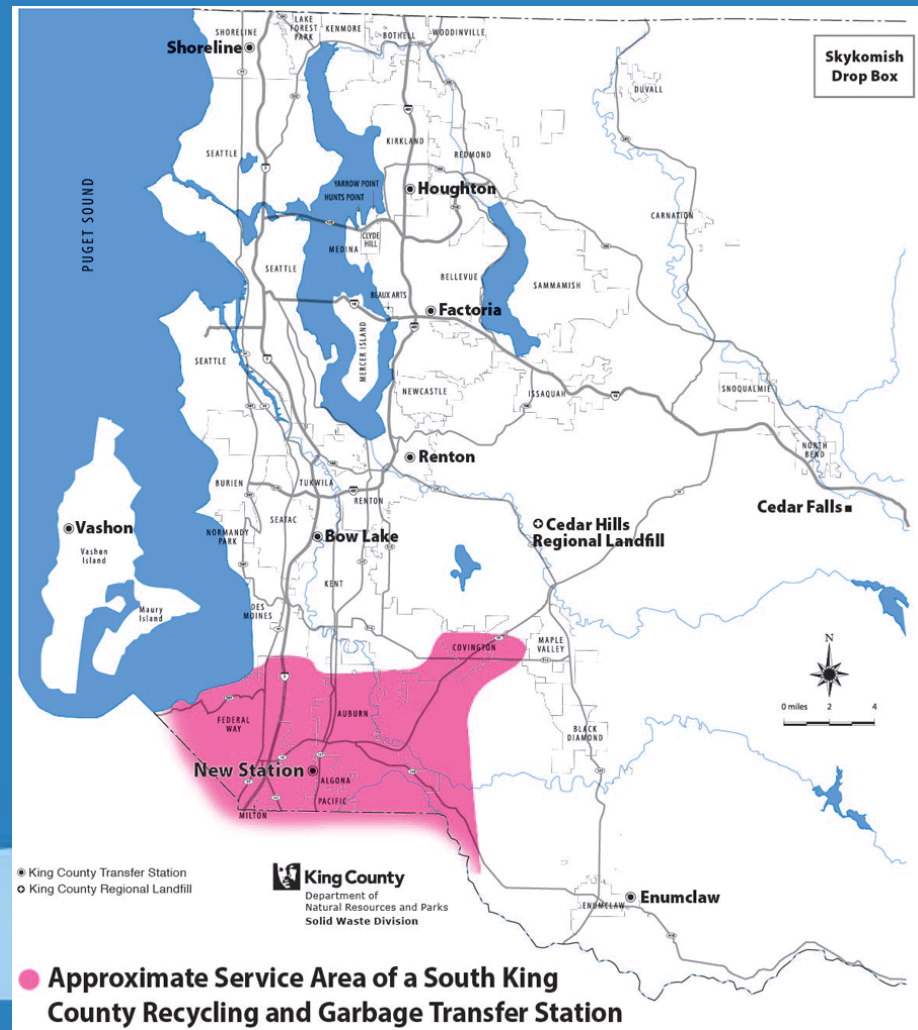



# Timeline



# Services



Recycling



Yard Waste



Moderate  
Risk Waste



Garbage



**King County**

Department of  
Natural Resources and Parks  
**Solid Waste Division**

# Additional Features



Stream  
Relocation  
and Wetlands  
Mitigation



Road  
Improvements



Storm water  
management



Green  
Building



Public Art



**King County**

Department of  
Natural Resources and Parks  
**Solid Waste Division**

# Share Your Thoughts



Scan QR code, follow link, or go to  
[menti.com](https://www.menti.com) and enter the code  
**8853 1331**



# 60% Overall Site Plan

**GENERAL NOTES:**  
1. OVERALL SITE PLAN SHOWN FOR INFORMATION ONLY.

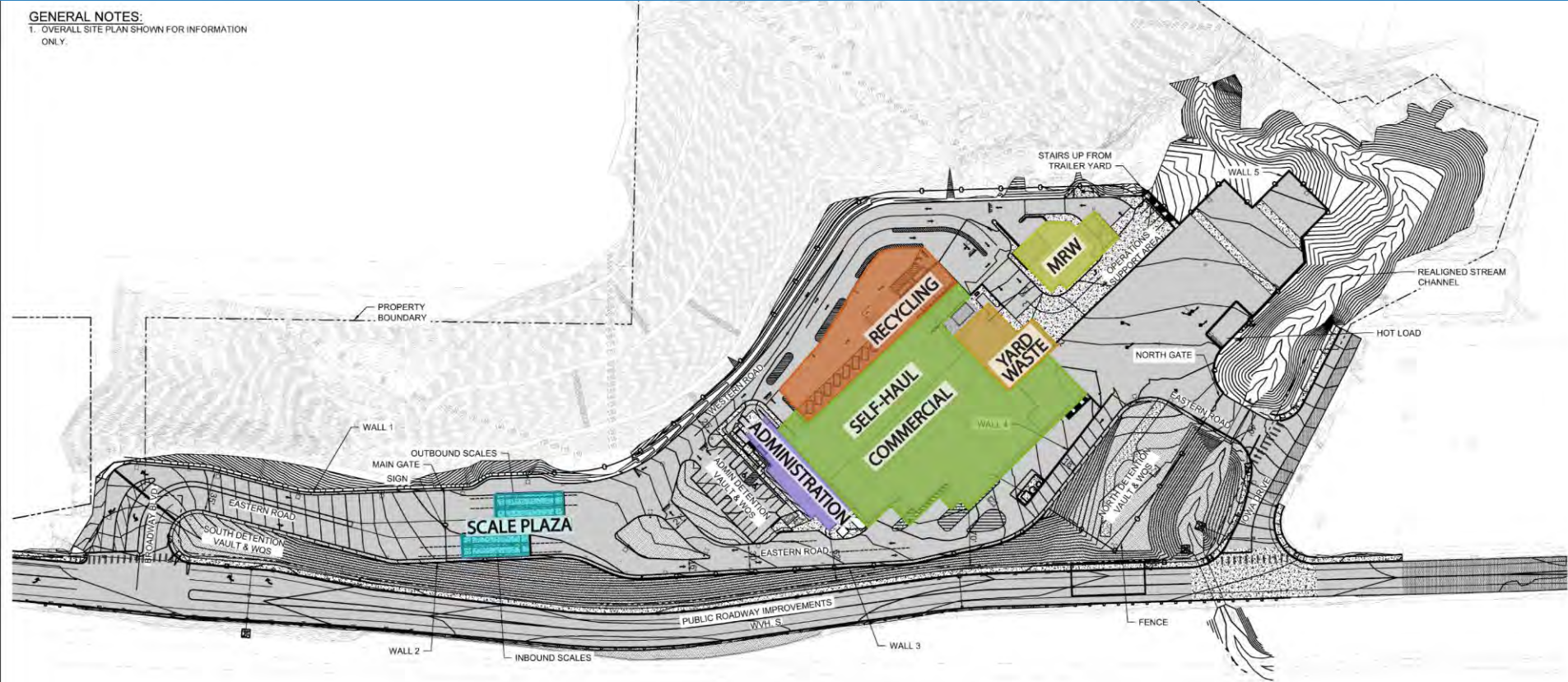



# 60% Overall Site Plan

## GENERAL NOTES:

1. OVERALL SITE PLAN SHOWN FOR INFORMATION ONLY.

- SELF-HAUL
- COMMERCIAL
- SWD TRANSFER TRAILERS

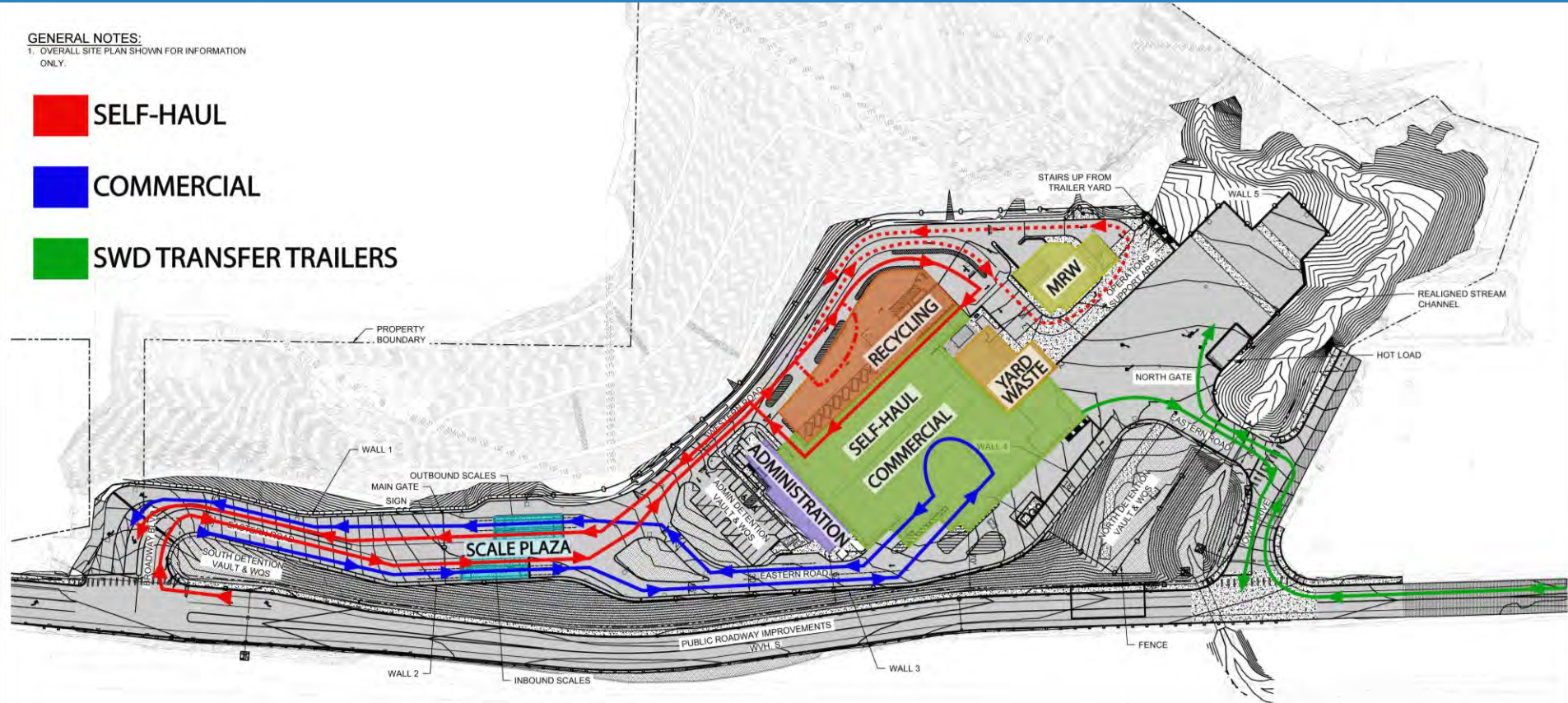



# Site Rendering Fly Through – Site





# Site Rendering Fly Through – Entrance





# Site Rendering Fly Through – Operations



# Site Rendering Fly Through – Drive-By





# Sustainability and Environmental Considerations

- Environmental protections
- Separating clean stormwater from sanitary flows
- Improved habitat
- Noise, odor, glare, surface, and water protections



**King County**

Department of  
Natural Resources and Parks  
**Solid Waste Division**

# Share Your Thoughts



Scan QR code, follow link, or go to  
[menti.com](https://www.menti.com) and enter the code  
1893 4623



**King County**

Department of  
Natural Resources and Parks  
**Solid Waste Division**

# 60% Overall Site Plan

## GENERAL NOTES:

1. OVERALL SITE PLAN SHOWN FOR INFORMATION ONLY.





# Public Recycle Drop-off



RECYCLE DROP-OFF

PAPER

CARDBOARD

PLASTIC

GLASS

METAL

CONTAINERS

STOP



**Multipurpose Room**





View of the outdoor receiving area, or patio



**King County**

Department of  
Natural Resources and Parks  
Solid Waste Division



View from  
the lobby  
to the  
outdoor  
receiving  
area, or  
patio



**King County**

Department of  
Natural Resources and Parks  
**Solid Waste Division**



View from  
the lobby to  
the  
multipurpose  
room



**King County**

Department of  
Natural Resources and Parks  
**Solid Waste Division**



# SOUTH COUNTY TRANSFER & RECYCLING STATION

VIRTUAL OPEN HOUSE  
PUBLIC ART UPDATE

AUGUST 25, 2021

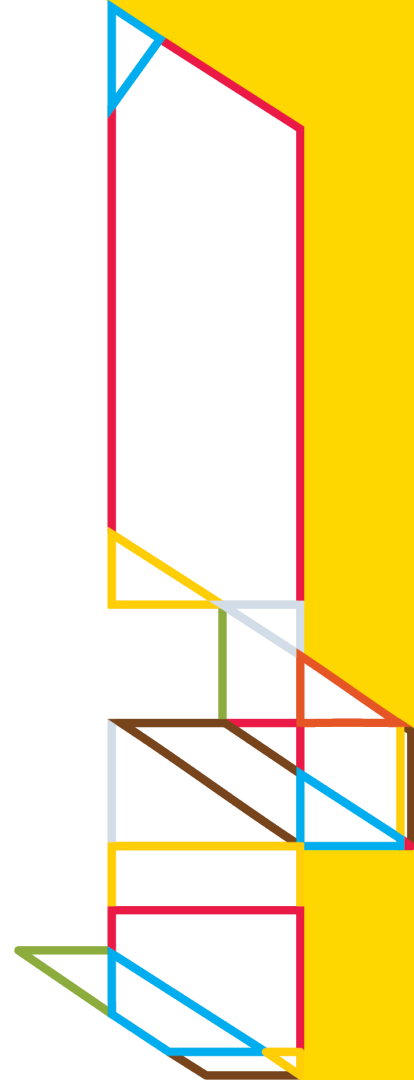





# PUBLIC ART PROCESS – PART ONE

## PHASE 1: PLANNING

- MEET WITH THE SWD TO REVIEW PROJECT GOALS.
- VISIT THE PROJECT SITE AND SURROUNDS.
- MEET WITH ADVISORY OR COMMUNITY GROUPS RELATED TO THE PROJECT.
- SHARE PUBLIC ART EXAMPLES TO PRESENT POSSIBILITIES AND ARTICULATE ASPIRATIONS FOR THE PROJECT AND ITS ARTWORK.
- DEVELOP A SCOPE OF WORK, INCLUDING A BUDGET, TIMELINE, AND ARTIST SELECTION PROCESS.
- DEVELOP A PANELIST ROSTER.
- PRESENT THE SCOPE OF WORK AND PANELIST ROSTER TO THE 4CULTURE PUBLIC ART ADVISORY COMMITTEE (PAAC) FOR APPROVAL.

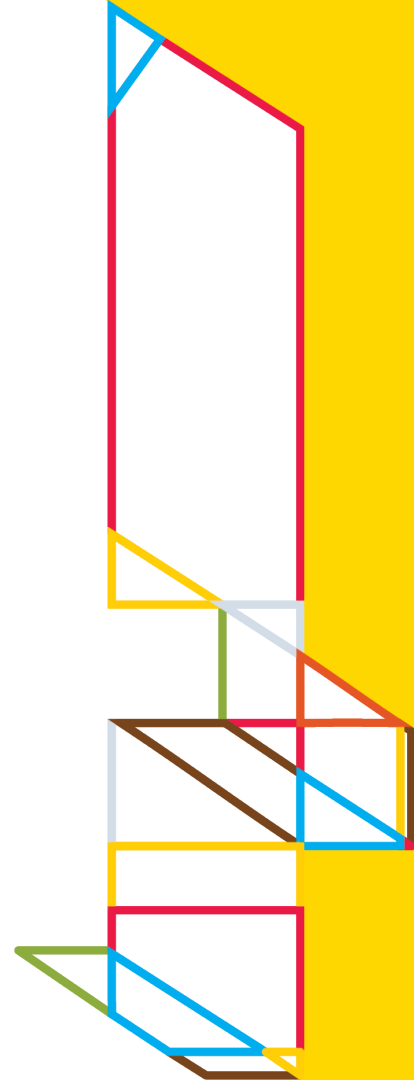





# PUBLIC ART PROCESS – PART ONE

## PHASE 2: ARTIST SELECTION

- DEVELOP PROJECT SPECIFICS AND INFORMATION PACKET FOR THE PUBLIC ART OPPORTUNITY AND REVIEW WITH CLIENT.
- SOLICIT ARTIST APPLICATIONS THROUGH AN OPEN CALL: 4CULTURE PUBLISHES AN RFQ, WITH SPECIFIC ELIGIBILITY REQUIREMENTS.
- FACILITATE A PANEL REVIEW PROCESS TO SELECT ARTIST(S) FOR THE PROJECT (PANEL COMPRISED OF 3 ARTISTS, 1 SWD REPRESENTATIVE & 1 COMMUNITY MEMBER)
- DEVELOP COMMUNICATIONS MATERIALS TO ANNOUNCE SELECTION OF ARTIST(S).

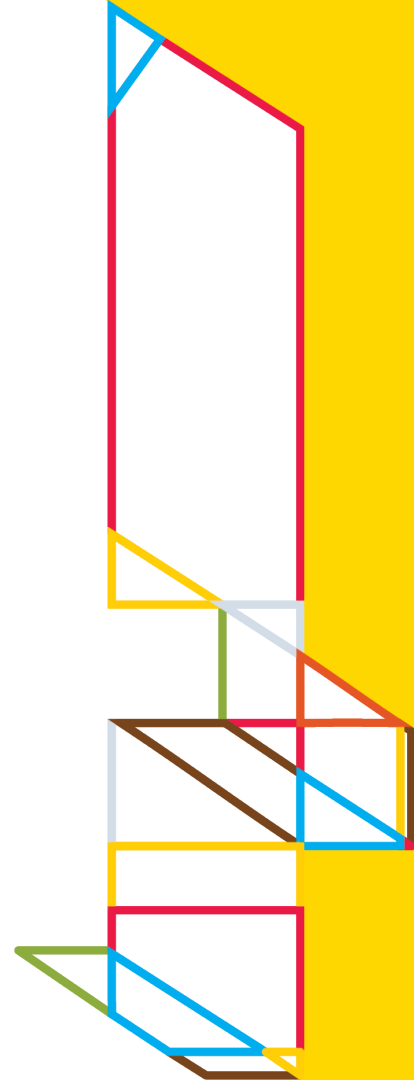



# TWO PUBLIC ART PROJECT FOR SCRTS

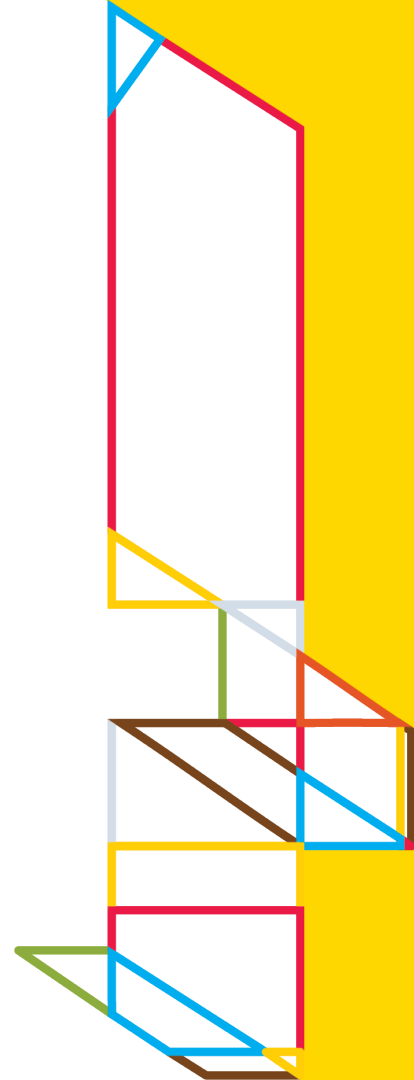

**PROJECT #1:  
SITE-BASED, SITE-INTEGRATED PERMANENT  
ARTWORK OPPORTUNITY**

SELECTED TEAM: MUCKLESHOOT INDIAN TRIBE



*Federation Forest Welcome Figures, 2018. Cedar.*



*MIT Casino Art Piece #1, 2017. Glass.*



*Traditional Figure, 2018. Yellow Cedar.*



*Seattle Seahawks - Northgate Plaza Art Piece, 2021. Steel.*



*Story Pole*, 2020. Cedar.



*Canoe Paddlers* (James Madison), 2008. Metal sculpture. Muckleshoot Library, Auburn.  
Courtesy King County Library System.









**PROJECT #2:  
SITE-BASED GENERATIVE ARTIST RESIDENCY**

SELECTED ARTIST: EVAN BLACKWELL



*Sawtooth*, 2014. Steel, wood, mirror.



*Life Cycle*, 2007. Latex, rubber, air pumps, ammo boxes & timers.

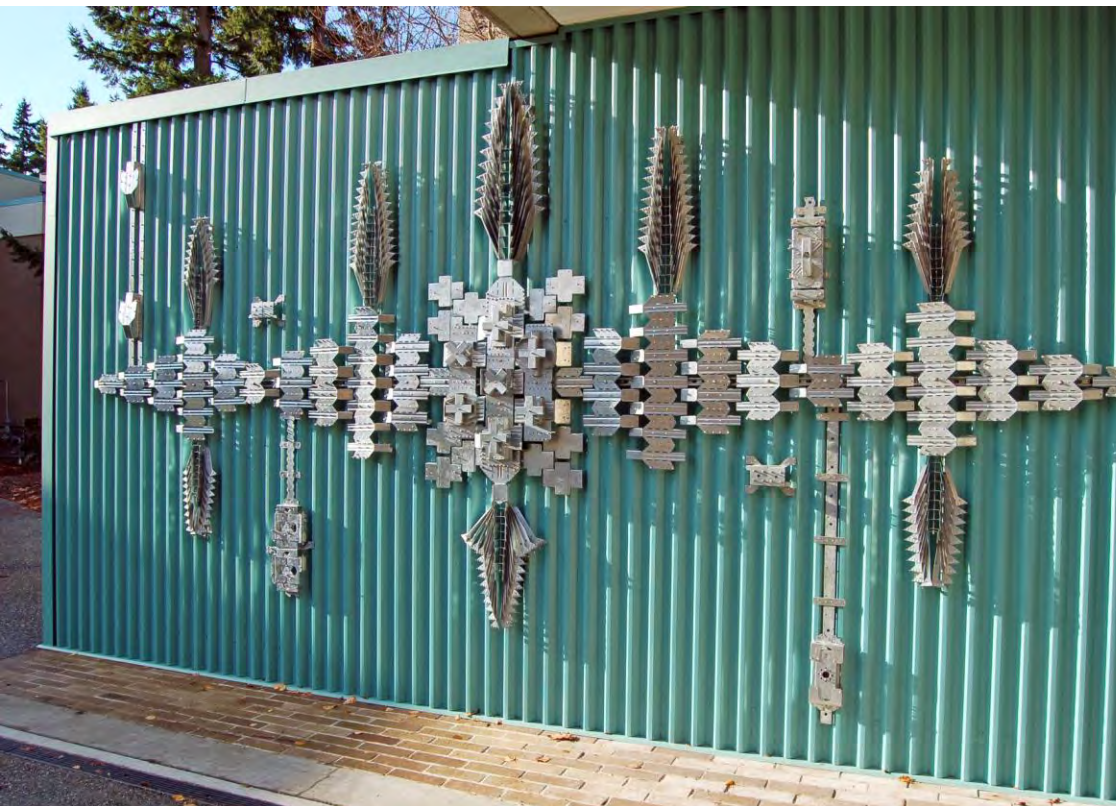

*Metropolis*, 2011. Galvanized and stainless steel.  
Edmonds Community College.



*ReCreation*, 2006. Plastic (salvaged from lawn chairs).





*Relics of Experience*, 2015. Ceramic, wood and hardware.  
MadArt/University of Washington Campus.



*Frame-work*, 2014. Wood.



# PUBLIC ART PROCESS – PART TWO

## PHASE 3: DESIGN

- EXECUTE DESIGN SERVICES CONTRACT AND SCOPE OF WORK.
- OVERSEE DESIGN DEVELOPMENT AND APPROVAL:
  - CLIENT RESONANCE
  - PAAC DESIGN REVIEW
- OVERSEE INTEGRATION OF ART DESIGN INTO CONSTRUCTION DOCUMENTS AND NEGOTIATE FABRICATION AND INSTALLATION ROLES.

## PHASE 4: IMPLEMENTATION

- EXECUTE IMPLEMENTATION SERVICES CONTRACT AND SCOPE OF WORK.
- OVERSEE FABRICATION OF ARTWORK.
- OVERSEE ON-SITE INSTALLATION OF ARTWORK.
- DEVELOP ARTWORK MAINTENANCE PLAN WITH ARTIST AND REVIEW WITH CLIENT.
- DEVELOP COMMUNICATIONS MATERIALS FOR THE ARTWORK.

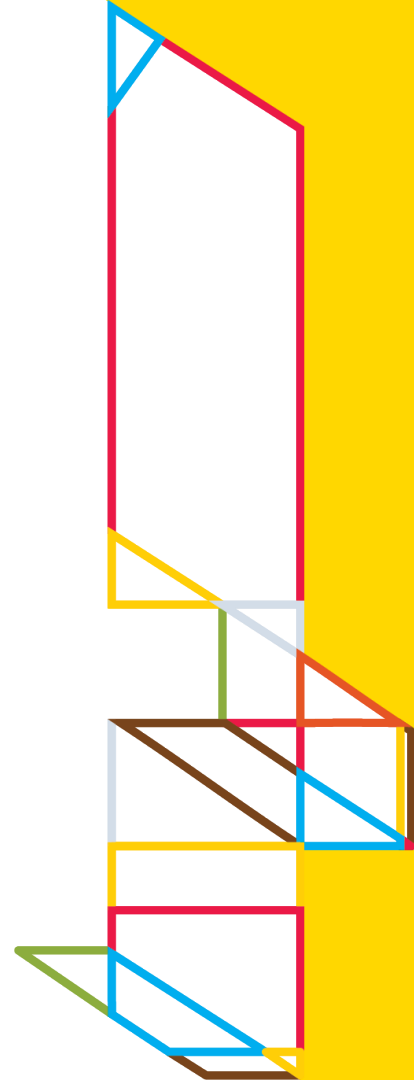





ADVANCING COMMUNITY THROUGH CULTURE



LAURA ELIZABETH BECKER  
SENIOR PUBLIC ART PROJECT MANAGER

LAURA.BECKER@4CULTURE.ORG  
(206) 263-1617



ARTS HERITAGE PRESERVATION PUBLIC ART

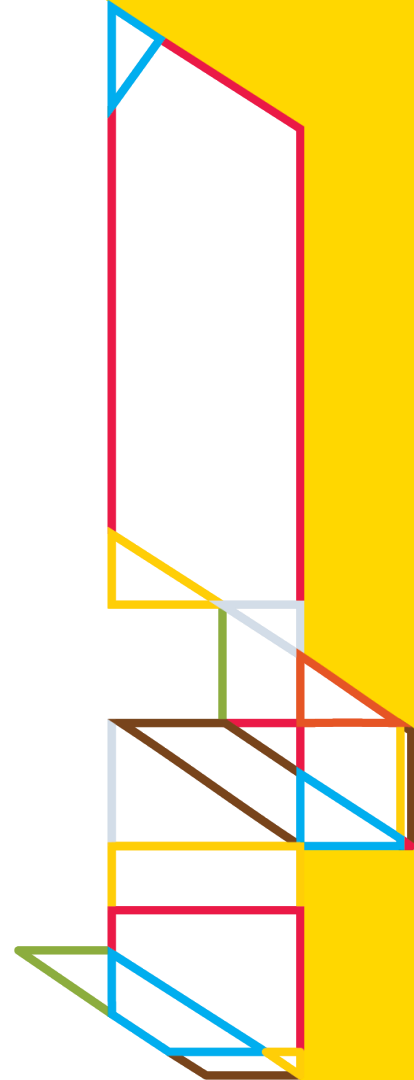

# Equity and Social Justice – Actions



Partner with the Local Food Initiative and Public Health-Seattle & King County to support farming in south King County



Work with a local non-profit to fund and implement green apprenticeship opportunities in the SCRTS service area

# Equity and Social Justice – Actions



Add educational, interactive exhibits at the new station with focus on environmental topics

Partner with the King County Parks to add amenities to segments of the Interurban Trail



# Next Steps

- Gather public input
- Reach 90% design milestone
- Construction of new facility begins in 2023
- New station opens to public in mid-2025



**King County**

Department of  
Natural Resources and Parks  
**Solid Waste Division**



# Stay involved!

- Join the Design Advisory Group
- **Subscribe** to project email updates via the project website: [www.kingcounty.gov/south-county](http://www.kingcounty.gov/south-county)
- **Follow** KC Solid Waste Division on social media:
  - Facebook: @KingCountySolidWaste
  - YouTube: @KingCountyRecycling
  - Instagram: @KingCountySWD

# Q & A



**King County**

Department of  
Natural Resources and Parks  
**Solid Waste Division**



## King County

Department of  
Natural Resources and Parks  
**Solid Waste Division**

*Waste*  
**Prevention**

*Resource*  
**Recovery**

*Waste*  
**Disposal**

King Street Center  
201 South Jackson Street, Suite 5701  
Seattle, WA 98104-3855  
206-477-4466, TTY Relay: 711  
[kingcounty.gov/solid-waste](http://kingcounty.gov/solid-waste)



### King County

Department of  
Natural Resources and Parks  
**Solid Waste Division**