

King County

Contractor Outreach and Networking Event



King County

Muckleshoot Events Center

Auburn, WA

April 15, 2026

9:00AM – 3:00 PM

Contents

Agenda:3

Event Layout Map4

Booth Guide:5

Prime Contractor/Consultant Exhibitor Guide:8

 Architecture, Engineering, and Professional Services Firms8

 General Contractors 11

 Resources Row 15

King County Project Descriptions: 17

 Harborview Construction and Infrastructure Division 17

 Parks Capital Improvement Program (CIP)..... 17

 Metro 19

 Road Services Division 20

 Solid Waste Division..... 20

 Water and Land Resources Division, Capital Delivery Section 20

 Wastewater Treatment Division 21

 FMD 23

 King County Airport 23

One-on-One Prime Contractor Networking Meetings..... 24

Education Sessions 25

 Session 1 Small Firms: Certifications and Next Steps 25

 Session 2 How Primes Connect with Subcontractors 25

Venue Information: 26

 Directions:..... 26

 Parking: 27

 Muckleshoot Casino Map: 28

Agenda:

| Time & Location | Event Description |
|---|--|
| 8:00am Foyer | Attendee Check-in begins |
| 8:00am Prairie Room | Open-seating and refreshments <i>Assorted pastries, fruit display, & coffee</i> |
| 9:00am – 9:30am White River Room | Welcome/Opening Remarks: Lydia Reynolds-Jones, Lydia Reynolds, Strategic Business Operations Section Manager, <i>Department of Local Services, Road Services Division</i> Keynote Speaker: Sandy Hanks, Strategic Planning Manager, <i>Department of Executive Services, Finance and Business Operations Division</i> |
| 9:30am – 3:00pm Medicine Creek Room | Exhibition Hall Networking Primes - AEPs and General Contractors Resources Row |
| 9:45am – 2:00pm White River Room | King County Capital Programs Presentations: 9:45am – Welcome and introduction 10:00am – Harborview Program 10:30am – Parks 11:00am – Metro 11:40am – Road Services 12:00pm – 1:00pm – Lunch Break 1:00pm – Solid Waste Division 1:30pm – Water and Land Resources 2:00pm – Wastewater Treatment Division |
| 10:00am – 12:00pm Green River Room | 1:1 Prime Contractor Networking Meetings: Group 1 - General Contractors |
| 10:00am – 12:00pm Plateau Room | Educational Session #1 <i>Small Firms: Certifications and Next Steps</i> |
| 12:00pm – 1:00pm Prairie Room | Lunch Break <i>Light Appetizers Served:</i> <ul style="list-style-type: none"> • <i>Bruschetta Caprese</i> • <i>Veggie Summer Roll</i> • <i>BLTA Slider</i> • <i>Warm Beef Satay</i> |
| 1:00pm – 3:00pm Green River Room | 1:1 Prime Contractor Networking Meetings: Group 2 - Architecture, Engineering, and Professional Services |
| 1:00pm – 3:00pm Plateau Room | Educational Session #2 <i>How Primes Connect with Subcontractors</i> |
| 3:00pm | Event Concludes |

Event Layout Map

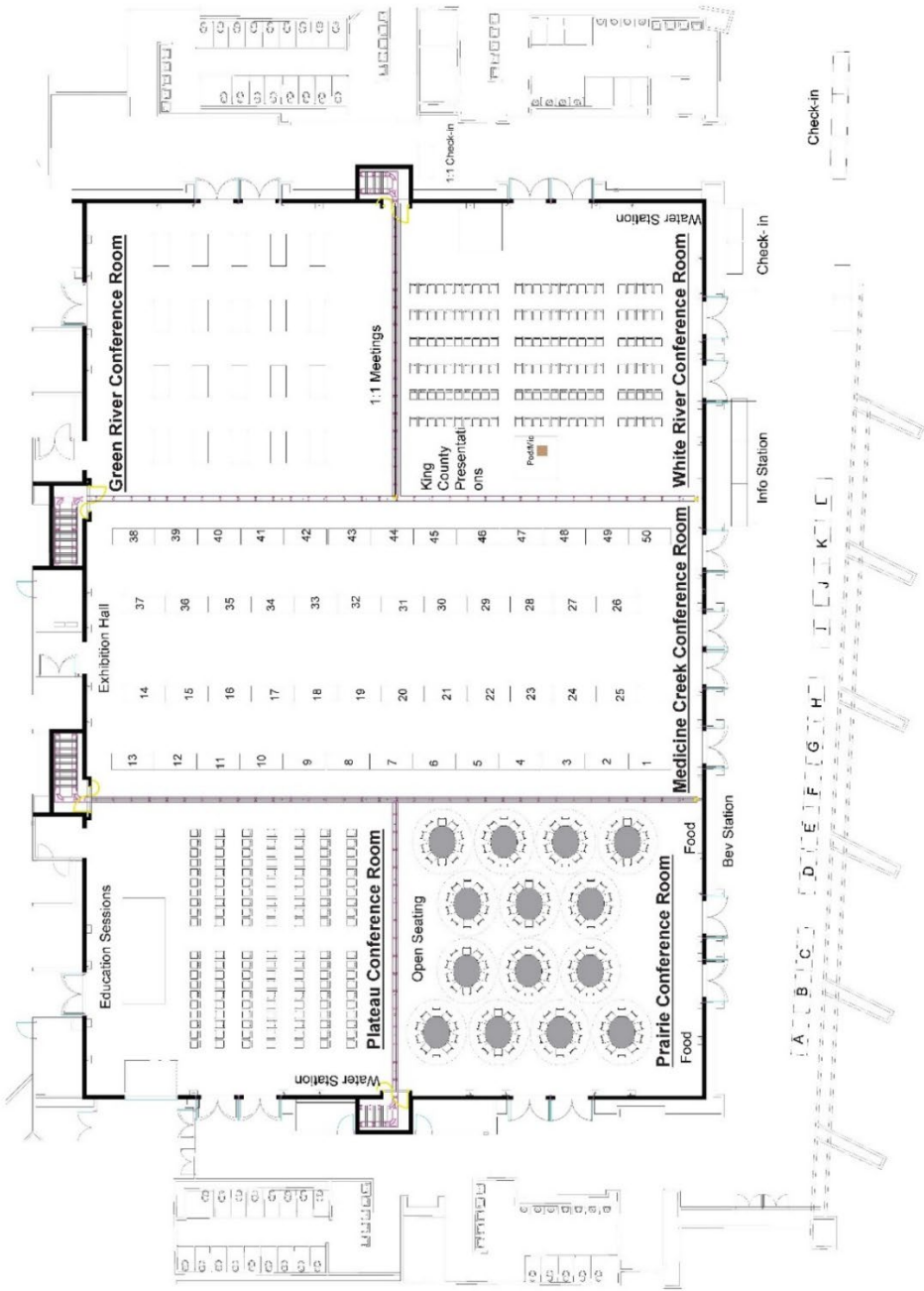

Booth Guide:

The Exhibition Hall opens at 9:30am upon the conclusion of the Keynote address.

Exhibition Hall

Medicine Creek Conference Room

| Name | Table Number | Location |
|--|--------------|-----------------|
| Absher Construction | 19 | Exhibition Hall |
| Accenture Infrastructure and Capital Projects | 1 | Exhibition Hall |
| AECOM | 2 | Exhibition Hall |
| Andersen Construction | 20 | Exhibition Hall |
| ANEW (Registered apprenticeship preparatory program) | 45 | Exhibition Hall |
| Association of General Contractors (AGC) | 42 | Exhibition Hall |
| Bayley Construction LP | 21 | Exhibition Hall |
| BDCC | L | Foyer |
| BNBuilders | 22 | Exhibition Hall |
| Brown and Caldwell | 3 | Exhibition Hall |
| BuildUp | 41 | Exhibition Hall |
| Carollo Engineers, Inc. | 4 | Exhibition Hall |
| Climate Equity and Workforce / JumpStart | J | Foyer |
| David Evans and Associates, Inc. | 5 | Exhibition Hall |
| DES - Harborview | 33 | Exhibition Hall |
| DLS - Roads | G | Foyer |
| DNRP - Parks | D | Foyer |
| DNRP - SWD | E | Foyer |
| DNRP - WLRD | F | Foyer |
| DNRP - WTD 1 | A | Foyer |
| DNRP - WTD 2 | B | Foyer |
| EC Electric | 37 | Exhibition Hall |
| Flatiron Dragados Constructors, Inc. | 23 | Exhibition Hall |
| FMD | I | Foyer |

| | | |
|--|----|-----------------|
| Geosyntec Consultants, Inc. | 6 | Exhibition Hall |
| GLY Construction | 24 | Exhibition Hall |
| Goodfellow Bros., LLC | 25 | Exhibition Hall |
| Hazen and Sawyer | 7 | Exhibition Hall |
| HDR Engineering | 8 | Exhibition Hall |
| Hensel Phelps | 26 | Exhibition Hall |
| Hill International | 38 | Exhibition Hall |
| Hoffman Construction | 27 | Exhibition Hall |
| J Lawrence Industries | 28 | Exhibition Hall |
| J.W. Fowler | 29 | Exhibition Hall |
| Jacobs Engineering Group Inc. | 9 | Exhibition Hall |
| KBA, Inc. | 10 | Exhibition Hall |
| Kennedy Jenks | 11 | Exhibition Hall |
| Kiewit Infrastructure West Co. | 30 | Exhibition Hall |
| Mass Electric | 39 | Exhibition Hall |
| Metro | H | Foyer |
| Michel's Corporation | 31 | Exhibition Hall |
| Mortenson | 32 | Exhibition Hall |
| National Association of Minority Contractors (NAMC) - Washington Chapter | 43 | Exhibition Hall |
| Northwest Minority Builders Alliance (NW MBA) | 48 | Exhibition Hall |
| Northwest Mountain Minority Supplier Development Council | 46 | Exhibition Hall |
| NWLETT - Laborers Local 242 | 44 | Exhibition Hall |
| Parametrix | 12 | Exhibition Hall |
| PCL Construction | 34 | Exhibition Hall |
| Procurement and Payables | K | Foyer |
| Quality Controls Corporation | 36 | Exhibition Hall |
| Rolluda Architects, LLC | 13 | Exhibition Hall |
| Skanska USA Building | 35 | Exhibition Hall |
| Stantec | 14 | Exhibition Hall |
| T.Y. Lin International | 15 | Exhibition Hall |
| Tabor 100 | 50 | Exhibition Hall |

| | | |
|--|----|-----------------|
| Tetra Tech | 16 | Exhibition Hall |
| The Athena Group, LLC | 17 | Exhibition Hall |
| TKDA | 18 | Exhibition Hall |
| Washington Office of Minority & Women's Business Enterprises (OMWBE) | 49 | Exhibition Hall |
| Water Collaborative Delivery Association | 47 | Exhibition Hall |
| WSU Energy Program - WAZIP | 40 | Exhibition Hall |
| WTD Recruiting | C | Foyer |

Prime Contractor/Consultant Exhibitor Guide:

Architecture, Engineering, and Professional Services Firms

| Prime Consultant Name | Table | Looking for Firms that provide the following services: |
|---|-------|---|
| Accenture Infrastructure and Capital Projects | 1 | Program & Project Management, Construction Inspection, Material Testing, Project Controls, Environmental Engineering, Risk Management, Estimating, Scheduling |
| AECOM | 2 | <p>AECOM is a global infrastructure consulting firm delivering professional services across the full project lifecycle—from advisory and planning through design, permitting, engineering, program management, and construction management. Our business lines span transportation, buildings, water, energy, and the environment, supported by a deep multidisciplinary bench with both local and global engineering expertise. As a strong prime consultant, AECOM delivers comprehensive, integrated solutions and can effectively support and augment smaller specialized firms on complex projects, particularly those requiring innovative approaches to address thorny public-infrastructure challenges.</p> <p>Services include:</p> <ul style="list-style-type: none"> • Hydrologic and hydraulic modeling • Floodplain permitting and policy support • Levee services • Fish passage planning and design • River and floodplain restoration • Surface / Roadways • Bridges & Structures • Intelligent Transportation Systems • Rail / Transit • NEPA Planning • Aviation • Electrical Engineering • Architecture • Mechanical Engineering • Landscape Architecture • Urban Design • Water/Wastewater Treatment - Planning and Design |
| Brown and Caldwell | 3 | Program management, project controls, all engineering disciplines and related technical specialties, construction management, outreach and public engagement, permitting, property, cost estimating. |
| Carollo Engineers, Inc. | 4 | <ul style="list-style-type: none"> • Surveying and mapping • Geotechnical engineering and construction materials testing • Condition assessment and coatings/corrosion evaluation |

| | | | |
|--|-----------|--|--|
| | | <ul style="list-style-type: none"> • Landscape architecture • Right-of-way acquisition and appraisal services • Architectural services • Structural engineering • Mechanical, electrical, and plumbing (MEP) engineering • Instrumentation and control (I&C) • Environmental consulting and compliance • Civil engineering (including site/civil, utility, and stormwater) • Construction management, inspection, and observation | <ul style="list-style-type: none"> • Security planning and validation for water utilities • Public outreach, stakeholder engagement, and community relations • Permitting support • Flow monitoring and inflow/infiltration (I/I) analysis • Cathodic protection • CEQA and environmental review • Facility operations support • BIM modeling and 3D laser scanning • Cost estimating |
| David Evans and Associates, Inc. | 5 | Construction management and inspection services | |
| Geosyntec Consultants, Inc, (On behalf of the Lower Duwamish Waterway Sediment Cleanup Team) | 6 | Marine construction inspection, water quality monitoring inspection, vessel operators, dredging inspection, occupational safety, WA certified industrial hygienist, air/noise/light monitoring inspector, technical drafting (civil CADD software knowledge), change and risk management, schedule development (Primavera 6 software knowledge). | |
| Hazen and Sawyer | 7 | We are interested in meeting and learning about the full depth of potential project partners that are in the engineering consulting community (we're still 'relatively' new to the market). | |
| HDR Engineering | 8 | <ul style="list-style-type: none"> • Engineering services • Environmental permitting • Real estate/property • Community outreach/engagement | |
| Hill International | 38 | Prime PM/CM Firm | |
| KBA, Inc. | 10 | KBA provides Construction Management services for all types of public works projects. We look to partner with design primes and specialty subconsultants on both horizontal and vertical projects. | |
| Kennedy Jenks | 11 | Engineering disciplines, project controls, program management, construction management | |
| Jacobs Engineering Group Inc. | 9 | <ul style="list-style-type: none"> • Civil Engineering • Geotechnical Engineering • Environmental Engineering • Hydraulics and Hydrology Modeling • Surveying | |

| | | |
|-------------------------|-----------|---|
| | | <ul style="list-style-type: none"> • Permitting • Landscape Architecture • Cost Estimation • Scheduling • Communications and Public Outreach • Cultural Resources • Diversity, Equity and Inclusion Specialists • Solid Waste Facility Planning, Design and Operations |
| Parametrix | 12 | <p>Parametrix is soliciting teaming partners that can complement its multidisciplinary work across transportation, water, environmental planning and compliance, advisory services, and community building. We are looking to partner with specialized subconsultants that bring technical depth and on-the-ground capabilities to support planning, design, and delivery of complex public infrastructure projects throughout Washington and the broader Pacific Northwest.</p> <p>Desired partners include firms with expertise in areas such as:</p> <ul style="list-style-type: none"> • public outreach and engagement • permitting • property acquisition • cost estimating, scheduling • constructability • utility coordination • traffic control • air and noise analysis • wide range of engineering disciplines <ul style="list-style-type: none"> ○ geotechnical ○ stormwater ○ electrical ○ mechanical ○ civil ○ structural <p>Across service lines, Parametrix is also actively seeking partners that provide environmental and advisory-focused services, including:</p> <ul style="list-style-type: none"> • hazmat and environmental sampling • cultural resources • arborist services • drilling and geotechnical support • economic and risk analyses • program and project controls • owner advisory and construction management services • workforce development <p>Overall, the outreach highlights a desire to build long-term, flexible partnerships with firms that can scale with upcoming on-call contracts and major capital programs for cities, counties, transit agencies, ports, and utilities.</p> |
| Rolluda Architects, LLC | 13 | <p>We provide architecture, planning, and interior design services to both private- and public-sector clients. The firm specializes in the design of educational, cultural, community, transportation, aerospace, municipal</p> |

| | | |
|------------------------|----|---|
| | | and government, industrial, multi-family housing, and mixed-use projects. Architectural Services - we prime several projects with King County in the SWD and FMD space. |
| Stantec | 14 | We are interested in talking to architectural, engineering, and consulting firms that specialize in such fields as electrical engineering, landscape architecture, tree inventories, geotechnical engineering, building architecture, air quality monitoring, habitat restoration, BIM/CAD, and other disciplines. |
| Tetra Tech | 16 | Consulting, Engineering, Program Management, and Construction Management for Water & Wastewater, Environment, and Infrastructure Design, providing services such as Civil Engineering, Cultural Resources, Survey, Fisheries Biology, Geotechnical, Public Outreach, and Landscape Architecture. |
| The Athena Group, LLC | 17 | Coaching and Training & Capacity Building, Organizational Planning, Analysis and Improvement, Change and Project Management, Research/Evaluations/Studies, Community Engagement. |
| TKDA | 18 | Seeking partners and services related to facilities and transportation projects including architecture, survey, civil, electrical, mechanical, and structural engineering design services. We are also interested in connecting with firms that deliver project management/controls and construction management services, along with contractors that pursue general contractor/construction management (GC/CM) and design-build/progressive design-build (DB/PDB) contracts. |
| T.Y. Lin International | 15 | <ul style="list-style-type: none"> • Transportation • Water & Wastewater • Alternative Delivery • Buildings • Advisory & Planning • PM/CM |

General Contractors

| Prime Contractor Name | Table | Looking for Firms that provide the following services: |
|-----------------------|-------|---|
| Absher Construction | 19 | We are currently seeking experienced and reliable contractors to join our team on upcoming projects. Absher Construction is committed to building strong partnerships that foster growth, quality, and long-term success. We have opportunities for certified small businesses such as: MBE, WBE, WOSB, VOSB, SDVOSB, SDB, DBE, SBE, PWSBE, Veteran and HUBZone firms |
| Andersen Construction | 20 | Healthcare, Multi-Family Housing, K-12, Higher Ed. Energy, Hospitality and Gaming. |

| | | |
|--------------------------------------|-----------|--|
| Bayley Construction LP | 21 | Subcontractors and suppliers who work within NAICS 236220 Commercial and Institutional Building Construction Small and Minority owned subcontractors and suppliers, OMWBE certified, and non-certified. |
| BNBuilders | 22 | Commercial, non-residential construction. Finishes, MEP, Abatement, Earthwork, Utilities Irrigation and Landscape, and more. |
| EC Electric | 37 | We are a large union electrical contractor specializing in all aspects of electrical construction. Electrical maintenance, to high voltage infrastructure, we perform all major aspects of electrical construction. |
| Flatiron Dragados Constructors, Inc. | 23 | Electrical, Plumbing (Sewage and Drainage Systems,) Dewatering, Mining, Tunneling, Earthwork/Excavation, Erosion Control, Fencing, Guardrails, Landscaping, HVAC, Utilities, Ironworking, Sawcutting and Joint Seal, Demolition, Concrete/Asphalt Paving, Concrete Flatwork/Formwork, Environmental Services, Surveyors, Quality Control, Engineers, and more! |
| GLY Construction | 24 | We are a General Prime Contractor that specializes in both public and private projects. We currently hold JOC Contracts with multiple agencies. We also work with tech clients in the King County area. |
| Goodfellow Bros., LLC | 25 | <p>Goodfellow Bros is looking for subcontractors to partner on the following scopes of work: Erosion control, traffic control, clearing and grading, dewatering, utility installation, retaining walls, trucking, electrical, structural and flatwork concrete, paving, striping, guardrail, and signing. We are also looking for suppliers in piping, aggregates, and erosion/geotextile products.</p> <p>Please speak with us about your capabilities and capacities. We strive to work with our partners to shape and size subcontract packages that encourage participation on our projects.</p> |
| Hensel Phelps | 26 | Masonry, Structural Steel, Waterproofing, Millwork, Insulation, Demolition, Final Cleaning, Concrete, Roofing, Metal Panels, Fireproofing, Joint Sealants, Expansion Joints, Doors, Frames, and Hardware, Glass & Glazing, Drywall & Related, Window Treatment, Furniture and Seating, Fire Protection, HVAC, Fencing, Earthwork & Clearing, Landscaping & Irrigation, Asphalt Paving, Site Utilities, Specialty Foundations. |
| Hoffman Construction | 27 | All construction companies |
| J Lawrence Industries | 28 | <ul style="list-style-type: none"> • Contract Manufacturing • Design Build Services • Reverse Engineering |
| J.W. Fowler | 29 | <ul style="list-style-type: none"> • Paving • Trucking • Hoisting • Landscape • Electrical |

| | | |
|---------------------------------|-----------|---|
| | | <ul style="list-style-type: none"> • HVAC • Traffic Control • Structural Steel • Rebar • Survey • Material Testing |
| Kiewit Infrastructure West Co. | 30 | Subcontractors who specialize in Concrete Flatwork, Demolition, Environmental Construction, Electrical, Mechanical, Reinforcing Steel Installation, Sheet Metal, Steel Fabrication, Steel Erection, Surveying, Quality Control/Quality Assurance, Testing, Trucking, among others. Services such as Community Engagement/Communications, Environmental Engineering, Environmental Protection Supplies/Services, Construction Supplies, Safety Supplies, Traffic Control, and more. |
| Mass. Electric Construction Co. | 39 | <ul style="list-style-type: none"> • Electrical equipment (switchgear, MCCs, etc.) • Electrical bulk commodities • Lighting fixtures • Excavation and backfill of electrical ductbank • Generators • Electrical testing • Fire alarm devices and installation • Security system devices and installation • PV / solar panels • Lightning protection • Janitorial and trash removal • Mobile and trailer rental • Warehouse management • Employment and staffing services |
| Michels Corporation | 31 | <ul style="list-style-type: none"> • Aggregates • Asbestos Abatement • Asphalt Paving & Road Repair • Bus Welding • Civil Work • Clearing • Concrete Supplier • Concrete Testing • Concrete Work - Foundation • Conduit/Cable Supplier • Construction Supplies • Consumable Material Supplies • Curb & Gutter • Dewatering • Drain Tile • Dump Trucks • Dumpster Rental • Electrical Pump Station • Fencing • Fiber Optic Cable Blowing/Pulling • Fiber Splicing & Termination • Foundation Construction • Procurement • Fuel Supplier • Grubbing • Horizontal Directional Drilling • Hydroseeding • Hydrovac • Land Restoration • Matting • OPGW Splicing • Pavement Markings • Portable Toilets • Precast Concrete • Saw Cutting • Sheet Pile |

| | | |
|------------------------------|-----------|--|
| | | <ul style="list-style-type: none"> • Electrical Work • Environmental Services • Equipment Hauling • Equipment Rentals • Excavation <ul style="list-style-type: none"> • Shoring • Surveying • Traffic Control • Water Truck |
| Mortenson | 32 | All construction trades |
| PCL Construction | 34 | General Construction |
| Skanska USA Building | 35 | |
| Quality Controls Corporation | 36 | PLC Control Systems Design and programming, UL508A panel fabrication, VFD Services, SCADA and HMI development, OT Networking and Telemetry |

Resources Row

| Resources Row | Table | Services Provided: |
|--|--------------|---|
| ANEW [registered apprenticeship preparatory program] | 45 | ANEW has partnerships with over 17 apprenticeship programs in the Puget Sound region. In addition to the apprenticeship programs, we collaborate with public partners, other pre-apprenticeship programs, and employers |
| Association of General Contractors (AGC) | 42 | AGC of Washington is the leading professional association of contractors in the State of Washington, committed to enhancing the performance of all our members, advocating for their interests, and increasing the impact of commercial construction. |
| BuildUp | 41 | Wrap around support services for apprentices. |
| National Association of Minority Contractors (NAMC) - Washington Chapter | 43 | NAMC of WA was established to address the needs and concerns of minority contractors. While membership is open to people of all races and ethnic backgrounds, the organization's mandate, "Building Bridges - Crossing Barriers," focuses on construction industry concerns common to African Americans, Asian Americans, Hispanic Americans, and Native Americans. |
| Northwest Minority Builders Alliance (NWMBA) | 48 | NWMBA champions equitable public policies in Olympia to improve business climate and equal rights. They provide tailored training and technical assistance leveraging over 300 years of collective experience. This strategic approach helps small businesses secure contracts, manage growth, and create new jobs. |

| | | |
|--|-----------|--|
| Northwest Mountain Minority Supplier Development Council | 46 | The Northwest Mountain Minority Supplier Development Council (NWMMSDC) provides certification, business development, and access to contracting opportunities for Minority Business Enterprises (MBEs). We connect certified minority-owned businesses with corporate and public-sector partners, while offering training programs, executive education scholarships, networking opportunities, and supplier diversity advocacy throughout the Northwest Mountain region. |
| NWLETT - Laborers Local 242 | 44 | Serving the Greater Seattle area, we are committed to working on behalf of our members with the main goal of making the quality of life better for them and their families. Our members enjoy a family-supporting wage, health benefits and a pension. We work closely with contractors and other employers to help them with their efforts to be successful in the marketplace. Our members bring skill, training, and integrity to the workplace. |
| Tabor 100 | 50 | Free Technical Assistance |
| Washington Office of Minority and Women's Business Enterprises (OMWBE) | 49 | State and federal certifications, small business support services, and supplier diversity. |
| Water Collaborative Delivery Association | 47 | Membership organization that promotes best practices for the delivery of capital projects using collaborative delivery/alternative public works in the water/wastewater industry. |
| WSU Energy Program - WAZIP | 40 | Technical Assistance on transportation electrification (at no cost). |

King County Project Descriptions:

King County Project Presentations

White River Conference Room

Schedule:

9:45am – Welcome and introduction
10:00am – Harborview Program
10:30am – Parks
11:00am – Metro
11:40am – Road Services
12:00pm – 1:00pm – Lunch Break
1:00pm – Solid Waste Division
1:30pm – Water and Land Resources
2:00pm – Wastewater Treatment Division

Harborview Construction and Infrastructure Division

Bond Projects- \$1.74 billion in improvements. Construct new medical tower, renovate essential hospital services and King County spaces in older hospital spaces. Make long lasting infrastructure improvements in concert with other campus expansion projects

3T MRI Scanner- Specialized shielding, structural reinforcement, and specific utilities to handle a high-field, superconducting magnet.

New Pioneer Square Clinic (Relocation to Duncan Building)- Design and construction services, including architectural, electrical, and structural steel.

About: *The Harborview Construction and Infrastructure Division (HCID) is responsible for managing the \$1.7 billion Harborview Bond Program that will modernize the medical center and associated healthcare campuses, so it can continue to serve our region for generations to come.*

Parks Capital Improvement Program (CIP)

Parks- AE (Design)

CM Services Work Order- Construction Management for Parks Capital Projects. 2 contracts. \$3m in capacity each, 6-year duration. Scope includes Constructability, inspection, testing, scheduling, cost estimating. Primary focus on regional trail construction

KC Aquatics Center Design- Design Contract for Major Rehabilitation of Facility, Facility built for Goodwill Games in 1990 features: Olympic-sized competition pool, diving well (platform and springboard) , Recreational pool, Banquet hall. Building systems upgrades/replacement - pool operation; Water heating, circulation, filtration. conditioning and dehumidification, boiler replacement, HVAC and controls and data/communication

Eastrail Renton Extension- Regional Trail Multidisciplinary Design Team. Collaborative project between King County Parks and the City of Renton to develop a regional trail that both extends the existing trail and also enhances the adjacent Coulon Park. Scope: Complete conceptual design through final construction documents for a southern extension of the Eastrail to the main entry of Gene Coulon Park in Renton.

Parks - Construction

Soos Creek Trail Extension- Construction Contract to extend regional trail. 1/2-mile extension of trail. Scope includes boardwalk, walls, trail, two stormwater facilities (pipe and level spreaders), a signalized mid-block crossing, sidewalk and two new ADA ramps (on either side of the SE 192nd mid-block crossing. Anticipated duration – 12 months

Petrovitsky Splash Pad- Construction of splash pad in regional park. Scope: New concrete splash pad, water recirculation system, building retrofit for mechanical equipment and chemical storage, sidewalks and other associated site improvements. Anticipated duration – 4 months

Lakeland North Nature Park- Construction of new park near Federal Way. New 20-acre park. Grant funded, quick timeline. The scope includes play areas, hard and soft surface trails, parking lot, site lighting, prefabricated restroom and picnic shelter, landscape, stormwater, utilities, paving and ROW improvements. Anticipated duration – 12 months

Green River Trail North- Construction of Regional Trail Project. 1.5-mile trail that will close the gap between the 19-miles of existing GRT and Seattle's ped/bike system. A critical component is to convert 4,300 linear feet (about 0.8 miles) of vehicle drive lane to the trail surface. The project includes coordination and approvals with KC Roads, City of Tukwila, and WSDOT. Anticipated duration – 18 months

About Parks: Experience the best the Pacific Northwest has to offer in King County Parks!

Enjoy a picnic at your neighborhood park, explore regional trails that stretch from Puget Sound to the Cascade Mountains, go for a hike in the woods, play a game of soccer, or even learn how to swim at our aquatic center. King County Parks preserves and cares for outdoor spaces, providing places to connect with family, friends, and nature. With hundreds of parks, hundreds of miles of trails, and tens of thousands of acres of natural areas, there's something for everyone in Your Big Backyard.

Metro

Work Order Engineering and Related Services for North Access Base- Professional design and planning services to assess new Aurora Avenue site, define the building program and basis of design, evaluate code and permitting requirements, incorporate safety, sustainability, and equity goals, and develop preliminary design documents for converting the site into an Access administrative and maintenance facility coordinated with associated parking and site improvements. (\$2m - November 2026)

Rapid Ride R-Line Planning, Design, and Engineering Support-

- R- Line Rainier Avenue Mount Baker Downtown RapidRide from Mount Baker to downtown Seattle via Rainier Avenue.
- Plan and design passenger facilities, comfort station, roadway, trolley overhead catenary system (OCS), signal and intelligent transportation system (ITS) improvements which result in better transit speed and reliability, access to transit projects and necessary communication and technology efforts to support service.
- May also include outreach and marketing
- Size of procurement will vary from a few hundred thousand to several million, depending on how much of the scope is implemented by Seattle Department of Transportation. (\$0.2 - \$12m - June 2026)

Operational Capacity Growth Realignment Planning (South Annex Base)-

- The Operational Capacity Growth Realignment Plan (OCG Realignment Plan) is a consultant- led planning study focused on Metro facility and operational capacity
- The study responds to the cancellation or indefinite deferral of the South Annex Base (SAB) and will identify, evaluate, and prioritize near-term and long-term facility and operational capacity solutions for King County Metro Transit (Metro), including functions displaced by the SAB cancellation. (\$0.2 - \$12m - June 2026)

About Metro: *Our mission is to provide the best possible public transportation services and improve regional mobility and quality of life in King County.*

King County Metro has the most riders of any transit agency in the northwestern United States. Metro provides bus, on-demand, paratransit, vanpool and water taxi services, and operates the Seattle Streetcar, Sound Transit Link light rail and Sound Transit Express buses.

Metro is a three-time winner of Best Large Transit Agency in North America, as awarded by the American Public Transportation Association. Metro was also named the Most Equitable Agency in Tackling Climate Change by the Federal Transit Administration.

Road Services Division

SE Mud Mountain Road Fish Passage Improvement- Culvert Replacement (Bridge Project)

Project located southeast of Enumclaw near King County/Pierce County Boarder, existing culvert is a failing corrugated metal pipe with a 4 ft. diameter, during storm events inlet back up with water and causes soil erosion, existing culver is a complete barrier for fish passage. Project Scope: existing culvert to be replaced with greater than 10 ft bridge span, stream will need to be designed for steep slopes that allow for fish passage and preliminary geotechnical report and survey basemap prepared by King County.

Avondale Road NE and NE 144th Place- Culvert Replacement (Fish Passage) Fish Passage

Project: Replacing undersized 30" concrete culvert, designed by Tetra Tech, about 50' upstream is a large earth dam. Project Scope: 2027 Construction Project, replace undersized 30" CP with large Concrete Box Culvert, streambed design includes Meander bars, culvert to be skewed under the roadway and foundation is up to 25' below the roadway.

About: *The King County Road Services Division is responsible for all county-owned roads, bridges and related infrastructure in the unincorporated area of King County.*

As of January 1, 2019, Road Services is part of the King County Department of Local Services. The Department also includes the Permitting Division and the Community Service Areas Program. The department director reports to the King County Executive, who is the elected executive officer of county government.

The Metropolitan King County Council, the legislative branch of county government, adopts laws, sets policies and holds final approval over the budget.

Solid Waste Division

Projects to be announced.

About: *The King County Solid Waste Division (SWD) provides garbage transfer, disposal, and recycling services for approximately 1.9 million people. We serve all of King County, except the cities of Seattle and Milton. Our work is guided by King County's 2019 Comprehensive Solid Waste Management Plan, which enables us to manage waste locally at the lowest cost and with the least environmental impact.*

Water and Land Resources Division, Capital Delivery Section

Power Miller River Floodplain Restoration- Remove damaged levee and roadway: To decrease future maintenance costs, to restore the connection between the river and its floodplain

and improve salmon habitat and construct new flood risk reduction infrastructure to avoid any significant increase in risk to private property and infrastructure (including BNSF rail line).

Mouth of Tuck Creek Fish Passage Project- Complete design and construct a replacement structure to: restore fish passage and adjacent habitat for salmon, maintain heavy truck access across the creek for agricultural operations and improve backwater flooding from the Snoqualmie River and drainage from Tuck Creek to the river.

NE Auburn Creek Restoration- Install a new culvert and flood gate to improve juvenile salmon access, excavate a new 725-foot channel to improve rearing and refuge habitat, relocate an existing farm access road to improve connection between the river and an existing floodplain wetland and widen and enhance the riparian buffer along the Green River.

White Center Ponds Retrofit- Excavate intermittently wet ponds and expand native vegetation to increase facility capacity, improve water quality, improve habitat function, decrease maintenance costs and install new pathways and lighting to improve public safety and enhance public use of the site.

Fort Dent Levee Repair- Repair existing levee to minimize future maintenance costs and reduce flood risk, remove invasive blackberry and plant native vegetation to improve riparian habitat, limit construction disruption to public use of the Green River Trail, Fort Dent Park, and Starfire Complex.

About: *The Water and Land Resources Division (WLRD) is a team of scientists, engineers, policy and data experts, ecologists, and project managers. Through our research and services, we:*

- *protect water quality and resources*
- *conserve land and protect and restore habitat*
- *protect public health and safety*

The work of the WLRD team yields significant environmental benefits throughout King County.

Wastewater Treatment Division

South Treatment Plant Facility Program –

Odor Control- STP Chemical ORT System and Dewatering Carbon Scrubber Improvements, replace tower supply blower, extend carbon tower exhaust, and components.

Preliminary Treatment- replace barscreens, replace influent gates and actuator.

Electrical Improvements- replace transformers, switchgears, and motor control centers throughout ST,

Secondary Treatment- replace RAS piping and components, modify tank inlets and scum removal mechanisms and replace flow meter, valves, piping and associated component.

West Point Facility Program –

Weight Scale Replacement – The scales have reached the end of their lifecycle & this project will: replace both truck loading bay weight scales with concrete deck scales & a coating system, the project will be completed in phases, one for each scale, demolish existing truck scale system, install new load cells, wiring, C3 piping, new concrete scale deck, and associated commissioning

Digestion Capacity Expansion- Digested Solids Storage Tanks, digester gas System Upgrades, heating Loop Revisions, NG Conversion or Propane Relocation, convert Digester 4, 5, & 6 and cogeneration System Replacement

Brightwater Facility Program -

BOC Roof and HVAC Replacement & Solar System- Installation of ~92,000 SF of new roofing system, replacement of existing unit with new 70-ton rooftop AC for office spaces, installation of 665 kW DC roof-mounted solar system with associated electrical components and facility to remain continuously operational during construction, removal of abandoned ventilation system, replacement of HVAC unit serving BOC office spaces, installation of replacement roofing system, installation of photovoltaic system in the roof area and Plant Main Controls to remain operational.

Neuros NX- 300 Blower Replacement – Replacement of seven (7) existing turbo blowers in the West Blower Room, installation of new, more efficient blower units, integration with existing electrical systems and Distributed Control System (DCS), work performed while aeration system remains fully operational and no disruption to biological treatment processes at the Plant.

Space Heating – Heat Pump Installation- Separation of existing hot water system into two independent loops, installation of effluent-source water-to-water heat pump system, separation of Education Center from existing loop, addition of alternative heating system for Education Center spaces, construction must maintain continuous plant operations and no disruption to process heating (digesters).

Offsite Facility Program-

Lake Hills Boulevard Siphon Replacement Project- Rehabilitate or replace the Lake Hills Boulevard Siphon in Bellevue.

Lake Hills Pump Station Facility Replacement Project- The scope of this project is to repair or replace the existing Lakeland Hills Pump Station in Auburn, WA.

Combined Sewer Overflow (CSO) Facility Program-

East Ship Canal Combines Sewer Overflow- Control of the University and Montlake regulator station outfalls, evaluate measures to select best alternative for control, potentially build large volume (30 MG) storage facility and potentially other project elements like pump stations and drainage basin optimization.

***About WTD:** Our regional wastewater treatment system has a big job to do. Not only does it operate around the clock to sustain a healthy environment, this vital infrastructure supports economic development that enables our region to thrive.*

FMD

Projects to be announced.

***About:** The Facilities Management Division (FMD), part of the Department of Executive Services, oversees and maintains King County's real estate assets. The division is comprised of several sections and workgroups, supported by the FMD Director's Office and Human Resources.*

King County Airport

Projects to be announced.

***About:** King County International Airport-Boeing Field (FAA LID/IATA: BFI, ICAO: KBFI) is four miles south of downtown Seattle. It's one of the busiest non-hub airports in the nation.*

We serve small commercial passenger airlines, cargo carriers, private pilots, corporate jets, helicopters, and military aircraft. We're also home to various Boeing Company operations and the Museum of Flight. Our proximity to downtown lets us host celebrities, dignitaries, and sports teams on a regular basis.

One-on-One Prime Contractor Networking Meetings

Green River Conference Room

To sign up for a One-on-One meeting: Please visit their booth and sign up for an open time slot.

Be sure to note the time you signed up for and who it is with. We have supplied sheets at check-in to help you keep track.

One-on-One Check-In: About 10 minutes before your scheduled meeting time, please check-in at the table outside the Green River Conference Room. One of our volunteers will help you get to the right place.

These One-on-One meetings are only 10 minutes and are intended to be a quick introduction. Feel free to exchange information and set up additional time to meet either at the event or afterwards.

Please keep meetings within the 10-minute window so we can stay on schedule. Thank you!

Schedule:

| | |
|--|--|
| 10:00am – 12:00pm <i>Green River Room</i> | Group 1 - General Contractors |
| 1:00pm – 3:00pm <i>Green River Room</i> | Group 2 - Architecture, Engineering, and Professional Services |

Education Sessions

Plateau Conference Room

Education sessions will be facilitated by members of the Wastewater Treatment Division.

Session 1 Small Firms: Certifications and Next Steps

10:00AM – 12:00PM

Purpose: A lesson-learned discussion that will help answer questions about next steps after SCS certification and registering on the portal. We will discuss best practices for submitting responses to RFP and getting connected to Primes.

Panel members: Members from King County Business Development and Contract Compliance (BDCC), King County Procurement and Payables (P&P), and small subcontractors that have successfully navigated the process and connected to Primes (45 min)

Q&A from audience (30 min)

Session 2 How Primes Connect with Subcontractors

1:00PM – 3:00PM

Purpose: A lesson-learned discussion to help answer questions about how Primes connect with subcontractors, their outreach process, and what they look for. There will be additional opportunities to connect after the panel.

Panel members: Members from current King County Primes and Nicki Pozos from The Formation Lab - acting ESJ coordinator and subconsultant (45 min)

Q&A from audience (30 min)

Venue Information:

Muckleshoot Casino and Events Center

2402 Auburn Way South

Auburn, WA 98032

Directions:

| Coming from Seattle (North) | Coming from Tacoma (South) |
|---|---|
| <ul style="list-style-type: none">• Travel Southbound on I-5 and exit 142A to WA-18 E towards Auburn• From WA-18 take exit 164 E towards Enumclaw, turn left onto WA-164 E/Auburn Way S• Follow Auburn Way S for about two miles and turn left onto Dogwood St. SE. Muckleshoot will be on your left. | <ul style="list-style-type: none">• Travel northbound on I-5 and exit 142A to WA-18 E towards Auburn• From WA-18 take exit 164 E towards Enumclaw, turn left onto WA-164 E/Auburn Way S• Follow Auburn Way S for about two miles and turn left onto Dogwood St. SE. Muckleshoot will be on your left. |

Coming from Seattle (North)

- Travel Southbound on I-5 and exit 142A to WA-18 E towards Auburn
- From WA-18 take exit 164 E towards Enumclaw, turn left onto WA-164 E/Auburn Way S
- Follow Auburn Way S for about two miles and turn left onto Dogwood St. SE. Muckleshoot will be on your left.

Coming from Tacoma (South)

- Travel northbound on I-5 and exit 142A to WA-18 E towards Auburn
- From WA-18 take exit 164 E towards Enumclaw, turn left onto WA-164 E/Auburn Way S
- Follow Auburn Way S for about two miles and turn left onto Dogwood St. SE. Muckleshoot will be on your left.

Parking:

- Two free parking options are available at the Muckleshoot Casino and Event Center.
- Complimentary valet is available. Follow the signs in the parking lot. Once your car is with valet, enter through Door 2.
- The parking garage is located near Door 4. From any floor of the parking garage, take the elevator to the first floor and proceed through the lobby and casino to the Event Center.

Muckleshoot Casino Map:

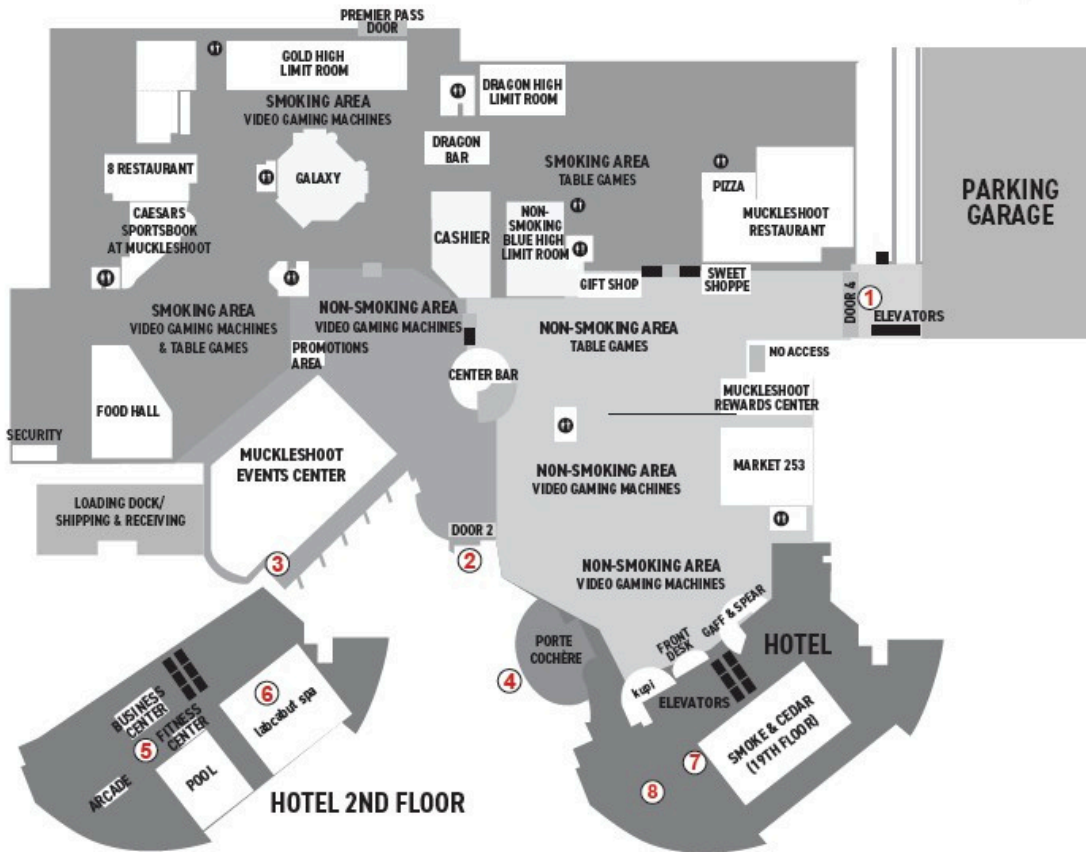

- ① **GARAGE ENTRANCE (DOOR 4)**
From any floor of the parking garage, take any elevator down to the first floor.
- ② **FRONT PARKING LOT ENTRANCE (DOOR 2)**
- ③ **EVENTS CENTER ENTRANCE**
Guests of all ages are encouraged to utilize these doors/ which lead directly to the event center.
- ④ **PORTE COCHÈRE/HOTEL ENTRANCE**
Utilized this entrance for valet parking or to access the hotel directly.
- ⑤ **LIFESTYLE (2ND FLOOR)**
Pool, Gym, Business Center, Arcade

- ⑥ **labcobot spa (2ND FLOOR)**
Indulge yourself with our world class spa.
- ⑦ **SMOKE & CEDAR (19TH FLOOR)**
Fine dining with breathtaking views from the 19th floor.
- ⑧ **TOWER BOARDROOM (M FLOOR)**
Book today to elevate your meetings.

For special access needs or requests, please contact Catering & Banquets at 253-804-4444.

Guests with questions or directional needs are encouraged to speak with our friendly security staff, stationed at any casino entrance.