



King County

Department of Natural Resources and Parks
Wastewater Treatment Division

NORTH MERCER ISLAND/ENATAI Sewer Upgrade Project

January 2024

Phase 1 detour starting on Southeast 35th Place as early as January 16

Pipe installation is progressing west up S.E. 35th Pl. towards East Mercer Way in four phases. Crews are moving into the Phase 1 detour as early as Tuesday, January 16. Phase 1 is expected to take approximately one month.

If you would like to receive direct emails about the detours, email us at [NMEsewer@kingcounty.gov](mailto:NMESewer@kingcounty.gov).

Phase 1: S.E. 35th Pl. closed east of Briarwood Lane

- If you live at 9950 or 9960 S.E. 35th Pl., access your home via the temporary access road connecting S.E. 35th Pl. with Frontage Road.
- If you live on or west of Briarwood Ln., continue to access your home from E. Mercer Way and S.E. 35th Pl.
- **There will be no access east of Briarwood Ln. from E. Mercer Way and S.E. 35th Pl.**
- Flaggers will direct traffic.

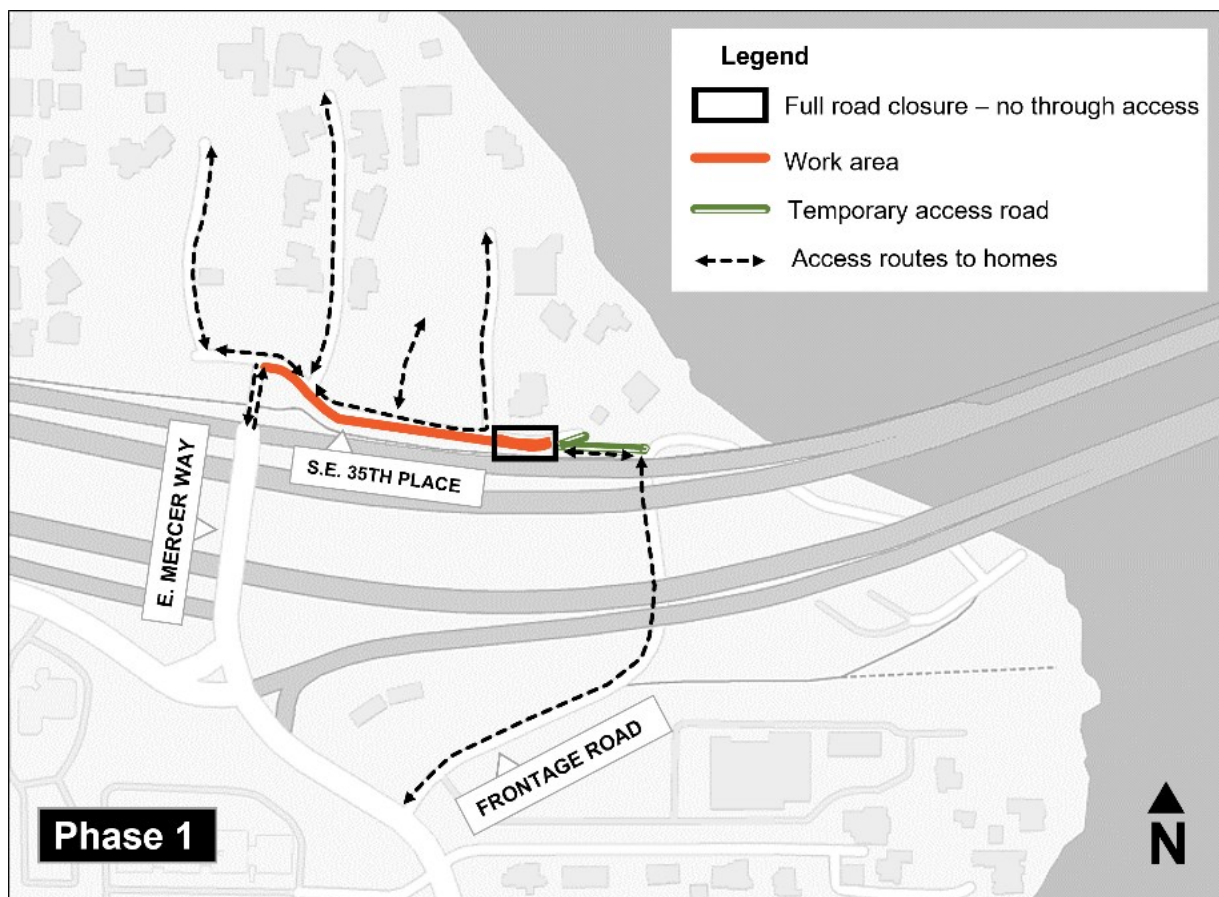

What to expect during construction:

- Typical work hours are 7 a.m. to 7 p.m. Monday to Friday and 9 a.m. to 6 p.m. on Saturday.
 - Work outside these hours will be done as approved by the City of Mercer Island.
- All work will be performed in the public right-of-way.
- Flaggers, traffic control signals, and single-lane alternating traffic during work hours.
- Access to the Mercer Island Boat Launch will be maintained.
- Noise, dust, and vibrations typical of an active construction project.
- Emergency vehicle access will be maintained.
- Garbage, recycling, composting, and mail service will be maintained.
 - If services are interrupted, please call the project hotline at 425-305-3587.
- Construction schedules can change based on factors such as site conditions, weather, and material availability.

NORTH MERCER ISLAND/ENATAI

Sewer Upgrade Project

Talk to us! For more information or to schedule a meeting, please contact:

The community services team at **425-305-3578** or **NMEsewer@kingcounty.gov**

Visit the project Webpage at **www.kingcounty.gov/MercerEnataiSewer**



@KingCountyWTD



ALTERNATIVE FORMATS AVAILABLE
206-477-5371 / 711 (TTY Relay)