



King County

Department of Natural Resources and Parks
Wastewater Treatment Division

NORTH MERCER ISLAND/ENATAI Sewer Upgrade Project

November 22, 2022

Construction on Southeast 35th Place begins November 28th

Background:

As early as Monday, November 28th, King County crews will begin construction in the cul-de-sac on Southeast 35th Place. To complete work, the cul-de-sac and SE 35 Pl will be partially closed between East Mercer Way and Briarwood Lane (see map on reverse). Residents will still be able to access their homes.

Updated Traffic Control Plan:

We have approval from the City of Mercer Island to use temporary signals to maintain one lane of traffic around the work area. The temporary signals are set to hold traffic for up to 15 minutes. This time allows crews to move materials and equipment and ensure safe passage for people driving.

These signals are set up to communicate with one another and will be adjusted regularly to respond back to the feedback we hear from our construction team and neighbors. We understand that waiting at these lights can be a temporary inconvenience for near neighbors.

Pedestrian and bike access to the Mercer Island Boat Launch will be closed during construction on SE 35th PL. The I-90 Trail will remain open to the south of SE 35th PL.



Approximate locations of the above and below-ground structures that will support future operations.

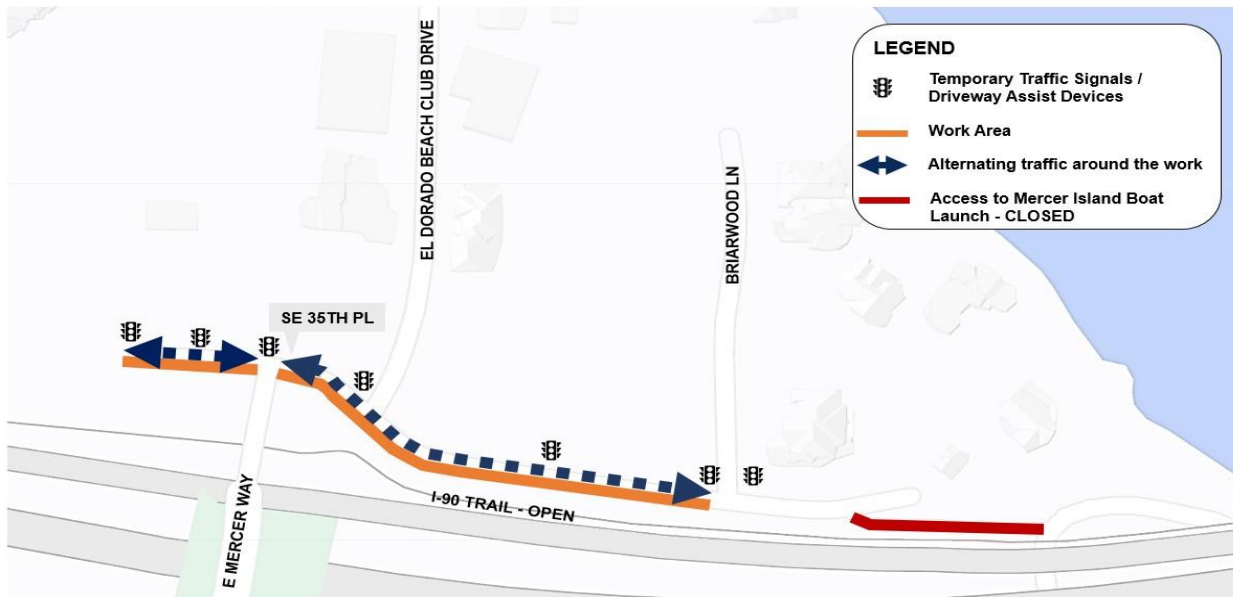

Work and Staging areas in SE 35th PL

What to expect:

- All work will be performed in the public right-of-way.
 - We will not access private property during this work unless we have a signed agreement.
- Permitted work hours are 7 a.m. to 7 p.m. Monday to Friday and 9 a.m. to 6 p.m. on Saturday.
 - Work outside these hours will be done as approved by the City of Mercer Island.
- Some homes may be subject to temporary daytime driveway access interruptions.
 - Access to residences should always be maintained during construction. If access is denied, please call the 24-hour hotline at 425-305-3578. We will speak with the on-site construction inspector and contractor and resolve the issue as quickly as possible.
 - Crews will lay metal plates over excavations to restore access as needed. It may take crews up to 15 minutes to set up a safe surface for you to cross.
- There will be noise, dust, and vibrations typical of an active construction project.
- Emergency vehicle access will be maintained during construction.
- Services such as garbage, recycling, composting, and mail will not be interrupted.

Learn more:

- Read about work on SE 35th PL by visiting the project website (scan the QR code to access) www.kingcounty.gov/MercerEnataiSewer.
- Sign up for location-specific email lists by scanning the QR Code to the right.
- Changes to email and text preferences must be done using an internet browser. Changes submitted via text to KING MERCERSEWER at 468-311 will not be applied.
- Contact the community services team by calling or texting 425-305-3578 or email NMEsewer@kingcounty.gov