

The background of the slide features a light beige, marbled texture. On the left side, a dark, thin branch extends upwards, with a single dried, brownish leaf attached. Another similar branch and leaf are positioned in the lower right corner.

Get Started on A Beautiful, Healthy Landscape

Monica Van der Vieren and Ryan Leigh

January 13, 2018

Brightwater Center Natural Yard Care Series



Getting to know each other

- New to gardening?
- New yard?
- Old yard you're tired of?



This is
what I
really do
for a
living.....

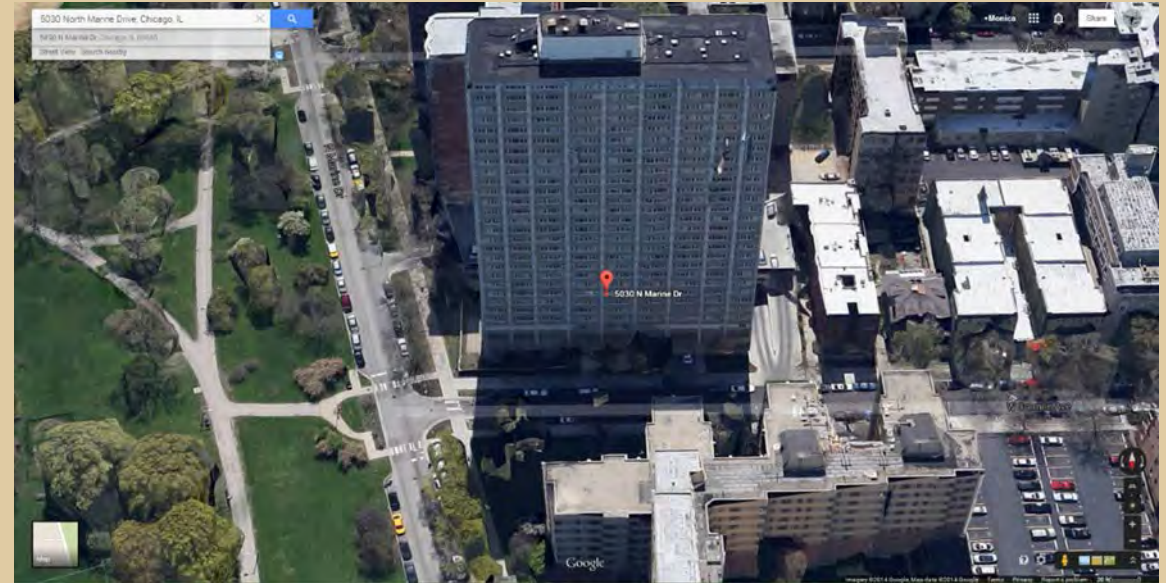

And where I grew up.

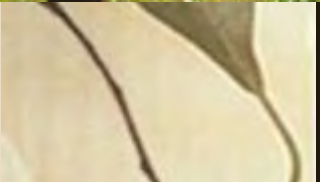



Getting started

- 1) Finding your inner gardener- goals, ideas, energy level, and what you like
- 2) Mapping the lay of the land
- 3) Defining your project- scope, schedule, budget, available resources



Garden design & plant selection that meet your goals and fit your style & space



What's your vision?



Out-of-the box gardening



<http://media-cache-ak0.pinimg.com/736x/2749/d0/2749d0c51c91848ba1137b77658d9148.jpg>



<http://media-cache-ec0.pinimg.com/236x/d1/4b/e8/d14be86038a39c40a64071474000dd04.jpg>

<http://media-cache-ak0.pinimg.com/236x/1e/15/9c/1e159cffb1207310ad21ff75f904ce92.jpg>



Ballard
P-Patch, from
seattle.gov



Food



- Vegetables
- Fruit trees and berries
- Herbs



Wildlife use

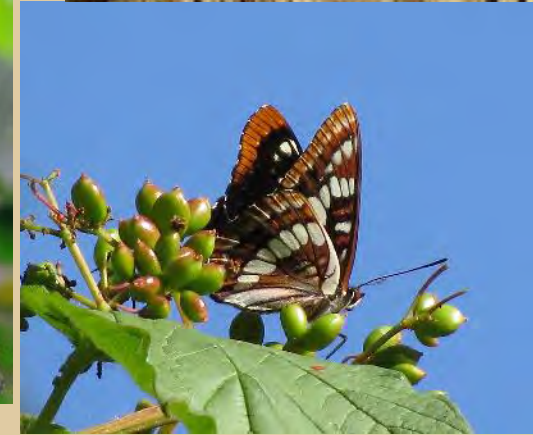

Color

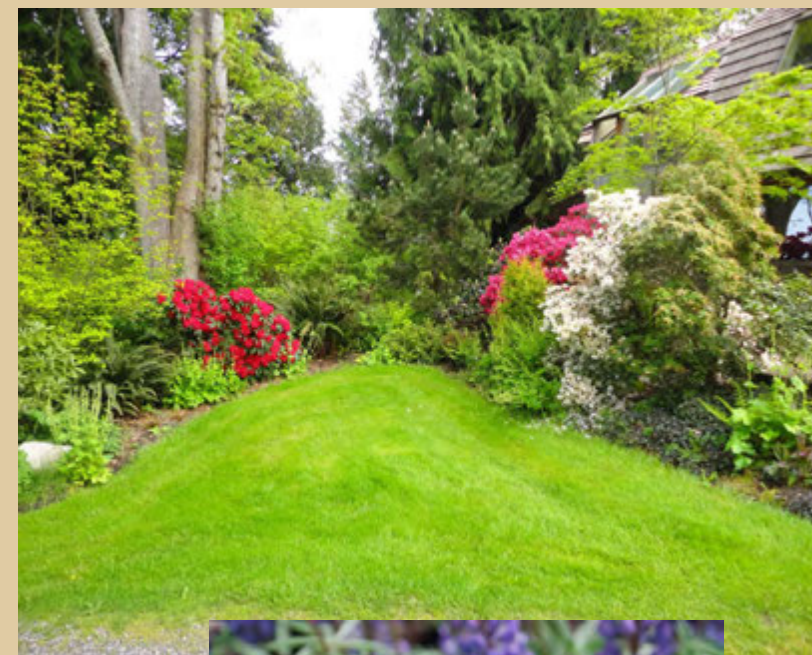
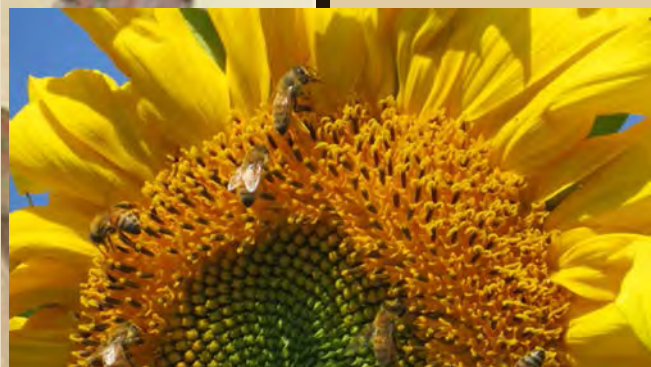



Fragrance



Pacific
crabapple



Bee balm

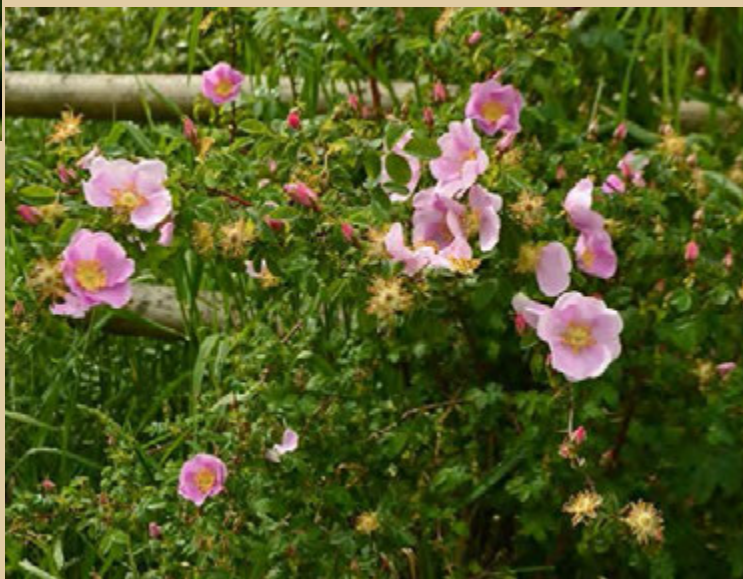

Mock orange



Nootka rose and Oregon grape

Fun and relaxation

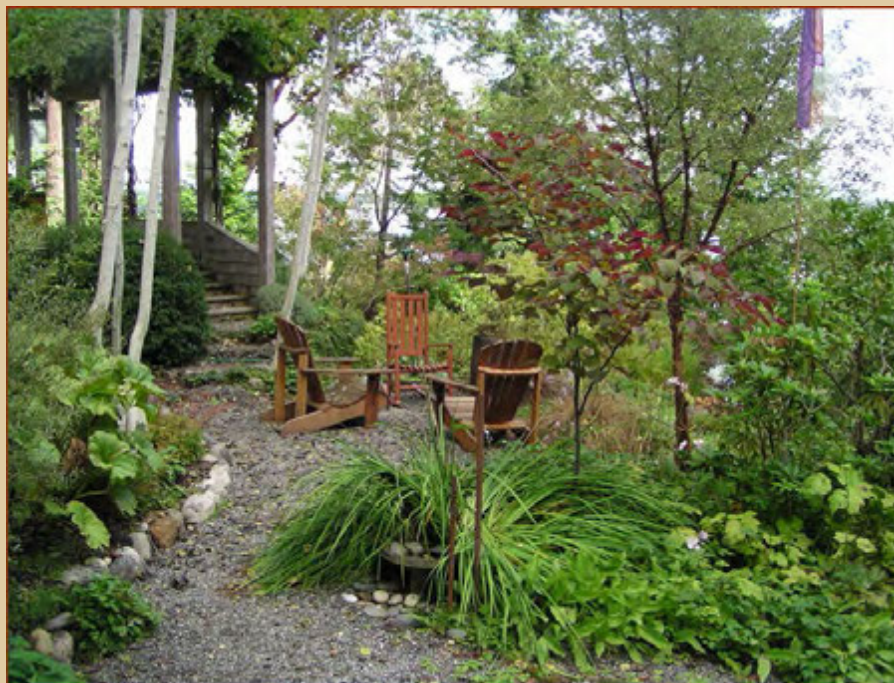

Know Your Style



www.richardmanion.com



Let's plan a project for our new house!

- 1916 Barn house style with addition
- Large lot, $\frac{3}{4}$ acre
- Lawn, mature hemlock tree, some shrubs around house



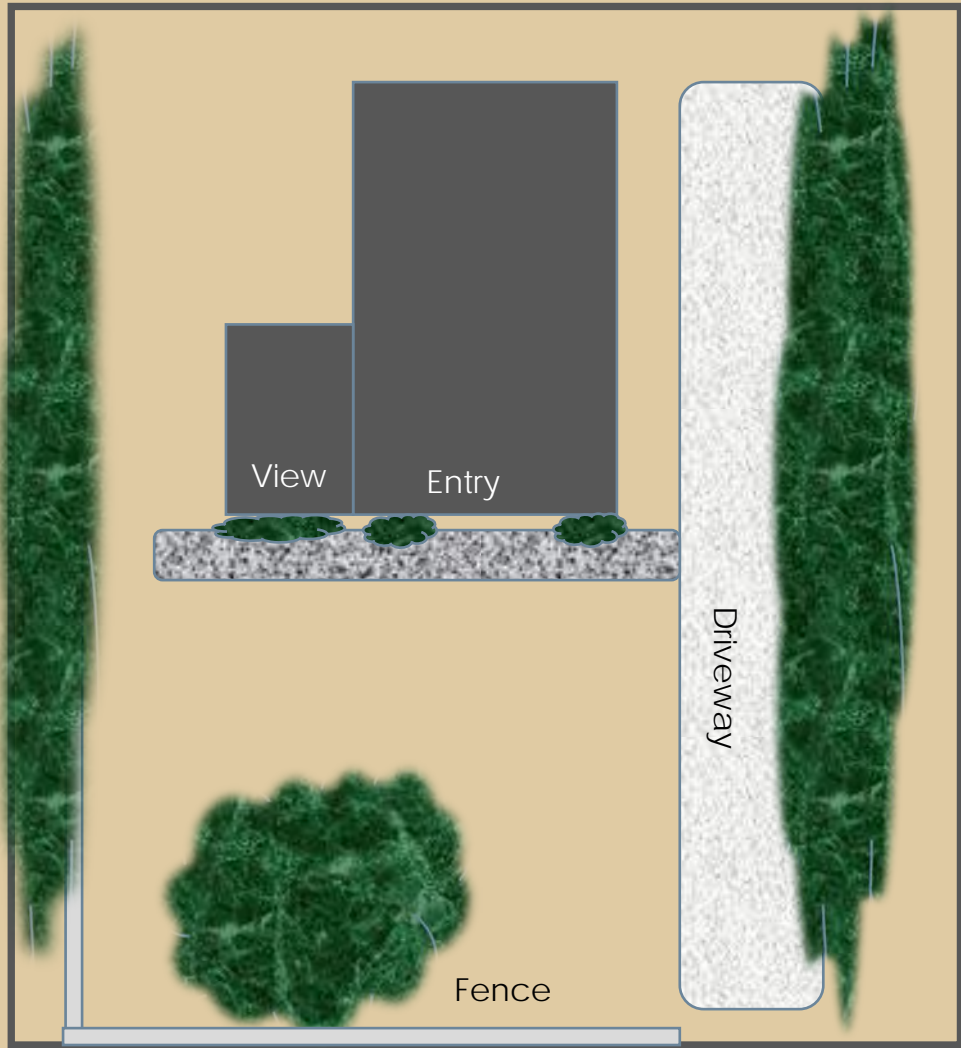

Know the lay of the land



Take a good look at your neighbors

- Do they have attractive landscape elements?
- Is there something you want to block out?
- Do they have a view?
- Will my plan affect their home, property, or utilities?
- Do I know where the property line is?



Know the rules

- Local jurisdiction
- Homeowner's association, covenants
- Critical areas- slopes, creeks, wetlands, protected waters

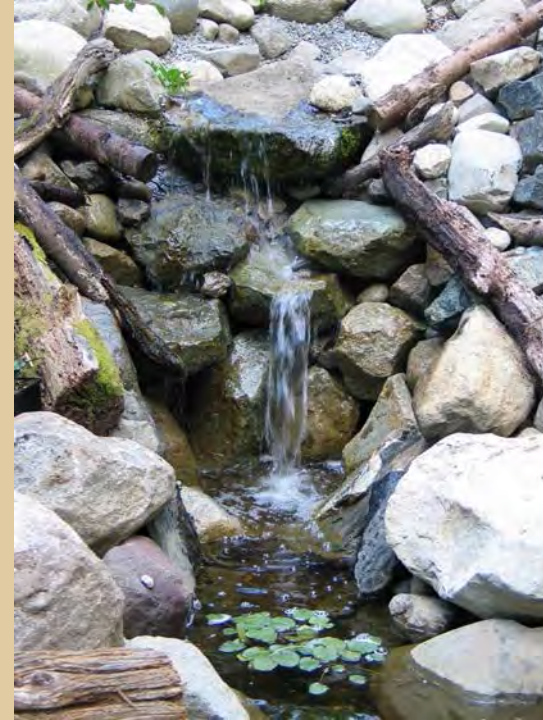

Mind your utilities

- Locate overhead and underground utilities
- Choose plants that don't cause utility problems
- Locate hardscape thoughtfully

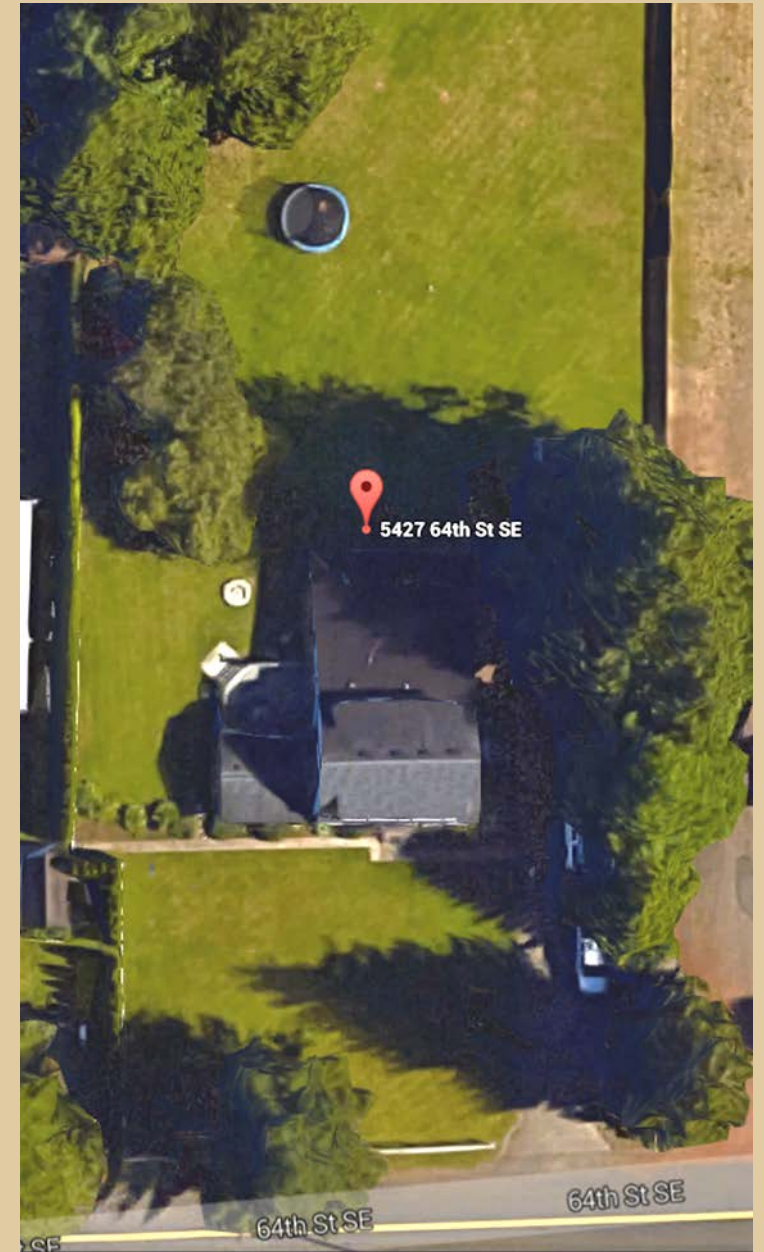

When You Don't Mind Utilities!

- Roots find water and take the easiest path to it.
- Call 811 locate prior to projects and then take photos of where painted lines are.



Hmmm...





Hardscape and Roots



- Locate hardscape thoughtfully.
- Consider plant material adjacent to hardscape areas.
- Root barrier products are available.

Avoid Future Issues!

- Pay attention to what is above.
- There may be regulations about what you can plant.
- Is your property on a corner? Consider sight triangles.

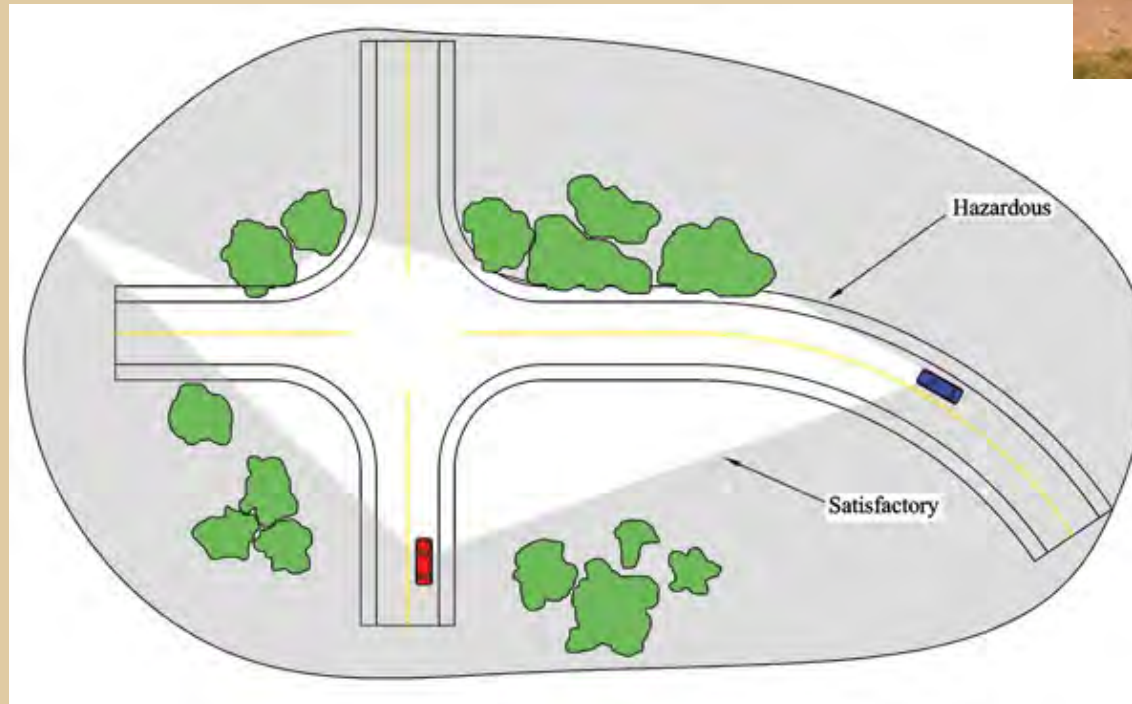

Plant With Growth in Mind

- Space plant material for full growth.
- Smaller plants are cheaper but avoid tighter spacing.
- Example: Monkey Puzzle trees....do they stay small?



They do not!



Landscaping around utilities or
in the right-of-way will be
removed at some point.



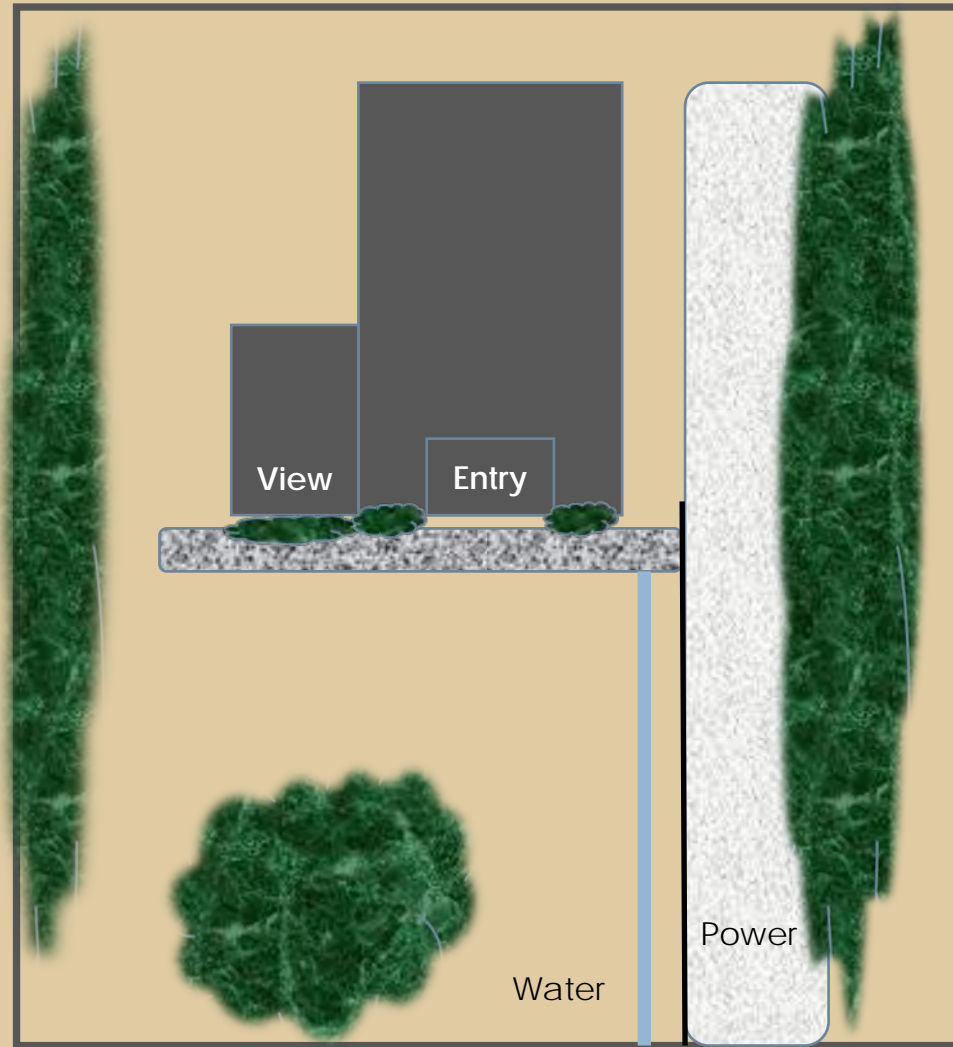

- Map out what you've got:
 - Paths
 - Views
 - Utilities
 - Existing vegetation
 - Site constraints such as slopes, septic fields, and wet areas

Give yourself a path forward

- Map out how you want to use your yard
 - Travel areas
 - Pet use areas
 - Play areas
 - Sitting areas
 - Perimeter screen



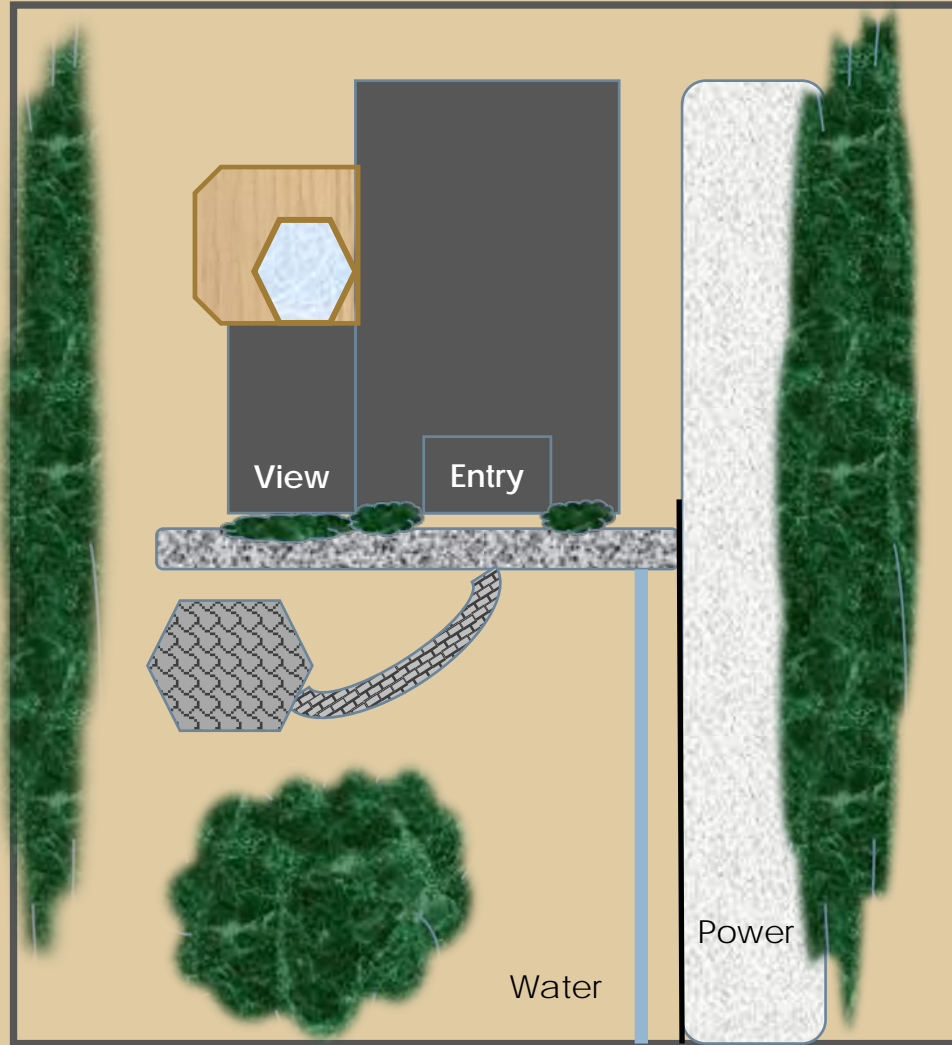
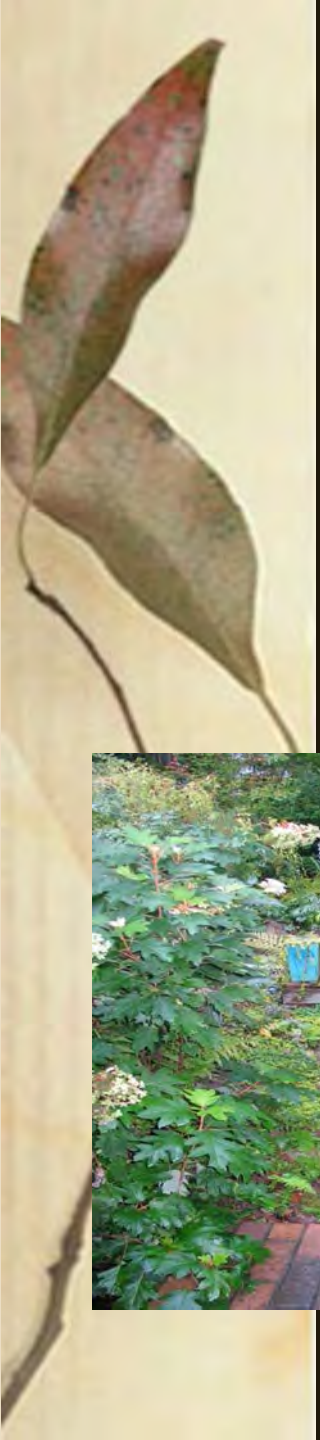

Safety and access first



(Left) Before- big shrubs along the walkway to the door reduce visibility and walkability

(Right) Lower growing plants free up walking space and allow a view to the front door.



Other Issues with Large Shrubs

- Critters can find access
- Reduces air flow at foundation and siding
- Branches can grow where they shouldn't



If Something Isn't Right, Correct It

- If you have inherited problem plants, consider correcting past mistakes.
- Removal cost increases as plants and trees grow.



We've moved our shrubs

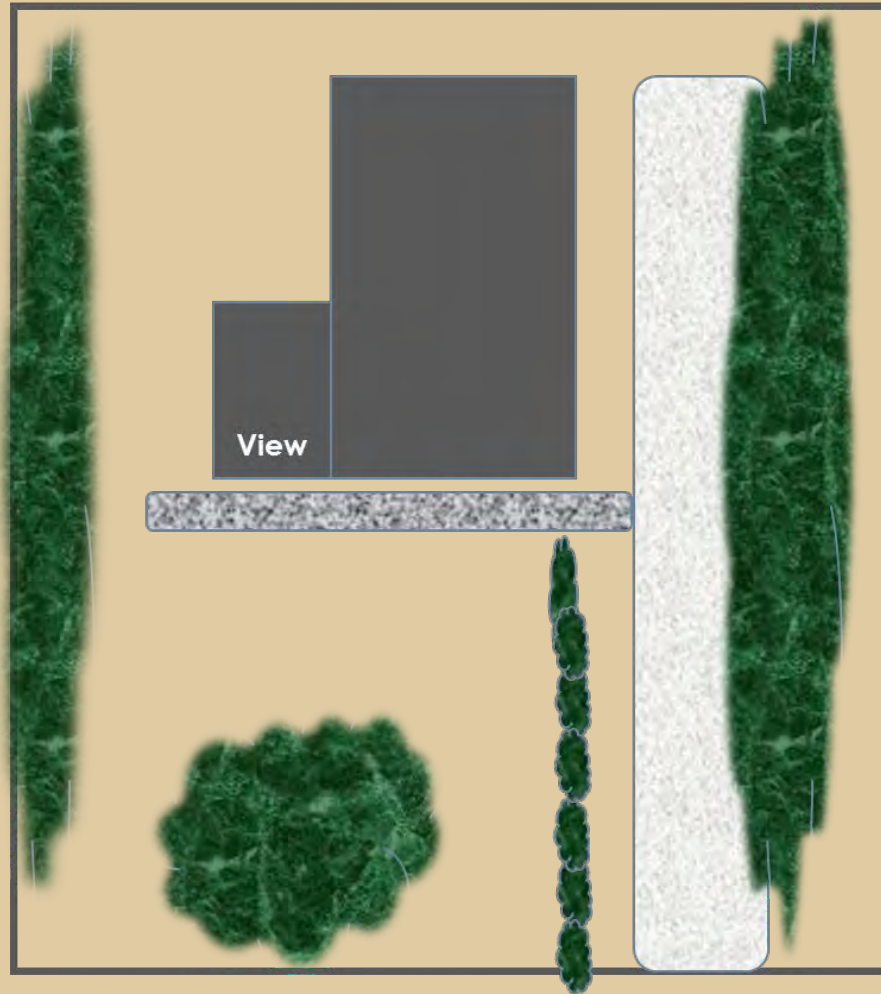

Evaluate Conditions

- Sun/shade
- Dry/wet
- Nearby trees and plants

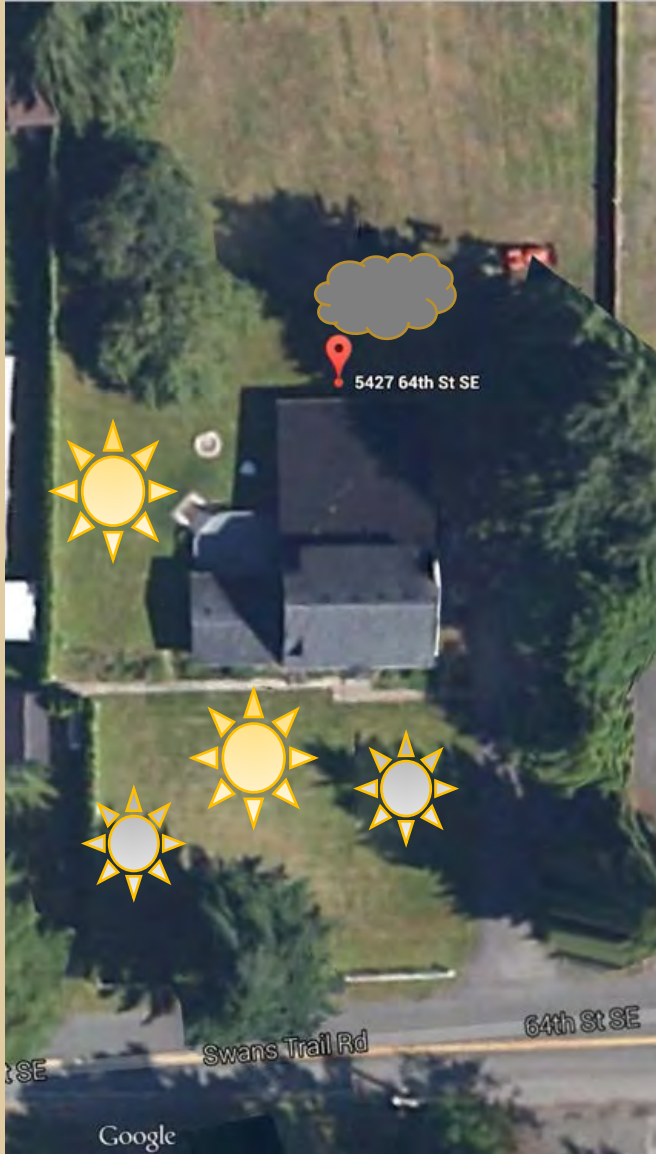

North

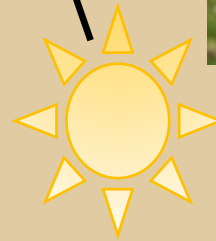

Check prevalent wind direction



Garden space is more than ground

- Pots
- Beds
- Hanging planters, window boxes
- Islands
- Rockeries
- Trellises
- Espalier
- Garden art
- Lighting



Consider the Future

- How permanent do you want those hardscape elements?
- Are there anticipated improvements or changes?



Layer the landscape

- Plants at low, medium, and high level (plant height or pots)
- Plant taller plants farther away in a view to give impression of space
- Plant to accent your hardscape

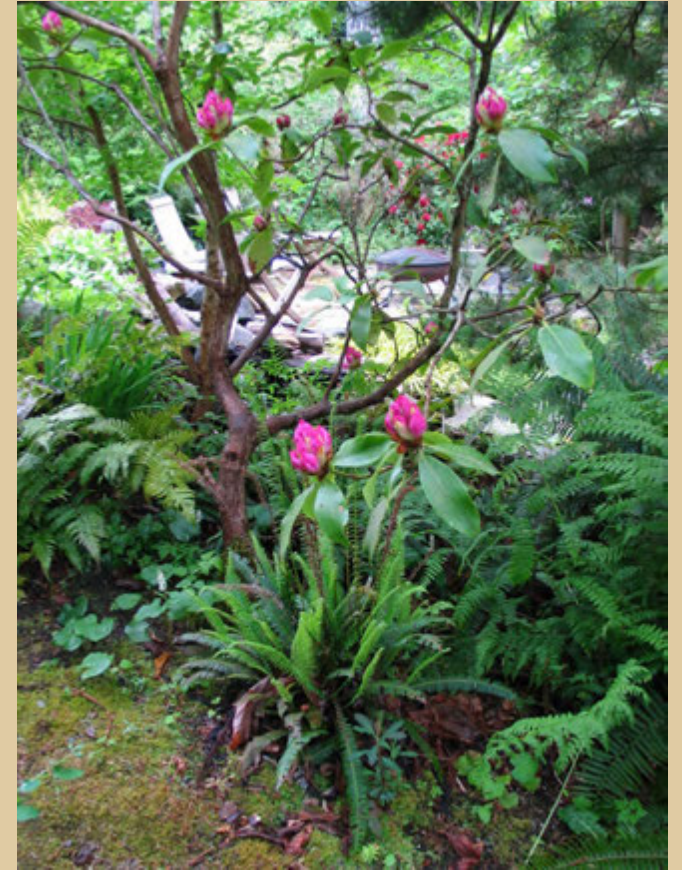



Expanding sense of space



Curving lines and peninsulas make a space appear larger and give more planting area





Hamilton Gardens, Waikato, New Zealand, Wikipedia commons

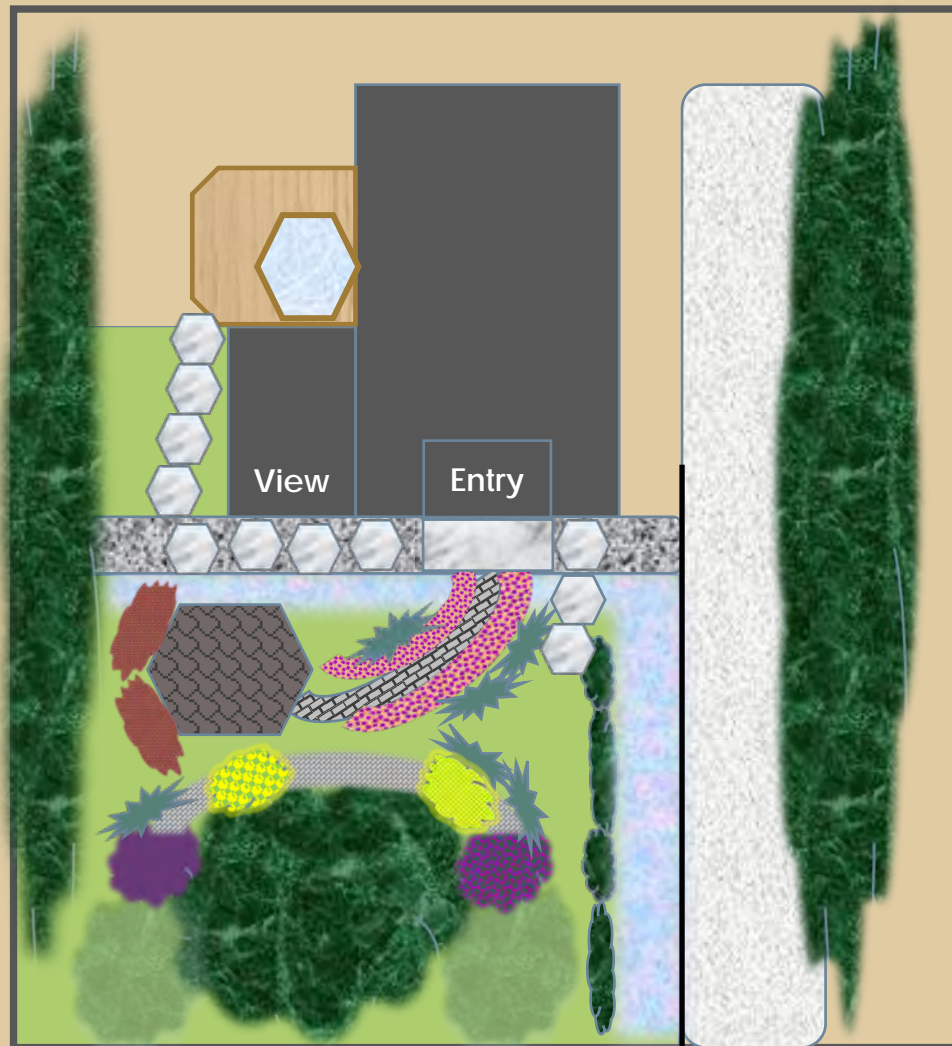

Decide how you'll prepare the space

- Build beds or boxes, buy pots, acquire salvage pieces
- Remove or move existing vegetation
- Plan and prepare for rain gardens and ponds



Are You Considering Retaining Walls?

- Concrete walls need solid footings.
- Block walls may need geogrid fabric.
- Anything over 4' needs to be engineered.
- Terraced retaining walls have regulations as well.



Wood Retaining Walls?

- Timber walls need to be tied to hillside
- Anything over 4' needs to be engineered
- Joints need to be considered



Weed Fabric – Good idea or not?

- Weed control is for a limited amount of time.
- Slopes pose issues for holding mulch.
- Water infiltration diminishes over time.
- Woven vs. Non-Woven



Amending soil to save water, bucks and energy

- Start with smaller plants
- Use lots of compost and mulch
- Amend soil, or haul in new soil



Keep Those Trees Alive

- Do not 'Volcano' mulch
- Pay attention to the root collar

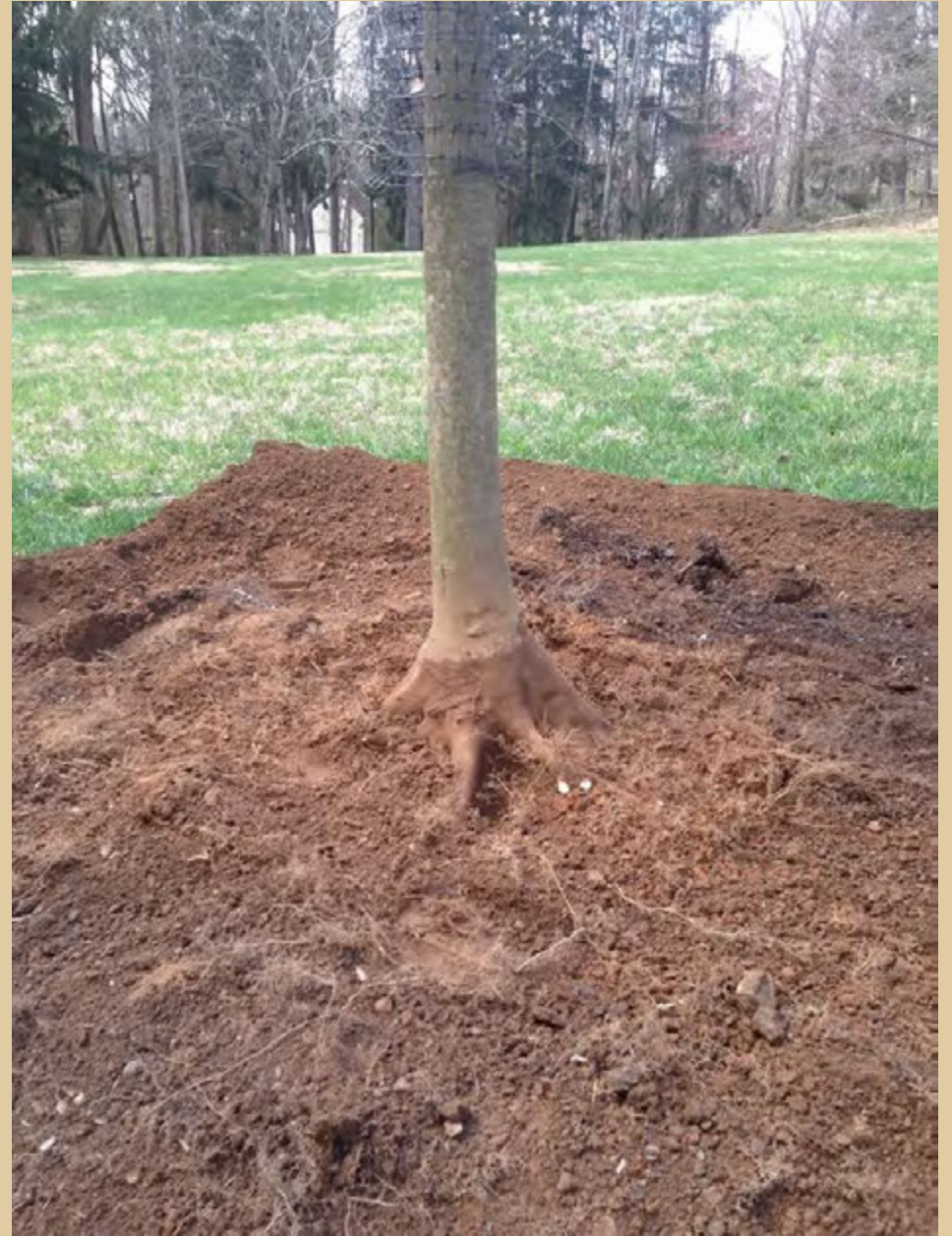

Nope, Nope, All Kinds of NOPE!





Time planting to reduce risk and water use

- Plant in ground late fall-early spring
- Mulch to keep moisture in and weeds down



Plan how you'll maintain your garden or landscape

- Time and elbow grease
- Tools
- Landscaping services vs. solo
- Professional services (i.e. tree trimming)
- Do you have to rely on pesticides?



Establishment to Established

- Cut down on irrigation slowly.
- Remove staking.
- Schedule major maintenance or it likely won't happen.





Good job!
You're on your way!