

PROJECT APPLICANT:

KIRK LEMOYNE B. HARWELL
400 18th AVE E.
SEATTLE, WA 98112

PROJECT ADDRESS:

24533 143RD AVE SW
VASHON, WA 98070

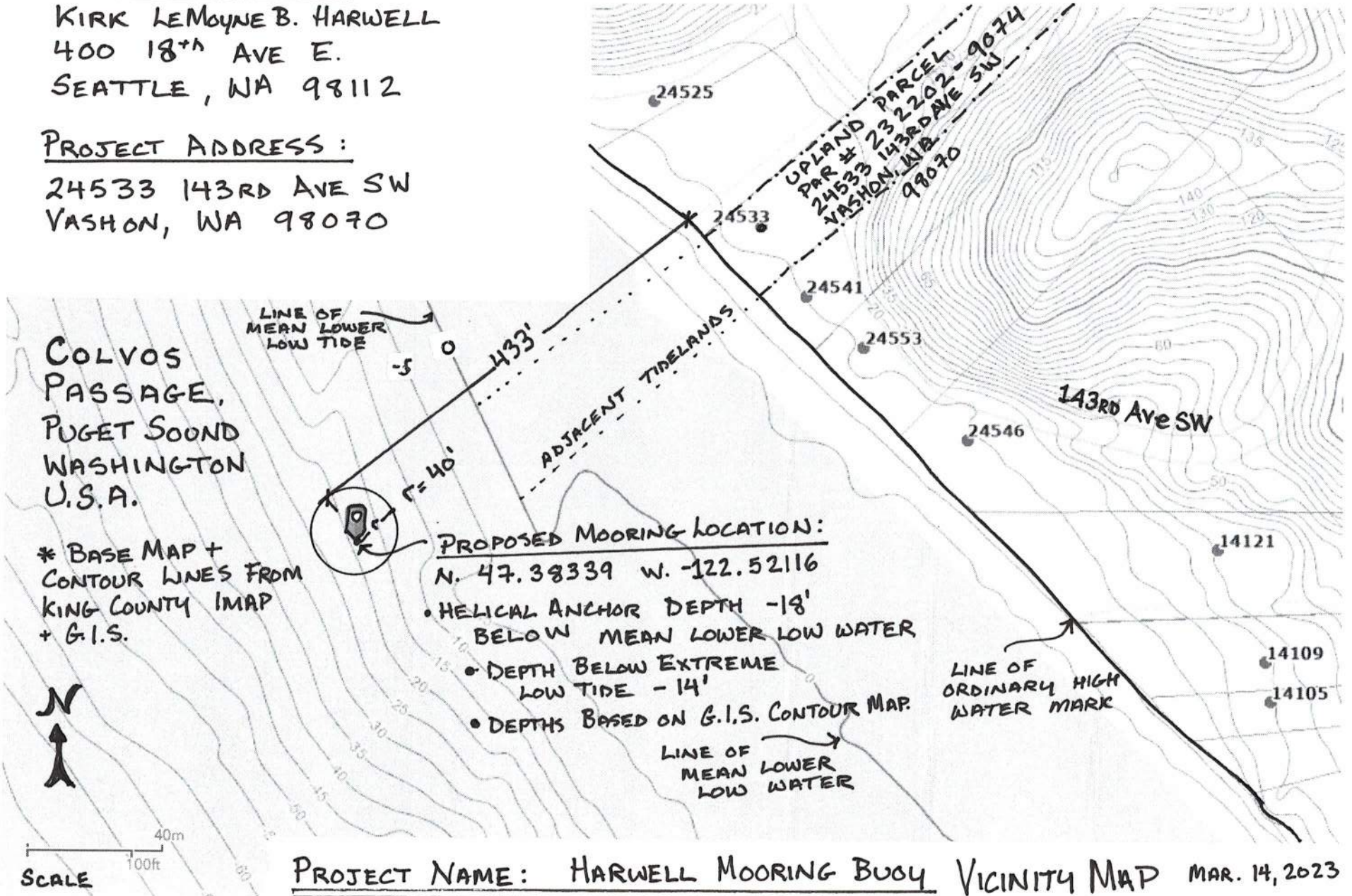

COLVOS
PASSAGE,
PUGET SOUND
WASHINGTON
U.S.A.

* BASE MAP +
CONTOUR LINES FROM
KING COUNTY IMAP
+ G.I.S.

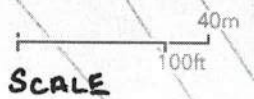

PROPOSED MOORING LOCATION:

- N. 47.38339 W. -122.52116
- HELICAL ANCHOR DEPTH -18'
BELOW MEAN LOWER LOW WATER
- DEPTH BELOW EXTREME
LOW TIDE - 14'
- DEPTHS BASED ON G.I.S. CONTOUR MAP.

PROJECT NAME: HARWELL MOORING BUSY VICINITY MAP MAR. 14, 2023

