

# King County

Department of Local Services  
Permitting Division

Residential Site Plan Template  
11" x 17"

## For Permitting Use

Received Date \_\_\_\_\_

Max Impervious Surface \_\_\_\_\_

Max Bldg. Height Allowed \_\_\_\_\_

Min Setback from Street \_\_\_\_\_

Min Garage Setback \_\_\_\_\_

Min Setback from Interior \_\_\_\_\_

Signature \_\_\_\_\_

Date \_\_\_\_\_

## Building Approval

Signature \_\_\_\_\_

Date \_\_\_\_\_

## Engineering / Drainage Approval

Signature \_\_\_\_\_

Date \_\_\_\_\_

## Critical Areas Approval

Signature \_\_\_\_\_

Date \_\_\_\_\_

## Clearing / Grading Approval

Signature \_\_\_\_\_

Date \_\_\_\_\_

## Fire Approval

Signature \_\_\_\_\_

Date \_\_\_\_\_

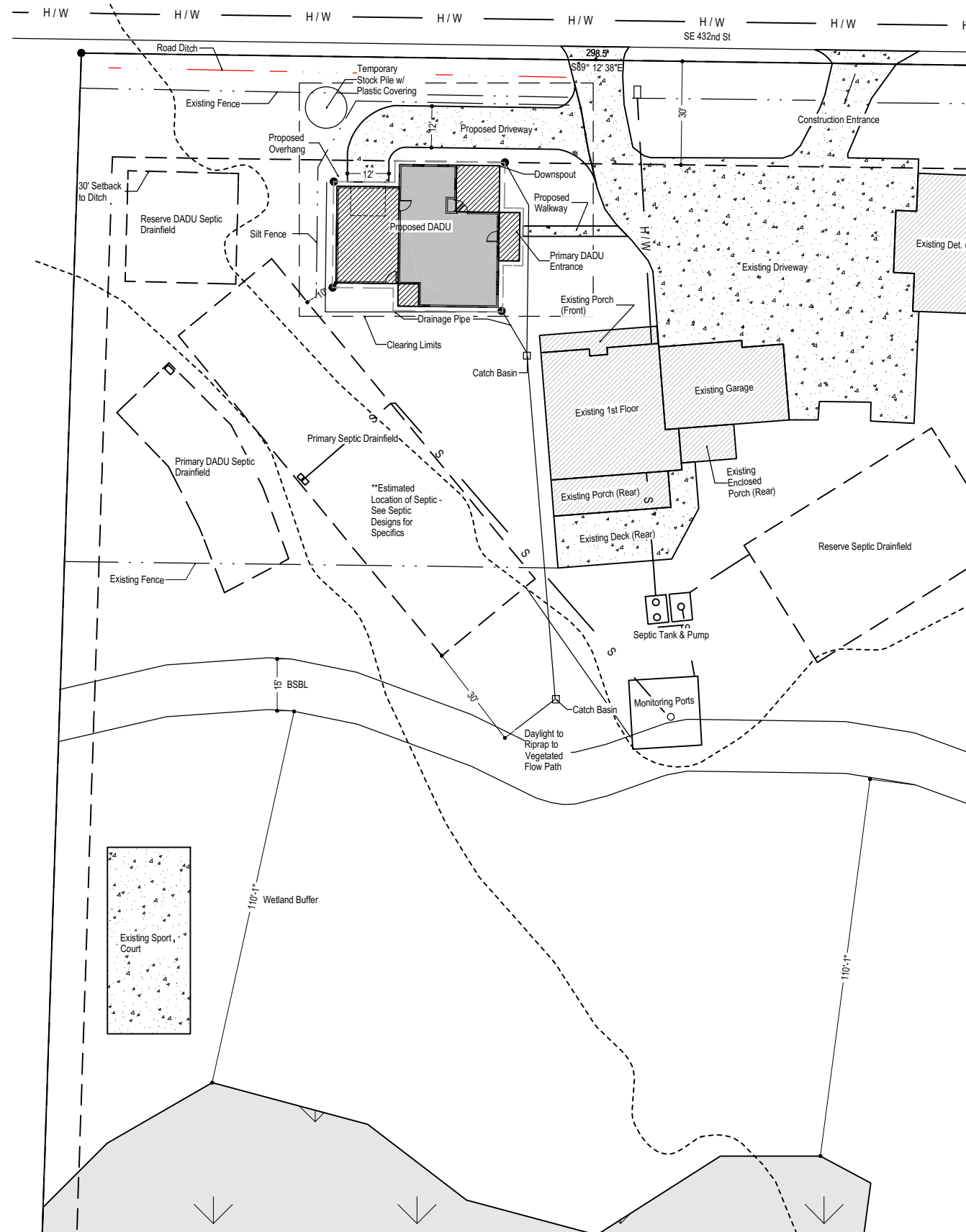
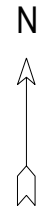

Site Plan - EHD-1XXXXX1-S Site Plan  
Scale: 1 in = 40 ft

Site Plan - EHD-1XXXXX1-S Site Plan  
Scale: 1 in = 200 ft

### Legend - Additions/Remodels

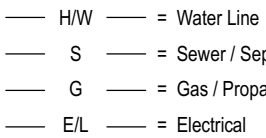
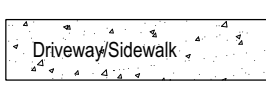
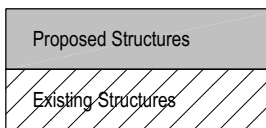

### SITE ANALYSIS

#### Property Analysis

Property Area =	392258 Sq.Ft.
Setback Area =	- 37542 Sq.Ft.
Easement Area =	- 0 Sq.Ft.
Wetland Area =	- 277044 Sq.Ft.
Wetland Buffer Area =	- 0 Sq.Ft.
<b>Buildable Area =</b>	<b>77672 Sq.Ft.</b>

#### Habitable Space Area

- Existing 1st Floor =	1300 Sq.Ft.
Total Existing =	1300 Sq.Ft.
- Existing Dadu =	981 Sq.Ft.
Total Proposed =	981 Sq.Ft.
<b>Total Habitable =</b>	<b>2281 Sq.Ft.</b>

#### Impermeable & Permeable Area

- Existing 1st Floor =	1300 Sq.Ft.
- Existing Deck (rear) =	660 Sq.Ft.
- Existing Det. Garage =	1228 Sq.Ft.
- Existing Driveway =	5893 Sq.Ft.
- Existing Enclosed Porch (rear) =	357 Sq.Ft.
- Existing Garage =	839 Sq.Ft.
- Existing Porch (front) =	180 Sq.Ft.
- Existing Sport Court =	1296 Sq.Ft.
Total Existing =	11753 Sq.Ft.
- Proposed Dadu =	981 Sq.Ft.
- Proposed Driveway =	935 Sq.Ft.
- Proposed Garage =	504 Sq.Ft.
- Proposed Overhang =	233 Sq.Ft.
- Proposed Porch (front) =	84 Sq.Ft.
- Proposed Porch (front) 2 =	169 Sq.Ft.
- Proposed Porch (rear) =	39 Sq.Ft.
- Proposed Walkway =	87 Sq.Ft.
Total Proposed =	3032 Sq.Ft.
<b>Total Impermeable =</b>	<b>14785 Sq.Ft.</b>

Permeable Area = 377473 Sq.Ft.

Total Impermeable / Property Area  
(14785 / 392258) = 3.77%