

PROJECT INFORMATION

APPLICANT:
SALIM MERCHANT

DRAWINGS BY:
ECCO DESIGN INC.
7413 GREENWOOD AVE N
SEATTLE, WA 98103
206-706-3937

SITE ADDRESS:
6417 RIPLEY LN SE
RENTON, WA 98056

PARCEL NUMBER:
334330-2210

BODY OF WATER:
LAKE WASHINGTON

LEGAL DESCRIPTION:
HILLMANS LK WN GARDEN OF EDEN # 3 & SH
LDS ADJ
PLAT BLOCK: B
PLAT LOT: 8-9

PROJECT DESCRIPTION:
REPLACE AN EXISTING BOAT LIFT.

VICINITY MAP

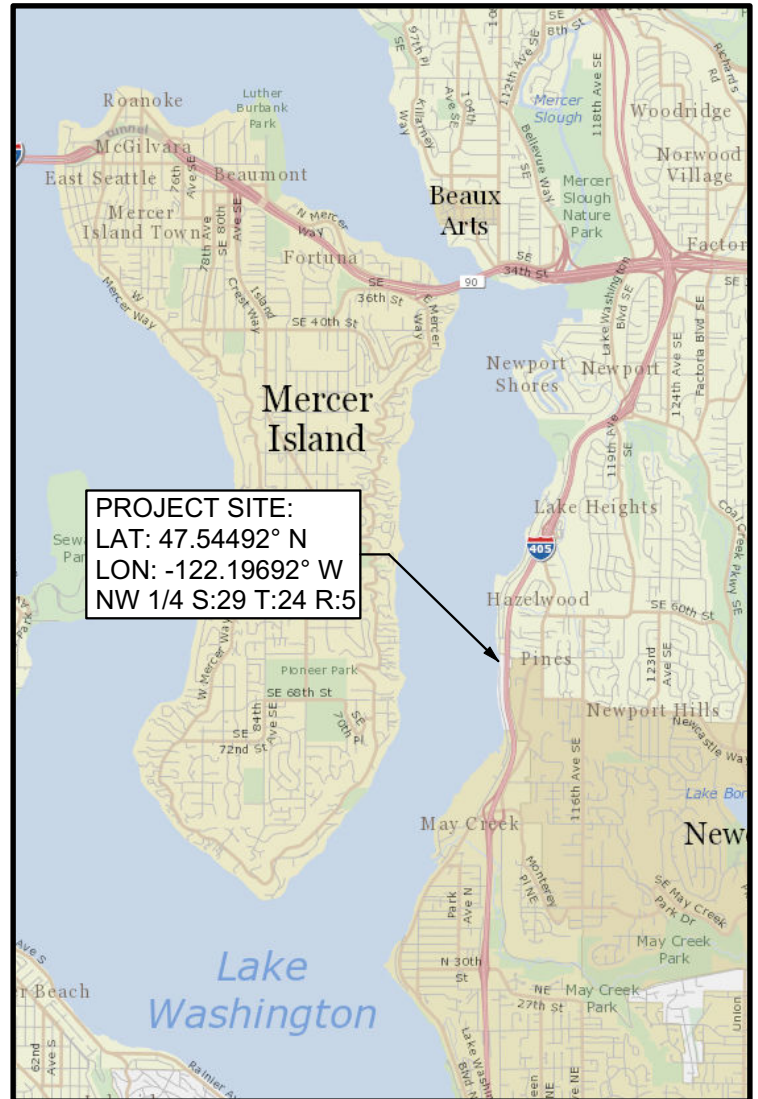

REFERENCE:

DATUM: C.O.E. Locks Datum

ADJACENT PROPERTY OWNERS:

1. 6409 Ripley LLC
2. Brendon Inman & Katrina Lee

APPLICANT: Salim Merchant

LOCATION: 6417 Ripley Ln SE
Renton, WA 98056

LAT/LONG: 47.54492°/-122.19692°

PROPOSED PROJECT:

Replace Boat Lift

IN: Lake Washington

NEAR/AT: Renton

COUNTY: King **STATE:** WA

SHEET 1 of 4

DATE: August 14, 2024

PLEASE NOTE THAT THE SHORELINE CONFIGURATION AND PROPERTY LINE LOCATIONS ARE APPROXIMATE ONLY. PROPERTY LINES ARE BASED ON KING COUNTY GIS.

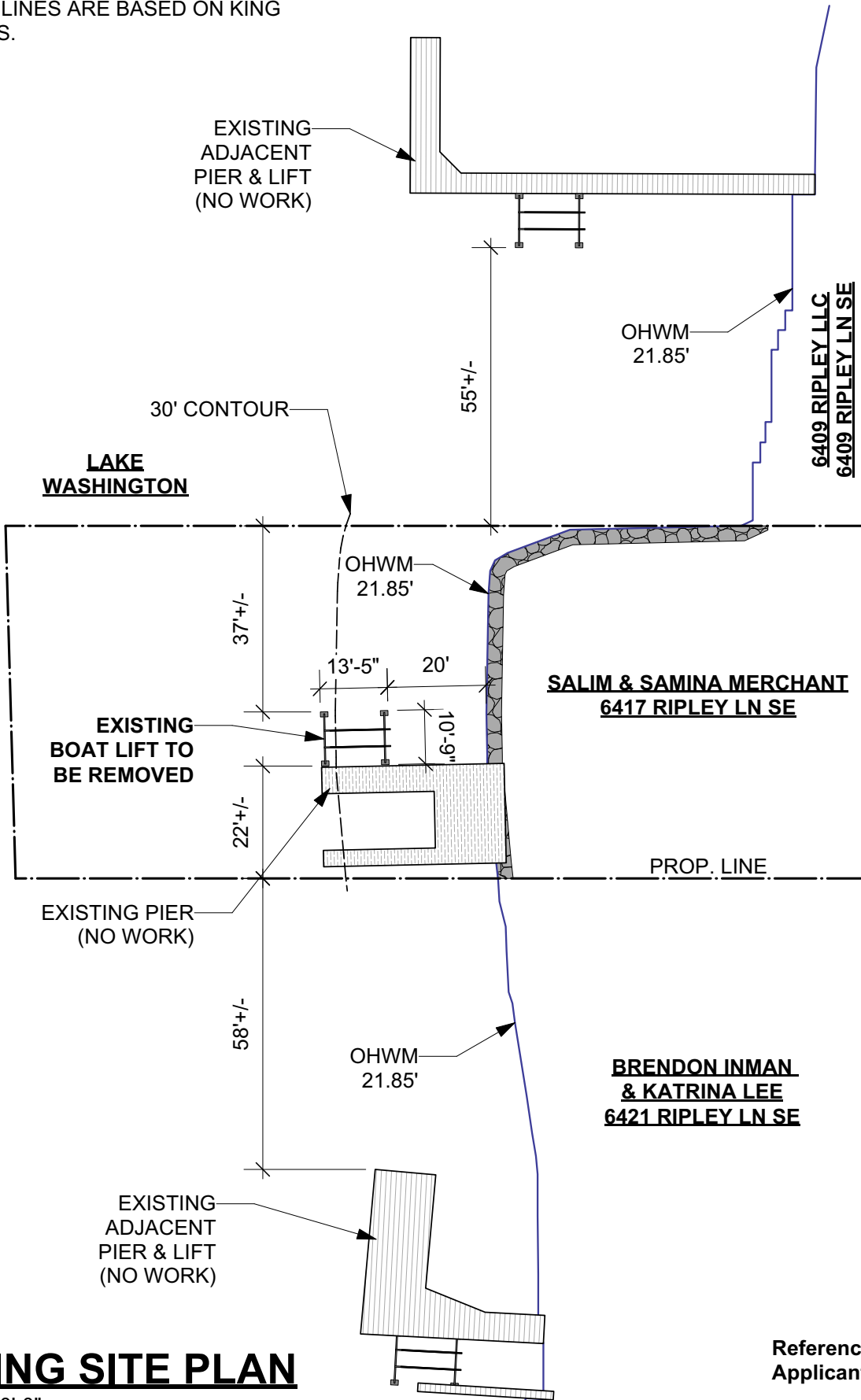

EXISTING SITE PLAN

SCALE 1" = 30'-0"

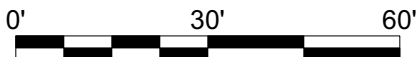

Reference:
Applicant: Salim Merchant

Proposed: Replace Boat Lift
Location: Renton, WA

PLEASE NOTE THAT THE SHORELINE CONFIGURATION AND PROPERTY LINE LOCATIONS ARE APPROXIMATE ONLY. PROPERTY LINES ARE BASED ON KING COUNTY GIS.

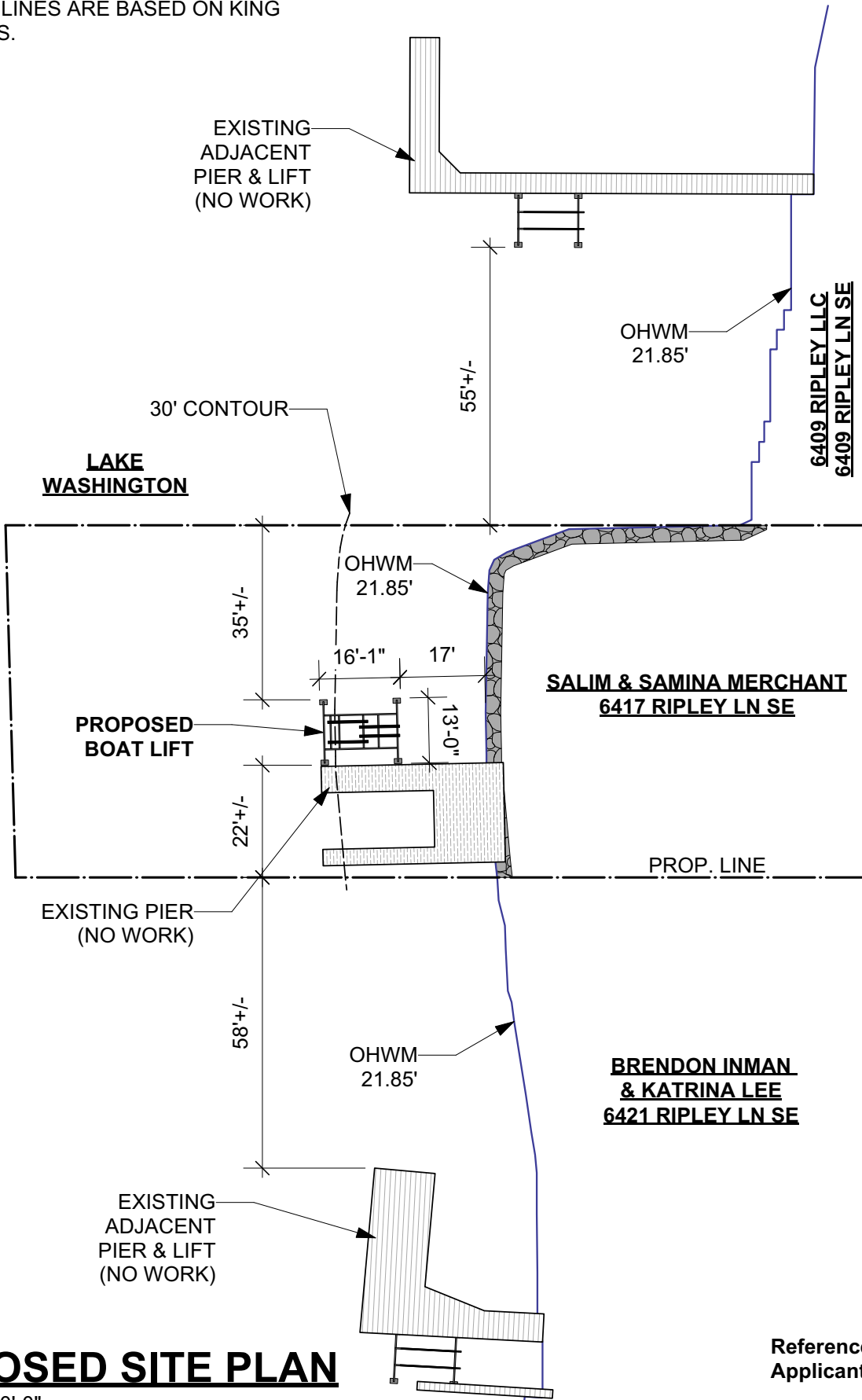

PROPOSED SITE PLAN

SCALE 1" = 30'-0"

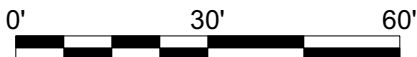

Reference:
Applicant: Salim Merchant

Proposed: Replace Boat Lift
Location: Renton, WA

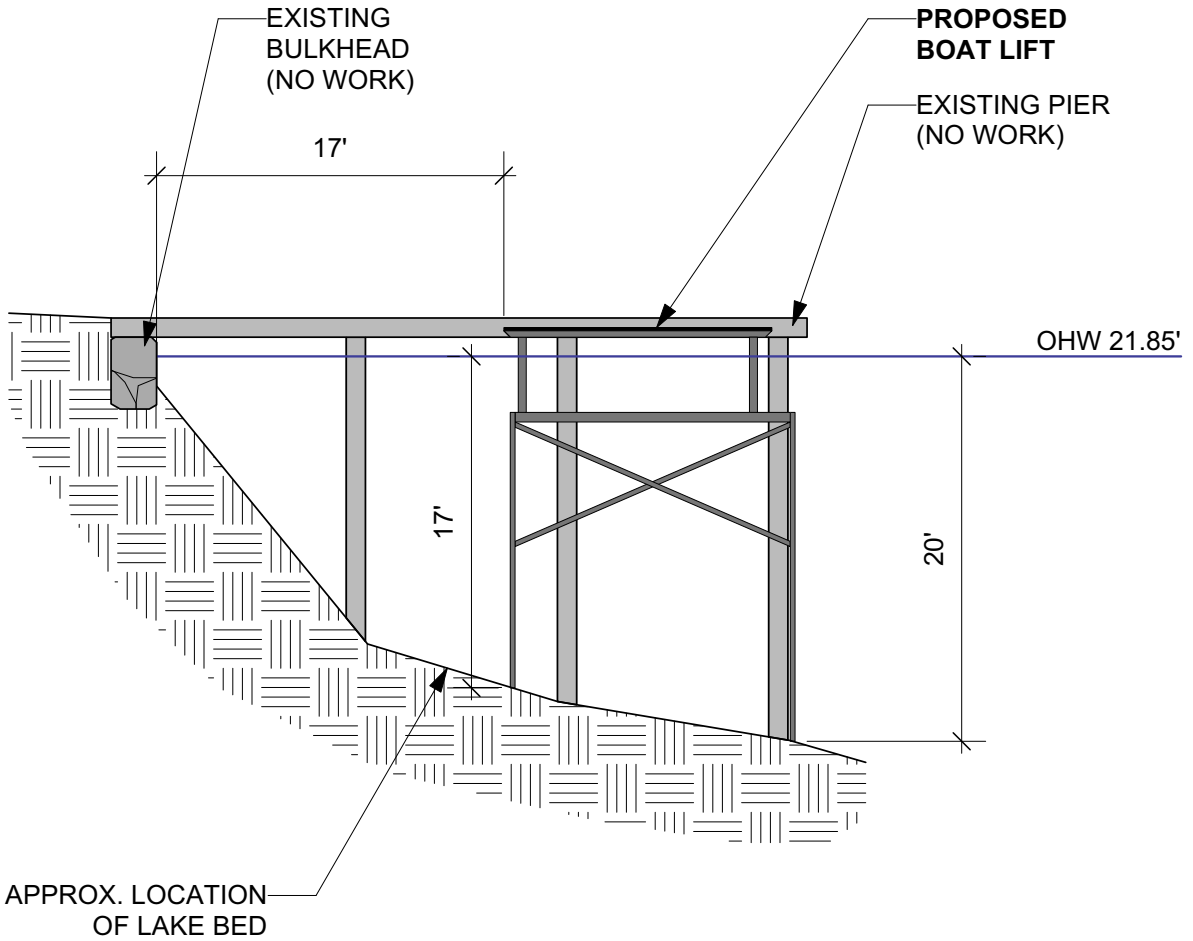

ELEVATION

SCALE 1" = 10'-0"



Reference:
Applicant: Salim Merchant

Proposed: Replace Boat Lift
Location: Renton, WA