



King County

Department of Local Services

Road Services Division

We're here for you.

Our Agenda

- Meet the team
- Project overview
- Timeline
- What to expect during construction
- Stay informed
- Questions & Answers





We collaborate to strengthen and empower communities

Vision

A thriving unincorporated King County where every resident feels heard, empowered, and supported by responsive and equitable local government.

Mission

Champion the well-being of community members in unincorporated King County by actively listening to them and delivering responsive local government services.

[KingCounty.gov/BaringBridge](https://kingcounty.gov/BaringBridge)



Meet the team!



Project Timeline



Project Overview

- Baring Bridge is a sole access bridge near Skykomish
- Existing bridge is old, in poor condition, and has a weight restriction.
- Temporary bridge:
 - Built just downstream from the current location
 - No weight restrictions
 - Will be used during construction of the permanent replacement
- Estimated temporary bridge project budget: \$3.5 million.



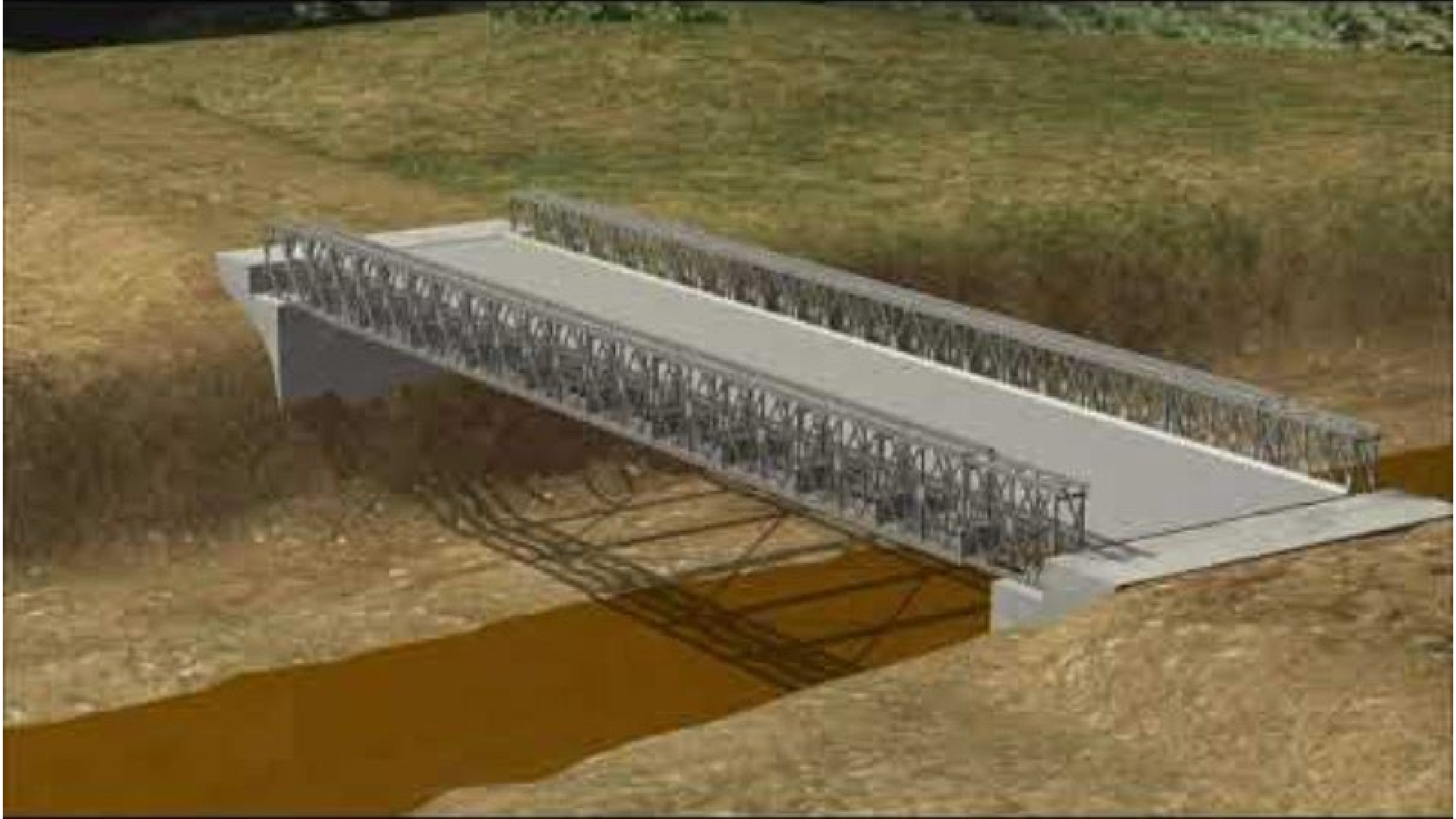

What to expect during construction

Existing bridge will be open during construction

- Expect delays of up to 10 minutes

Noise from saw cutting, jackhammers, excavators, trucks, generators, and pumps

Trucks hauling materials to and from the construction site

Tree removal

Protection of the river

Construction hours: 7 am to 5 pm



Contacts during construction

Name	Title	Phone	Email
Chidi Okereke	On Site Project Inspector	206-263-0901	cokereke@kingcounty.gov
Jeff Wilcox	Resident Engineer	206-263-0902	jwilcox@kingcounty.gov
Amy Bresslour	Communications	206-477-9223	abresslour@kingcounty.gov
Christina Lorella	Communications	206-477-5771	clorella@kingcounty.gov

Stay Informed



Project website
kingcounty.gov/BaringBridge



Landline phone
(206) 477-9223



Email
abresslour@kingcounty.gov



Road Alerts
Sign up! kingcounty.gov/RoadAlerts



MyCommute
kingcounty.gov/MyCommute



24/7 Road Helpline
206-477-8100 | maint.roads@kingcounty.gov



Communication channels

kingcounty.gov/roads



Unincorporated Area News



King County Local Blog



Instagram



Facebook



MyCommute



Traffic
Cameras



Road Alerts



Title VI Survey



<https://forms.office.com/g/mic6R7FRKL>

Questions & Answers

TEMPORARY BRIDGE

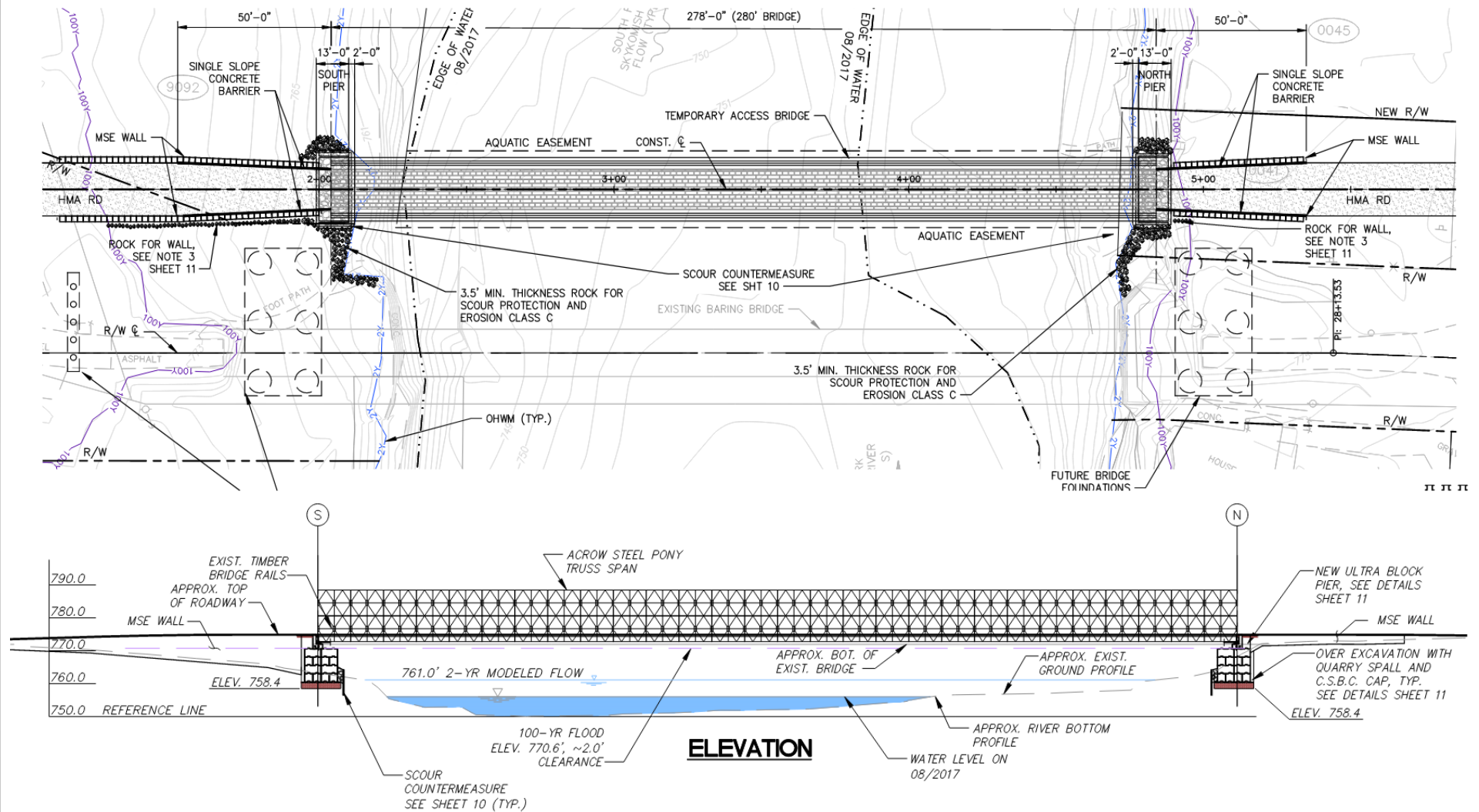

Baring Bridge #509A Replacement

NEW TRUSS BRIDGE

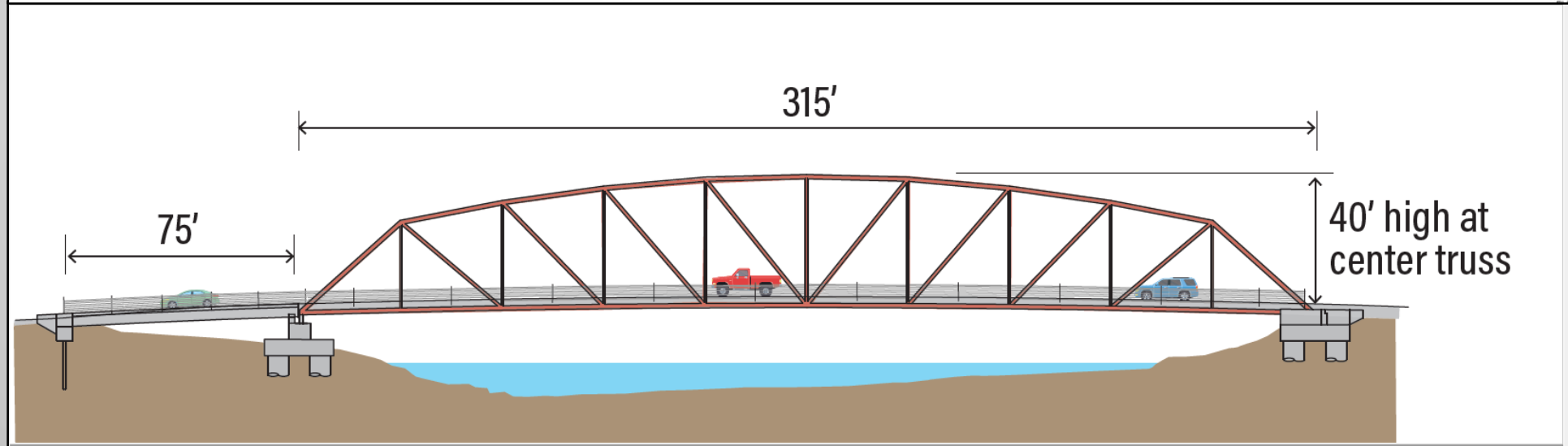
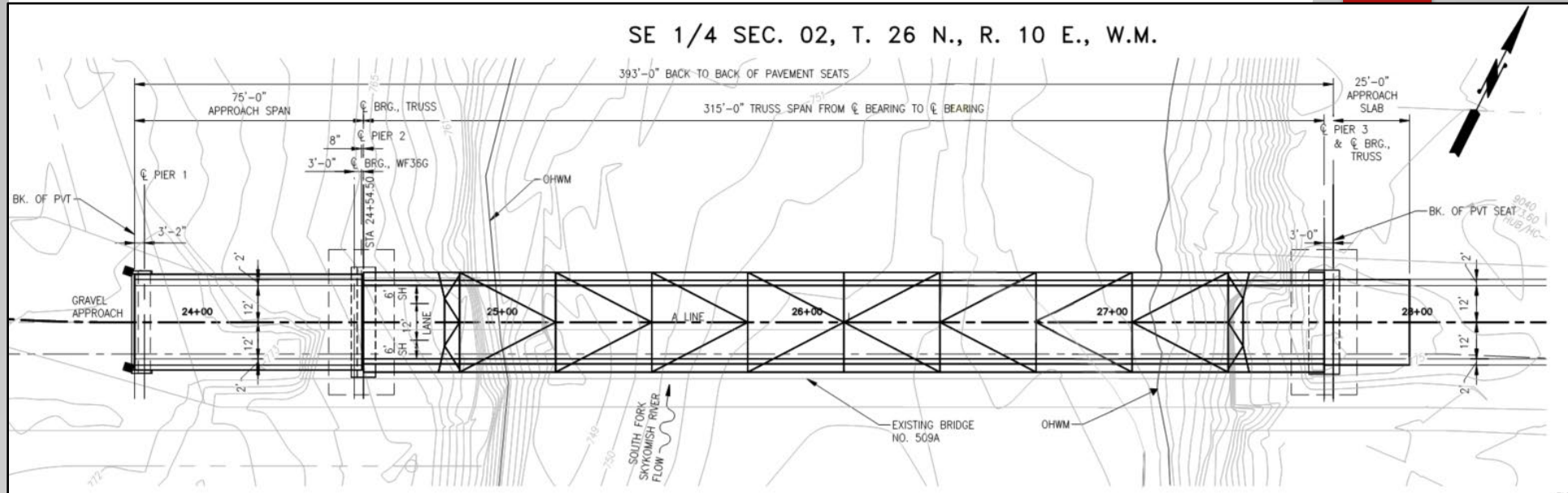

Baring Bridge #509A Replacement

Current Project Schedule

