



RapidRide I Line



Notice of upcoming construction

Please be advised that we will be performing the following work in your neighborhood; as we aim to be good neighbors, we are committed to minimizing disruptions and sincerely appreciate your patience throughout this project.

Upcoming site work: Installation of RapidRide I Line Bus Station

Location: 108th Ave SE & SE 200th St, Kent

- **UPDATE (4/3):** work at this location is pending necessary WSDOT approvals; we expect to begin end of this month.

Standard working hour window:

7:00AM – 5:00PM, Monday–Friday

This time is inclusive of quiet prep time, mobilization, set up, cleanup and storage. Weekend and night work may occur. Advanced notice will be provided.

*Anticipated impacts: (see back to see map)

- Right lane closure on northbound 108th AVE SE (WA 515), from approximately SE 201st St and SE 200th St
- East Sidewalk Closure from SE 200th St to SE 201st St

*Note: Timelines may shift due to weather or unexpected delays. Please check our project page or contact the team for real-time updates.

Project Background: King County Metro will upgrade Route 160, which currently runs between Renton, Kent and Auburn – to future RapidRide I Line. RapidRide is part of a larger, system-wide approach to improve transit access in south King County, and I Line service is planned to begin in 2027.

Find your King County Commute

Construction doesn't have to slow you down. King County Metro offers regular, reduced and free fares to ensure everyone can take transit. Find the right ORCA card and commute for you.

kingcounty.gov/metro/FareEducation

Are you a business seeking to provide your employees with great benefits? To find the right business program for you, email us at employer.services@kingcounty.gov or visit kingcounty.gov/MetroBusiness.



Project and contact information



253-550-7628



kingcounty.gov/rapidride/i



rapidride@kingcounty.gov



Translations and interpretations available.

COK - P1.02 TCP - 108th Ave SE & SE 200th St - TCP 1 of 3 (A-K02)

- RIGHT LANE CLOSURE ON NB 108TH AVE SE (WA 515) AT SE 201ST ST
 - EAST SIDEWALK CLOSURE FROM SE 200TH ST TO SE 201ST ST

WORK DESCRIPTION: Installation of RapidRide I Line Bus Station
WORK HOURS: 9:00 AM to 3:00 PM Monday thru Friday.

TRAFFIC CONTROL PLAN
 KENT, WA

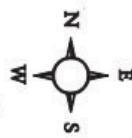

- LEGEND**
- ➔ SIGN (ARROW FACED DIRECTION)
 - TRAFFIC CONTROL DELINATOR
 - ▨ ARROWBOARD (CHEVRON)
 - ▨ WORK ZONE
 - ▨ SIDEWALK CLOSED
 - ▨ SIDEWALK OPEN

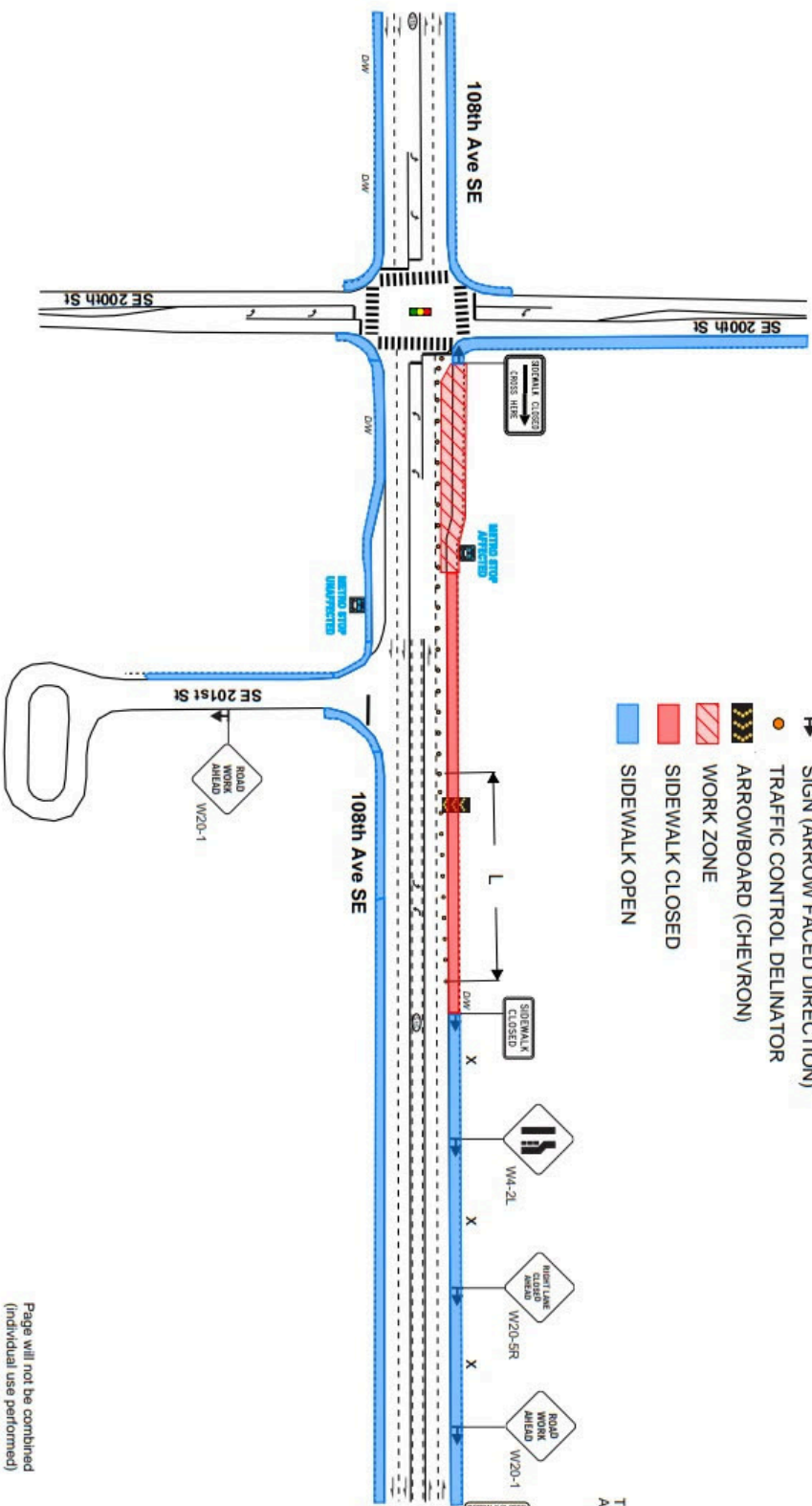

Page will not be combined
 (individual use performed)

PAGE 1



CONTRACTOR	STACY WITBECK	JOB NAME	RAPIDRIDE I LINE
SUPERVISOR		PROJECT LOCATION	Kent, WA
PHONE NUMBER (office)		PHONE NUMBER (fax)	
PHONE NUMBER (fax)		SHEET NUMBER	11/03/2025