

School Plan Review Guide

Please complete the information below:

CONSTRUCTION PERMIT (check one) Make checks payable to: PHSKC

- New School Construction**, \$402.00 base fee for the first two hours of service payable at the time of application, plus \$201.00 per hour for service after two hours, payable at the time of final approval.
- School Renovation**, \$402.00 base fee for the first two hours of service payable at the time of application, plus \$201.00 per hour for service after two hours, payable at the time of final approval.
- Plan re-submittal**, \$201.00 per hour, payable at the time of final approval.

BRIEF DESCRIPTION OF PROPOSAL

PROJECT INFORMATION

School Facility Name _____

School Facility Site Address _____ City _____ State _____ Zip _____

Ownership
 Owner/School District _____

Address _____ City _____ State _____ Zip _____

Contact Person _____ Phone _____ Email _____

Architect/Engineer
 Business Name _____ Phone (____) _____

Address _____ City _____ State _____ Zip _____

Contact Person _____ Phone _____ Email _____

OFFICE USE ONLY

Permit Record ID (PR#) _____ SR# _____

Classification _____ Building Dept Tracking # _____

Date Submitted _____ Reviewer _____ Review Time _____

Approval Date _____

Action Taken: Approved Disapproved Corrections sent Pending Other

CONTACT LOG

Date	Discussion
_____	_____
_____	_____
_____	_____

If you have questions, please ask to speak to an available plan reviewer below.

DOWNTOWN CHINOOK

Environmental Health Division
401-5th Ave, 11th Floor
Seattle, WA 98104
Phone: (206) 263-9566

OR

BELLEVUE EASTGATE

Environmental Health Division
14350 S.E Eastgate Way
Bellevue, WA 98007
Phone: (206) 477-8050

BE SURE PLANS ARE OF PROFESSIONAL QUALITY (TO SCALE AND IN DETAIL).

INCLUDE THE PLAN REVIEW BASE FEE
The Plan Review Fee Is Not Refundable

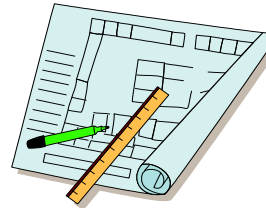

PROVIDE A MINIMUM OF TWO SETS OF PLANS

THIS IS A GUIDELINE TO THE REQUIREMENTS FOR PLAN REVIEW OF SCHOOLS, KINDERGARTEN TO TWELFTH GRADE.

THE WASHINGTON STATE BOARD OF HEALTH, PRIMARY AND SECONDARY SCHOOL REGULATION, WASHINGTON ADMINISTRATIVE CODE 246-366, [HTTP://APPS.LEG.WA.GOV/WAC/DEFAULT.ASPX?CITE=246-366](http://apps.leg.wa.gov/wac/default.aspx?cite=246-366) REGULATES SCHOOL DESIGN AND CONSTRUCTION.

THE "HEALTH AND SAFETY GUIDE FOR K-12 SCHOOLS IN WASHINGTON", [HTTP://WWW.K12.WA.US/SCHFACILITIES/PUBLICATIONS/PUBDOCS/COMPLETESAFETY&HEALTH MANUAL2002-2003.PDF](http://www.k12.wa.us/schfacilities/publications/pubdocs/completesafety&healthmanual2002-2003.pdf) JOINTLY PUBLISHED BY THE STATE DEPARTMENT OF HEALTH AND OFFICE OF SUPERINTENDENT OF PUBLIC INSTRUCTION, PROVIDES GUIDANCE FOR SCHOOL DESIGN, CONSTRUCTION AND OPERATION.

PLEASE CONTACT THE PLAN REVIEWER, LISTED ABOVE, IF YOU HAVE QUESTIONS.

DISTRICT HEALTH CENTERS

DOWNTOWN
401 5th Ave, 11th Floor
Seattle, WA 98104
206-263-9566

EASTGATE
14350 S.E. Eastgate Way
Bellevue, WA 98007
(206) 477-8050

DOCUMENTS REQUIRED WITH PLAN SUBMITTAL

I. THE ARCHITECT, ENGINEER, OR SCHOOL REPRESENTATIVE MAY SUBMIT A DOCUMENT VERIFYING THE SITE ASSESSMENT WAS COMPLETED STATING “NO HEALTH HAZARDS EXIST” FOR ITEMS 1-5 BELOW. PUBLIC HEALTH – SEATTLE & KING COUNTY MAY CONDUCT A SITE REVIEW WHEN INCOMPLETE DATA IS RECEIVED OR SITE REVIEW DOCUMENTS HAVE NOT BEEN COMPLETED. ALL ITEMS BELOW MUST BE INCLUDED.

1. Toxic contamination, air, soil, surrounding businesses
 - Submit document stating a site assessment showed no health hazards for the above issues, or
 - Plan reviewer will conduct site review.
2. Site noise from traffic, air conditioner or other noise sources WAC 246-366-110 (2)
 - Submit document stating a site assessment showed no health hazards for the above issues, or
 - Plan reviewer will conduct site review.
3. Natural or topographical hazards (cliffs, water, woods, etc.)
 - Submit document stating a site assessment showed no health hazards for the above issues, or
 - Plan reviewer will conduct site review.
4. Water Supply WAC 246-366-060 [2]
 - Wells must be approved; specify approving agency, permit numbers and date of approval.
5. On Site Sewage Disposal WAC 246-366-070
 - Public Health-Seattle & King County must approve on site disposal systems, specify permit numbers and date of approval.

II. BUILDING REQUIREMENTS THAT WILL BE APPROVED AT PREOCCUPANCY INSPECTION

1. School grounds/play area fencing shall be designed to keep children in, animals and strangers out, and as protection from vehicular traffic.
 - Reviewed and approved at preoccupancy inspection
2. Sufficient lighting intensities, sun and glare control, WAC 246-360-050(9) and WAC 246-360-120
 - Reviewed and approved at preoccupancy inspection
3. Stage safety-warning strips
 - Reviewed and approved at preoccupancy inspection
4. Ventilation and other mechanical noise sources shall be installed to conform to noise limits, WAC 246-366-110 [1]
 - Noise limits reviewed and approved at preoccupancy inspection

III. BUILDING DESIGN REQUIREMENTS BELOW MUST BE INCLUDED ON PLANS AND /OR SPECIFICATIONS. PLANS AND SPECIFICATIONS ORGANIZED INTO ONE SECTION OR PAGES BY THE OWNER OR ARCHITECT WILL EXPEDITE PLAN REVIEW BY PUBLIC HEALTH SEATTLE & KING COUNTY, KEEPING THE COST OF SERVICE TO A MINIMUM.

PAGE NUMBER IN PLANS OR SPECIFICATIONS SHOULD BE NOTED BELOW.

Applicability	Code Section	Component	Information Required	Location on Plans	Public Health Notes
	WAC 246-366-050 (2)	Ceiling Projections	Indicate no projections from ceiling are less than seven feet from finished floor		
	WAC 246-366-050 (2)	Ceiling Height	Indicate clear vertical distance of eight feet from finished floor to finished ceiling in instructional areas		
	WAC 246-366-050 (4)	Floor Surface	Indicate type of cleanable floor surface		
	WAC 246-366-050 (7)	Storage Areas	Indicate storage areas for outdoor clothing, plan and instructional equipment are sufficient, easily accessible, well-lighted, heated and ventilated.		

Applicability	Code Section	Component	Information Required	Location on Plans	Public Health Notes
	WAC 246-366-050 (3)	Classroom windows	Indicate sufficient windows to permit students to see outside in rooms occupied by students for more than 50% of the day.		
	WAC 246-366-060 (4)(a)	Showers	Indicate showers provided for grades 9 and above.		
	WAC 246-366-060 (4) (b,c)	Shower floor and wall	Indicate impervious, non-skid floor finish.		
	WAC 246-366-060 (4) (b,c)	Shower wall	Indicate impervious wall finish up to the shower head height.		
	WAC 246-366-060 [4] [b,c]	Locker room	Indicate washable wall surface.		
	WAC 246-366-060 [4] [b,c]	Locker room	Indicate floor drains.		
	Health and Safety Guide K-12	Roof vent and air intake	Indicate location and that air intake is down wind of exhaust with separation preventing exhaust from reentering the building.		
	WAC 246-366-100	Room temperature controls	Indicate automatic room controls.		
	Health and Safety Guide K-12	Gym backboard	Indicate padded walls behind backboards and that wall projections behind backboards are padded.		
	Health and Safety Guide K-12	Health/nurse room visibility	Indicate patients in the school health or nurse's room are visible to office staff (or another person) at all times.		
	Health and Safety Guide K-12	Play equipment	Indicate structures, location, surfacing, fall hazards, and visibility meet specification in the most current versions of U.S. Consumer Product Safety Commission "Handbook for Public Playground Safety" and ASTM 1487 "Standard Consumer Safety Performance Specifications for Playground Equipment for Public use."		
	WAC 246-366-140 [2]	Science Lab	Indicate location of emergency eyewash, shower stations, and hand washing. NOTE: recommend following Labor and Industry requirements www.lni.wa.gov .		
	Health and Safety Guide K-12	Storage for cleaning chemicals	Indicate location of emergency eyewash, shower stations, and hand washing. NOTE: recommend following Labor and Industry requirements www.lni.wa.gov		
	Health and Safety Guide K-12	Storage for Science Lab chemicals	Indicate location of emergency eyewash, shower stations, and hand washing. NOTE: recommend following Labor and Industry requirements www.lni.wa.gov		
	WAC 246-366-140 [2]	Vocational (auto, wood shop, art/ photography rooms, etc.)	Indicate location of emergency eyewash, shower stations, and hand washing. NOTE: recommend following Labor and Industry requirements www.lni.wa.gov		