

NOTE:
 IMPERVIOUS SURFACE BEFORE = 21,126 SF
 IMPERVIOUS SURFACE AFTER = 23,803 SF
 TOTAL LOT AREA = 152,881 SF
 PERCENT IMPERVIOUS SURFACE AFTER = 15.6%

ADJACENT ZONING:
 RESIDENTIAL
 ADJACENT APN:
 390500TRCT

ADJACENT ZONING:
 RA-5
 ADJACENT APN:
 1224069080

APN: 1224069012
 ZONING:
 RA-5-P

ADJACENT ZONING:
 RA-5
 ADJACENT APN:
 1224069058

ADJACENT ZONING:
 RA-5
 ADJACENT APN:
 1324069038

CDUP20-0002
RECEIVED
 JAN 31 2020
KC DLS / PERMITS



SB1693
SAMMAMISH
BEAVER LAKE
 FA: 10127732
 26325 SE 39TH STREET
 ISSAQUAH, WA 98029

PROJECT:
ZONING DRAWING

ISSUED FOR:
REVIEW

SUBMITTALS			
REV.	DATE	DESCRIPTION	BY
D	11/20/18	SUBMITTAL ZDS	JD
E	1/11/19	SUBMITTAL ZDS	JD
F	1/17/19	SUBMITTAL ZDS	JD
G	4/25/19	FINAL SURVEY	JD
H	5/21/19	CLIENT COMMENTS	JD
I	5/21/19	CLIENT COMMENTS	DS
J	8/12/19	CLIENT COMMENTS	MK
K	8/24/19	A-1 REVISION	MK
L	8/28/19	CLIENT COMMENTS	CW
M	7/25/19	CLIENT COMMENTS	CW
N	10/4/19	CLIENT COMMENTS	MW

FA#: 10127732
 DRAWN BY: JD
 CHECKED BY: DA

CURRENT ISSUE DATE:
10/4/19

STAMP:
 PRELIMINARY
 NOT FOR CONSTRUCTION

THE INFORMATION CONTAINED IN THIS SET OF CONSTRUCTION DOCUMENTS IS PROPRIETARY BY NATURE. ANY USE OR DISCLOSURE OTHER THAN THAT WHICH RELATES TO AT&T MOBILITY IS STRICTLY PROHIBITED.

SHEET TITLE:
OVERALL SITE PLAN

SHEET NUMBER: **A-1** REV. **M**

1
 A-2
 ENLARGED SITE PLAN

	SETBACKS			
	NORTH	SOUTH	EAST	WEST
NEW MONOPOLE	270'-7"	62'-5"	329'-5"	180'-10"
NEW WIC	262'-9"	61'-10"	336'-7"	165'-10"
NEW FENCE	255'-7"	47'-5"	314'-5"	165'-10"

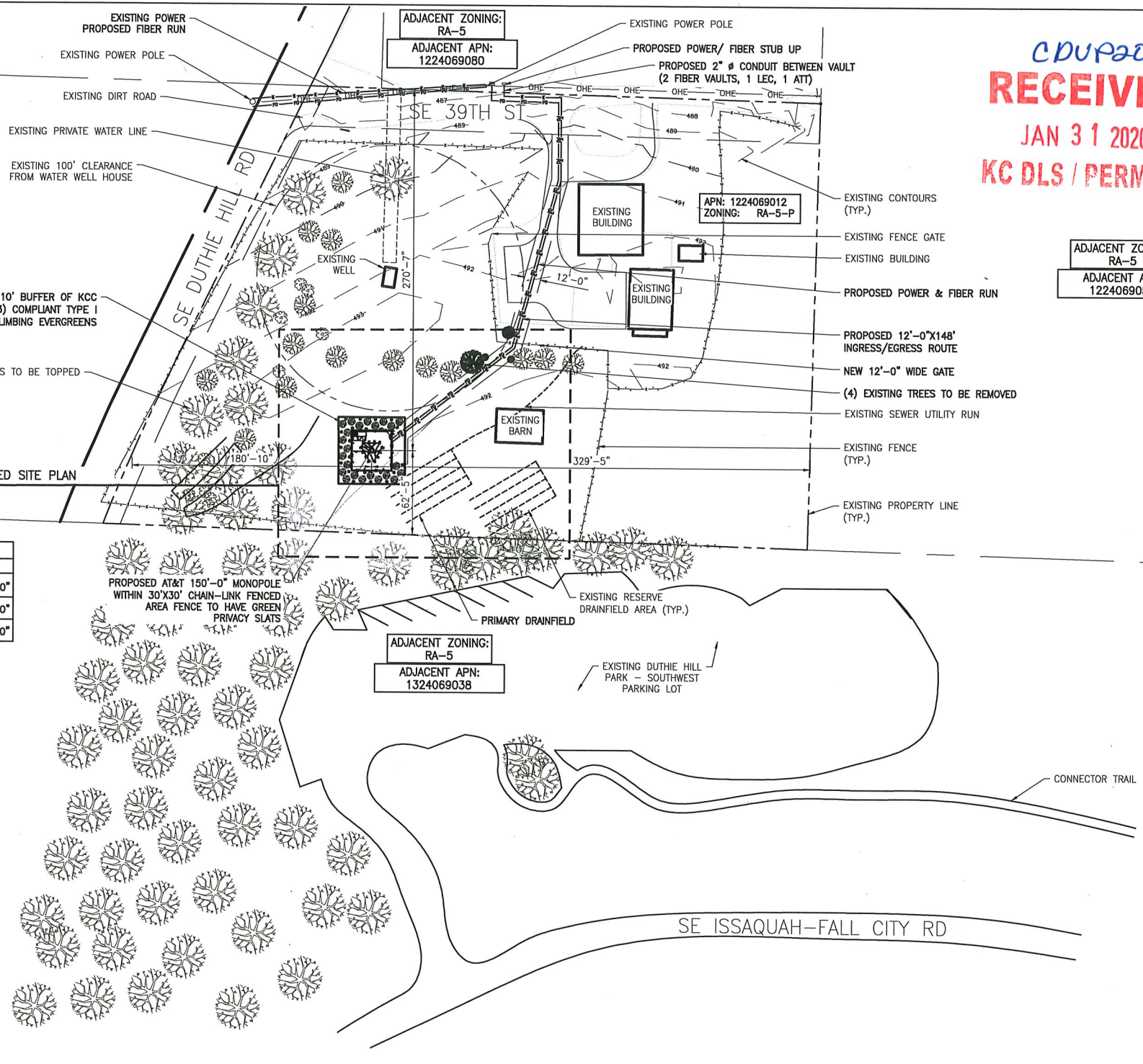

22"x34" SCALE: 1"=40'
 11"x17" SCALE: 1"=80'

OVERALL SITE PLAN 1