

SECTION 27, TOWNSHIP 23 NORTH, RANGE 8 EAST, W.M.
AT&T SB4889 - RATTLESNAKE LAKE

Approximate location of proposed access drive and new minor communication tower

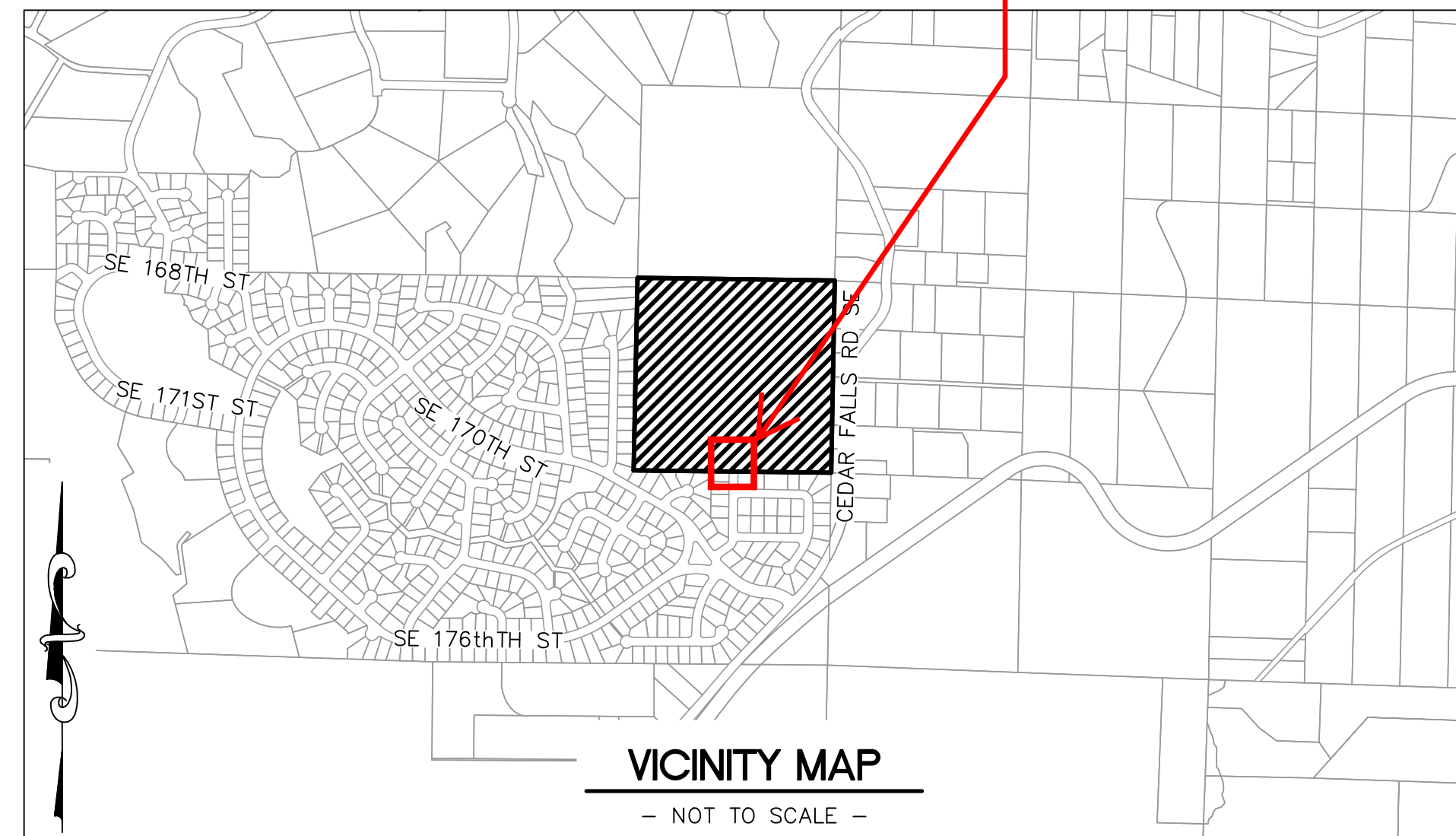
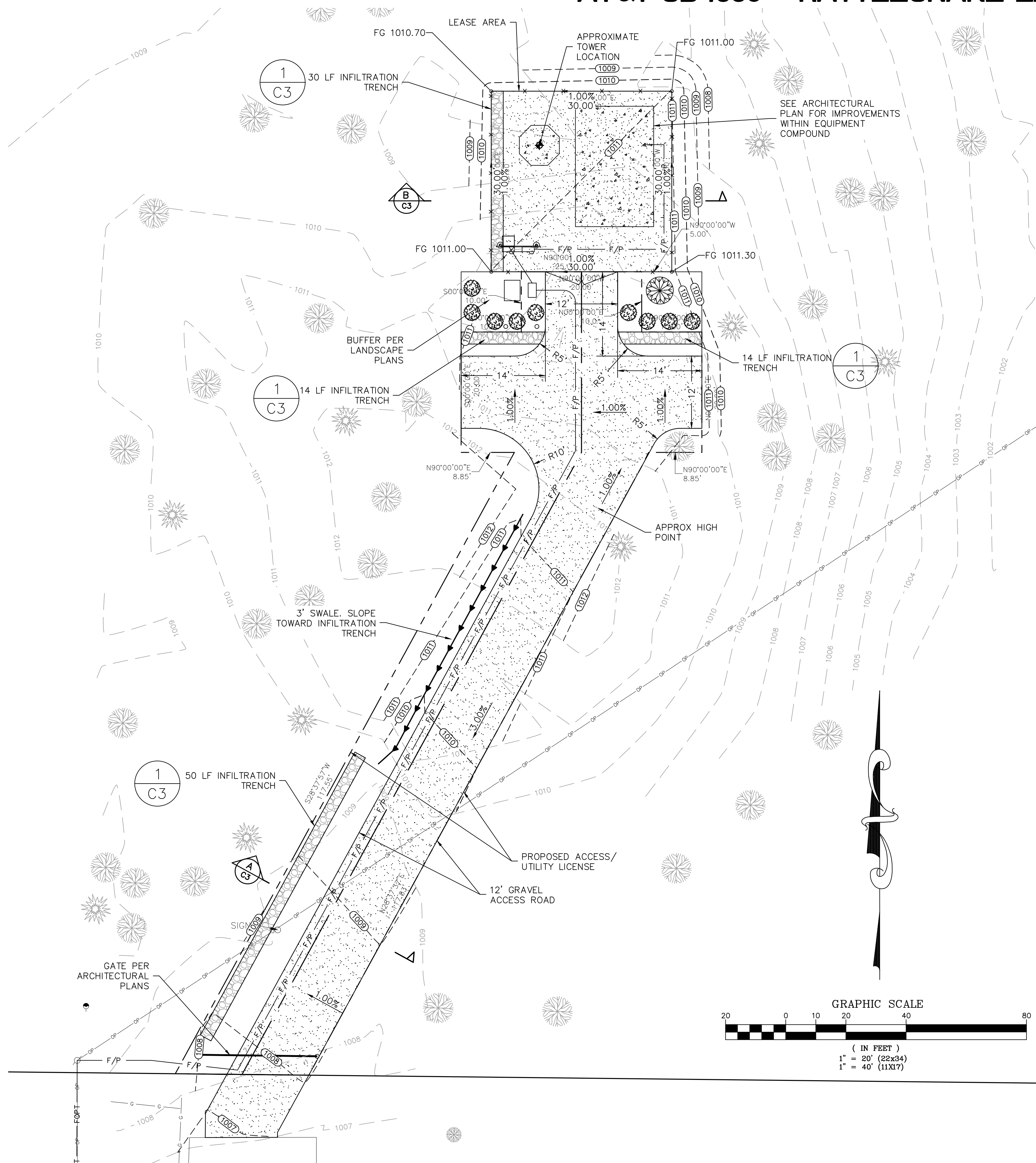

CONTACT INFORMATION

APPLICANT NEW CINGULAR WIRELESS PCS, LLC
 19801 SW 72ND AVE #100
 TUALATIN, OR 97062

GROUND OWNER KING COUNTY
 16925 CEDAR FALLS RD SE
 NORTH BEND, WA 98045
 CONTACT: TODD WALTON
 TWALTON@KINGCOUNTY.GOV
 206-263-2670

SITE ACQUISITION AGENT SMARTLINK
 11232 120TH AVE NE, #204
 KIRKLAND, WA 98033
 CONTACT: NANCY SEARS
 425-444-1434

CIVIL ENGINEER DUNCANSON COMPANY, INC.
 145 SOUTHWEST 155TH STREET, #102
 SEATTLE, WA 98166
 CONTACT: HAROLD DUNCANSON
 HAROLDD@DUNCANSONCO.COM
 206-244-4141

SURVEYOR AMBIT CONSULTING, LLC.
 245 SAINT HELENS AVE, SUITE 3A
 TACOMA, WA 98402

SITE INFORMATION

SITE ADDRESS 16925 CEDAR FALLS ROAD
 NORTH BEND, WA 98045

COUNTY KING

TAX LOT NUMBER 272308-9004

ZONING RA-5 - RURAL AREA

TOTAL LOT AREA 80.66 AC

DISTURBED AREA ±7,360 SF

NEW/REPLACED IMPERVIOUS AREA ±3,170 SF

CUT 50 CY

FILL 112 CY

REFERENCE INFORMATION

SITE PLAN PROVIDED BY CAPITAL DESIGN SERVICES,
 REVISION 4, DATED 05/17/2022.
 SURVEY PER CAD FILE PROVIDED BY AMBIT CONSULTING,
 DATED 05/17/2022

SHEET INDEX

- C1 GRADING AND DRAINAGE PLAN
- C2 EROSION PREVENTION AND SEDIMENT CONTROL PLAN
- C3 DETAILS
- C4 GENERAL NOTES

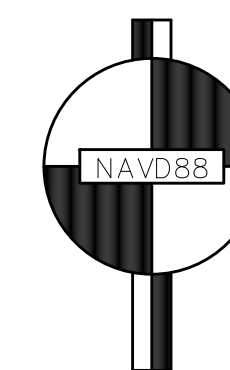
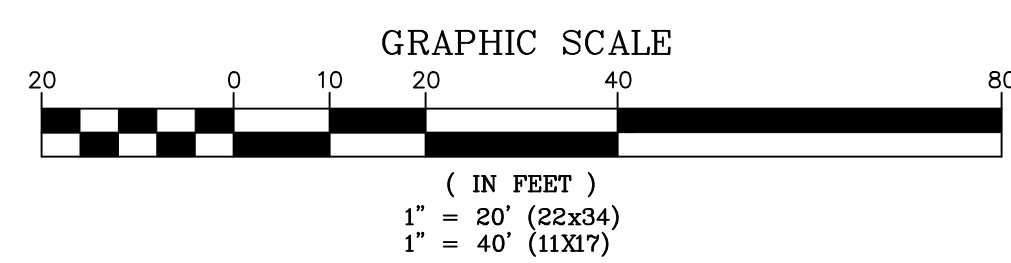

CONTACT SURVEYOR FOR SITE TBM.



Know what's below.
 Call 48 hours before you dig.



DRAWN BY: DLS DATE: 6/9/2022
 DCI PROJ #: 01792.2032

DRAWING VERSION		
VER.	DATE	DESCRIPTION

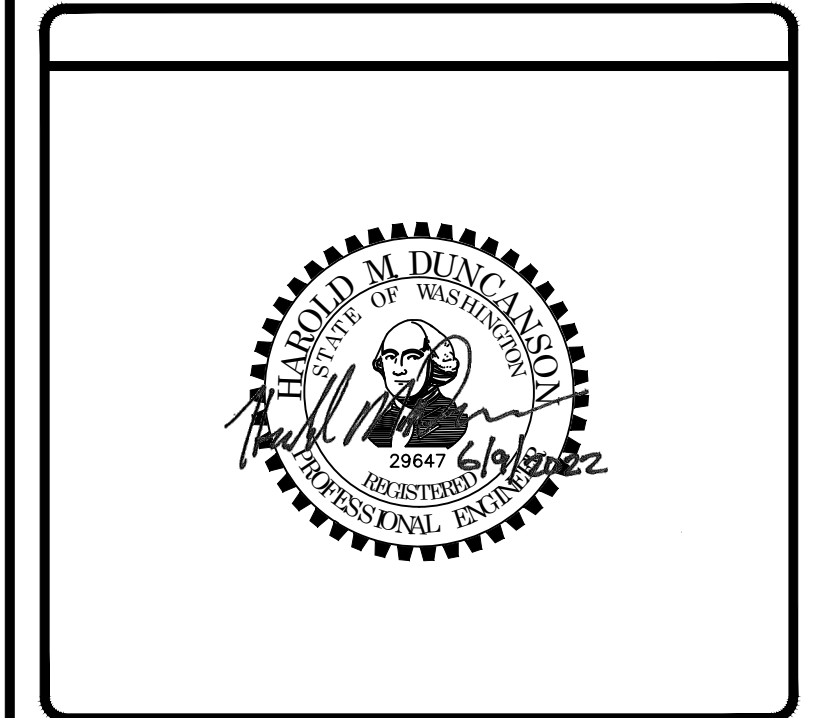

PROJECT INFORMATION

**SB4889
 RATTLESNAKE LAKE**

TAX LOT#: 272308-9004
 NORTH BEND, WA 98045

SHEET TITLE

**GRADING AND
 DRAINAGE PLAN**

SHEET NO.

C1